

RESOLUTION

TO HOLD A PUBLIC HEARING TO CONSIDER ENLARGING THE GREATER GREENVILLE SANITATION DISTRICT TO INCLUDE CERTAIN PROPERTIES LOCATED OFF OF COXE DRIVE, MOUNTAIN CREEK ROAD, PIEDMONT GROVE PARK AND P & N DRIVE, EAST WAREHOUSE COURT, MACKEY DRIVE AND OLD CLEVELAND ROAD, AND FRONTAGE ROAD AND PARK WEST BOULEVARD .

WHEREAS, the Greater Greenville Sanitation District (“District) was created by Act No. 1543 of the 1968 Acts and Joint Resolutions of the General Assembly of the State of South Carolina, and as such is a special purpose district created prior to March 7, 1973 to which has been committed the function of collecting refuse, garbage and trash within and outside the district, and to engage in the operations of dumps or landfills for the orderly disposal of refuse, garbage and trash within Greenville County; and

WHEREAS, a petition has been submitted to Greenville County Council by the majority of owners of the following real property located in Greenville County to have said property annexed into and made a part of the Greater Greenville Sanitation District:

- A. That certain real property located off of Coxe Drive described as Greenville County Tax Map Number (“TMS#”) P035000100902;
- B. That certain real property located off of Mountain Creek Road described as Greenville County Tax Map Numbers (TMS#) P036000100400, P036000100401, P036000100402, P036000100403, P036000100500, P036000100501, P036000100502, P036000100503, P036000100504, P036000100600, P036000100601, P036000100602, P036000100603, P036000100604, P036000100605, P036000100606, P036000100607, P036000100609, P036000100611, P036000100612, P036000100700, P036000100701, P036000100702, P036000100703, P036000101502, P036000101504, P036000101505, P036000101507, P036000101508, P036000101600, and P036000101700;
- C. That certain real property located off of Piedmont Grove Park and P & N Drive described as Greenville County Tax Map Numbers (TMS#) WG10010200102, WG10010200104, WG10010200105, WG10010200106, WG10010200108, WG10010200109, WG10010200110, WG10010200111, WG10010300300, WG11000200100, WG11000200101, WG11000300100, and WG11000300500;
- D. That certain real property located off of East Warehouse Court described as Greenville County Tax Map Numbers (TMS#) P015040100101, P015040100105, P015040100400, P015040100401, P015040100402,

P015040100404, and P015040100405.

- E. That certain real property located off of Mackey Drive, and Old Cleveland Road described as Greenville County Tax Map Numbers (TMS#) 0608030100100, 0608030100400, 0608030100500, 0608030101002, 0608030101400, 0608030101500, 0608040100301, 0608040100304, 0608040100305, WG06020300100, WG06020300200, WG06020300300, WG06020300400, WG06020300401, WG06020300402, WG06020300403, WG06020300404, WG06020300500, WG06020300601, WG06020300700, WG06020300800, WG07000100100, WG07000100600, WG07000200200, WG07000200201, WG07000200202, WG07000200300, WG07000200302, WG07000200504, WG07000200700, WG07000200701, WG07000200702, WG07000201500, WG07000201501, WG10020100200, WG10030100100, WG10030100103, WG10030101700, and WG10040100100; and
- F. That certain real property located off of Frontage Road and Park West Boulevard described as Greenville County Tax Map Numbers (TMS#) 0252000102900, 0252000101009, 0252000101010, 0252000101102, 0252000101201, 0252000103000, WG10070100100, WG10070100102, WG10070100103, WG11000300302, and WG11000300307.

NOW, THEREFORE, BE IT RESOLVED that a public hearing be held for the purpose of determining whether the boundary of the Greater Greenville Sanitation District shall be enlarged to include the following properties:

- A. That certain real property located off of Coxe Drive described as Greenville County Tax Map Number (“TMS#”) P035000100902;
- B. That certain real property located off of Mountain Creek Road described as Greenville County Tax Map Numbers (TMS#) P036000100400, P036000100401, P036000100402, P036000100403, P036000100500, P036000100501, P036000100502, P036000100503, P036000100504, P036000100600, P036000100601, P036000100602, P036000100603, P036000100604, P036000100605, P036000100606, P036000100607, P036000100609, P036000100611, P036000100612, P036000100700, P036000100701, P036000100702, P036000100703, P036000101502, P036000101504, P036000101505, P036000101507, P036000101508, P036000101600, and P036000101700;
- C. That certain real property located off of Piedmont Grove Park and P & N Drive described as Greenville County Tax Map Numbers (TMS#) WG10010200102, WG10010200104, WG10010200105, WG10010200106, WG10010200108, WG10010200109, WG10010200110, WG10010200111, WG10010300300,

WG11000200100, WG11000200101, WG11000300100, and
WG11000300500;

- D. That certain real property located off of East Warehouse Court described as Greenville County Tax Map Numbers (TMS#) P015040100101, P015040100105, P015040100400, P015040100401, P015040100402, P015040100404, and P015040100405.

- E. That certain real property located off of Mackey Drive, and Old Cleveland Road described as Greenville County Tax Map Numbers (TMS#) 0608030100100, 0608030100400, 0608030100500, 0608030101002, 0608030101400, 0608030101500, 0608040100301, 0608040100304, 0608040100305, WG06020300100, WG06020300200, WG06020300300, WG06020300400, WG06020300401, WG06020300402, WG06020300403, WG06020300404, WG06020300500, WG06020300601, WG06020300700, WG06020300800, WG07000100100, WG07000100600, WG07000200200, WG07000200201, WG07000200202, WG07000200300, WG07000200302, WG07000200504, WG07000200700, WG07000200701, WG07000200702, WG07000201500, WG07000201501, WG10020100200, WG10030100100, WG10030100103, WG10030101700, and WG10040100100; and

- F. That certain real property located off of Frontage Road and Park West Boulevard described as Greenville County Tax Map Numbers (TMS#) 0252000102900, 0252000101009, 0252000101010, 0252000101102, 0252000101201, 0252000103000, WG10070100100, WG10070100102, WG10070100103, WG11000300302, and WG11000300307.

DONE IN REGULAR MEETING THIS _____ DAY OF _____, 2012.

GREENVILLE COUNTY COUNCIL

Herman G. Kirven, Jr., Chairman
Greenville County Council

ATTEST:

Theresa B. Kizer
Clerk to Council

Joseph M. Kernell
County Administrator

A RESOLUTION

TO ENLARGE THE BOUNDARIES OF THE GREATER GREENVILLE SANITATION DISTRICT TO INCLUDE CERTAIN PROPERTIES LOCATED OFF OF COXE DRIVE, MOUNTAIN CREEK ROAD, PIEDMONT GROVE PARK AND P & N DRIVE, EAST WAREHOUSE COURT, MACKEY DRIVE AND OLD CLEVELAND ROAD, AND FRONTAGE ROAD AND PARK WEST BOULEVARD; AND TO PROVIDE FOR PUBLIC NOTICE THEREOF.

WHEREAS, pursuant to Section 6-11-410, et seq., of the Code of Laws of South Carolina, 1976, as amended (“S.C. Code Ann.”), the governing bodies of the several counties of the State are authorized to enlarge, diminish or consolidate any existing special purpose districts located within such counties; and the Greenville County Council is the governing body of Greenville County, South Carolina; and

WHEREAS, the Greater Greenville Sanitation District (“District”) was created pursuant to Act No. 1543 of the 1968 Acts and Joint Resolutions of the General Assembly of the State of South Carolina, and as such is a special purpose district created prior to March 7, 1973 to which has been committed the function of collecting refuse, garbage and trash within the district, and to engage in the operations of dumps or landfills for the orderly disposal of refuse, garbage and trash within Greenville County; and

WHEREAS, a petition has been submitted to Greenville County Council by the majority of owners of fee simple title of the following parcels of real property located in Greenville County to have said property annexed into and made a part of the Greater Greenville Sanitation District, a copy of maps showing the following parcels is attached hereto as *Exhibit A*:

- A. That certain real property located off of Coxe Drive described as Greenville County Tax Map Number (“TMS#”) P035000100902;
- B. That certain real property located off of Mountain Creek Road described as Greenville County Tax Map Numbers (TMS#) P036000100400, P036000100401, P036000100402, P036000100403, P036000100500, P036000100501, P036000100502, P036000100503, P036000100504, P036000100600, P036000100601, P036000100602, P036000100603, P036000100604, P036000100605, P036000100606, P036000100607, P036000100609, P036000100611, P036000100612, P036000100700, P036000100701, P036000100702, P036000100703, P036000101502, P036000101504, P036000101505, P036000101507, P036000101508, P036000101600, and P036000101700;
- C. That certain real property located off of Piedmont Grove Park and P & N Drive described as Greenville County Tax Map Numbers (TMS#) WG10010200102, WG10010200104, WG10010200105, WG10010200106, WG10010200108, WG10010200109,

WG10010200110, WG10010200111, WG10010300300,
WG11000200100, WG11000200101, WG11000300100, and
WG11000300500;

- D. That certain real property located off of East Warehouse Court described as Greenville County Tax Map Numbers (TMS#) P015040100101, P015040100105, P015040100400, P015040100401, P015040100402, P015040100404, and P015040100405.
- E. That certain real property located off of Mackey Drive, and Old Cleveland Road described as Greenville County Tax Map Numbers (TMS#) 0608030100100, 0608030100400, 0608030100500, 0608030101002, 0608030101400, 0608030101500, 0608040100301, 0608040100304, 0608040100305, WG06020300100, WG06020300200, WG06020300300, WG06020300400, WG06020300401, WG06020300402, WG06020300403, WG06020300404, WG06020300500, WG06020300601, WG06020300700, WG06020300800, WG07000100100, WG07000100600, WG07000200200, WG07000200201, WG07000200202, WG07000200300, WG07000200302, WG07000200504, WG07000200700, WG07000200701, WG07000200702, WG07000201500, WG07000201501, WG10020100200, WG10030100100, WG10030100103, WG10030101700, and WG10040100100; and
- F. That certain real property located off of Frontage Road and Park West Boulevard described as Greenville County Tax Map Numbers (TMS#) 0252000102900, 0252000101009, 0252000101010, 0252000101102, 0252000101201, 0252000103000, WG10070100100, WG10070100102, WG10070100103, WG11000300302, and WG11000300307.

WHEREAS, Greater Greenville Sanitation District has consented to the annexation; and

WHEREAS, the Greenville County Council finds that the above described properties are located wholly within the boundaries of Greenville County, South Carolina, but is not within any special purpose district or municipality which is empowered to collecting refuse, garbage and trash, that annexing such property into the Greater Greenville Sanitation District would extend the facilities for the orderly collecting refuse, garbage and trash within the boundaries of the District; and

WHEREAS, Greenville County Council finds that it is in the public interest that the boundaries of the District be enlarged so as to include the properties described above and appearing on *Exhibit A*.

NOW, THEREFORE, BE IT RESOLVED by Greenville County Council that the boundaries of the Greater Greenville Sanitation District are hereby enlarged to include the following properties:

- A. That certain real property located off of Coxe Drive described as Greenville County Tax Map Number (“TMS#”) P035000100902;
- B. That certain real property located off of Mountain Creek Road described as Greenville County Tax Map Numbers (TMS#) P036000100400, P036000100401, P036000100402, P036000100403, P036000100500, P036000100501, P036000100502, P036000100503, P036000100504, P036000100600, P036000100601, P036000100602, P036000100603, P036000100604, P036000100605, P036000100606, P036000100607, P036000100609, P036000100611, P036000100612, P036000100700, P036000100701, P036000100702, P036000100703, P036000101502, P036000101504, P036000101505, P036000101507, P036000101508, P036000101600, and P036000101700;
- C. That certain real property located off of Piedmont Grove Park and P & N Drive described as Greenville County Tax Map Numbers (TMS#) WG10010200102, WG10010200104, WG10010200105, WG10010200106, WG10010200108, WG10010200109, WG10010200110, WG10010200111, WG10010300300, WG11000200100, WG11000200101, WG11000300100, and WG11000300500;
- D. That certain real property located off of East Warehouse Court described as Greenville County Tax Map Numbers (TMS#) P015040100101, P015040100105, P015040100400, P015040100401, P015040100402, P015040100404, and P015040100405.
- E. That certain real property located off of Mackey Drive, and Old Cleveland Road described as Greenville County Tax Map Numbers (TMS#) 0608030100100, 0608030100400, 0608030100500, 0608030101002, 0608030101400, 0608030101500, 0608040100301, 0608040100304, 0608040100305, WG06020300100, WG06020300200, WG06020300300, WG06020300400, WG06020300401, WG06020300402, WG06020300403, WG06020300404, WG06020300500, WG06020300601, WG06020300700, WG06020300800, WG07000100100, WG07000100600, WG07000200200, WG07000200201, WG07000200202, WG07000200300, WG07000200302, WG07000200504, WG07000200700, WG07000200701, WG07000200702, WG07000201500, WG07000201501, WG10020100200, WG10030100100, WG10030100103, WG10030101700, and WG10040100100; and
- F. That certain real property located off of Frontage Road and Park West Boulevard described as Greenville County Tax Map Numbers (TMS#) 0252000102900, 0252000101009, 0252000101010, 0252000101102,

0252000101201, 0252000103000, WG10070100100, WG10070100102,
WG10070100103, WG11000300302, and WG11000300307.

BE IT FURTHER RESOLVED that pursuant to S.C. Code Ann. § 6-11-470 (Supp. 2001), the Clerk of the County Council shall cause to be published in a newspaper of general circulation in Greenville County, once a week for two successive weeks the following information:

- (a) the results of this action of the Greenville County Council;
- (b) the fact that this Resolution does not authorize the issuance of additional bonds by the Greater Greenville Sanitation District; and
- (c) the fact that there will be no new Commission or changes made in the personnel of the present Commission of the Greater Greenville Sanitation District.

DONE IN REGULAR MEETING THIS _____ DAY OF _____, 2012.

GREENVILLE COUNTY COUNCIL

Herman G. Kirven, Jr., Chairman
Greenville County Council

ATTEST:

Theresa B. Kizer
Clerk to Council

Joseph M. Kernell
County Administrator

Coxe Drive Proposed Annexation

Total Properties: 1/District 20, Sid Cates

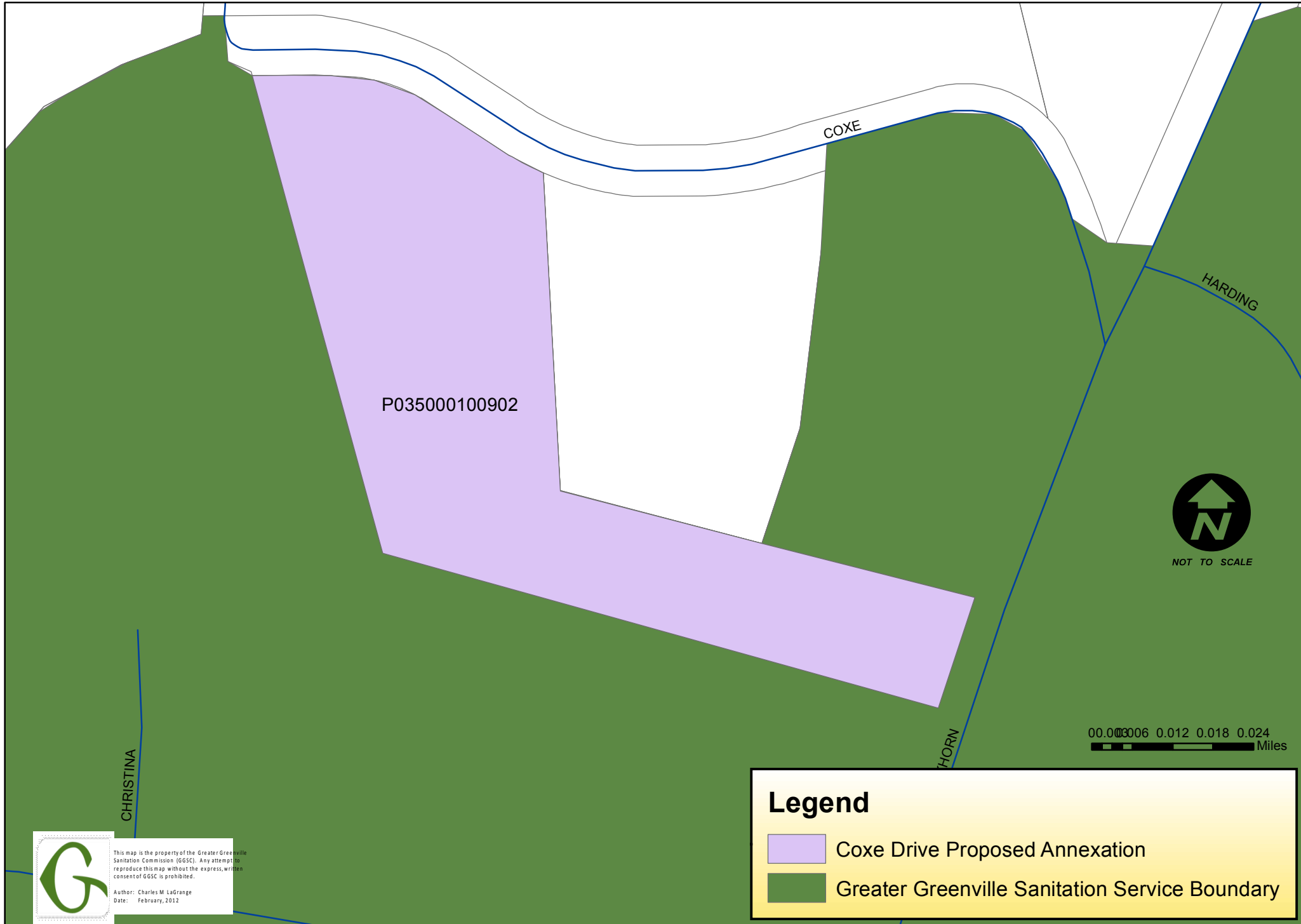

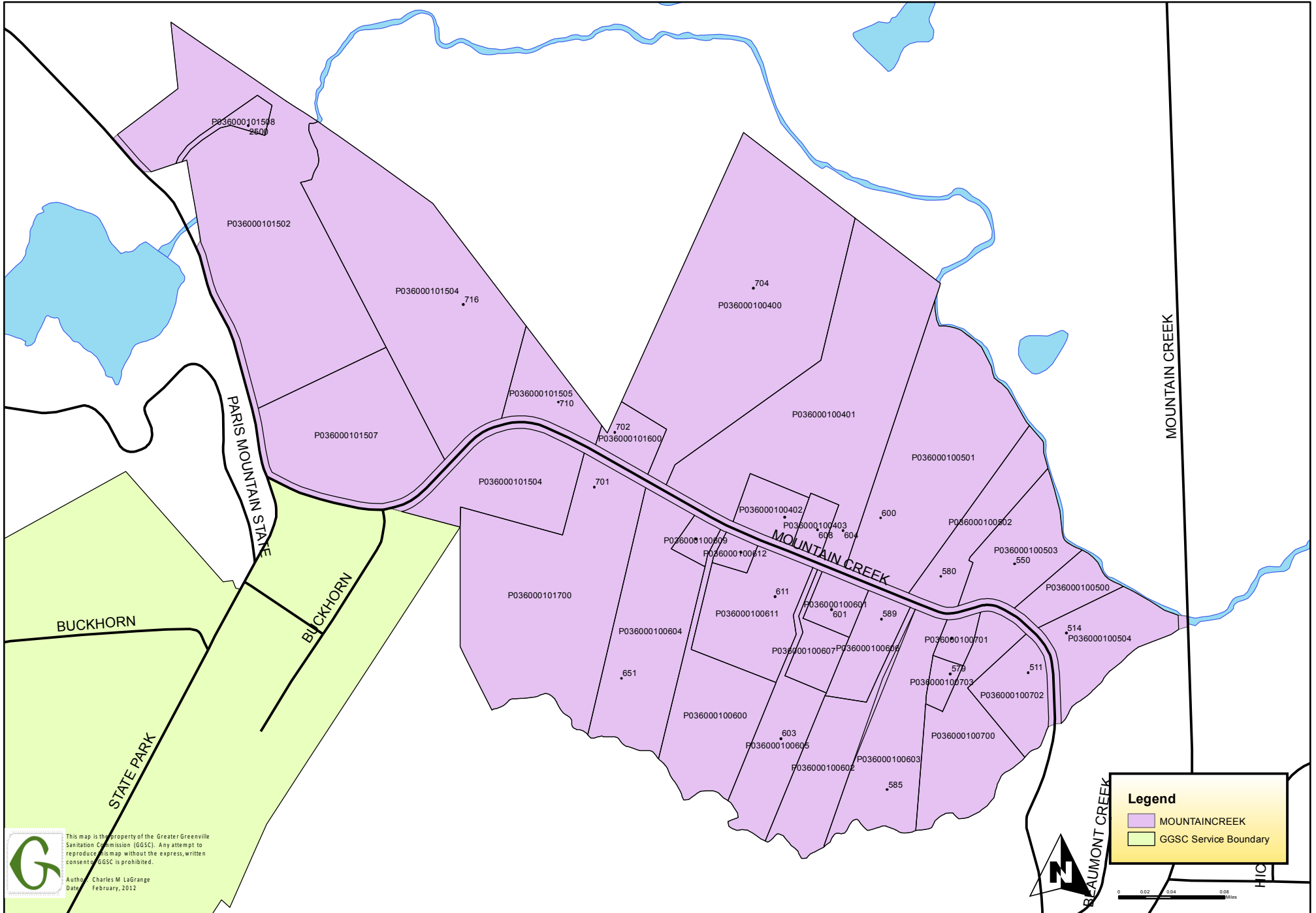

This map is the property of the Greater Greenville Sanitation Commission (GGSC). Any attempt to reproduce this map without the express, written consent of GGSC is prohibited.
Author: Charles M. LaGrange
Date: February, 2012

Legend

- MOUNTAINCREEK
- GGSC Service Boundary



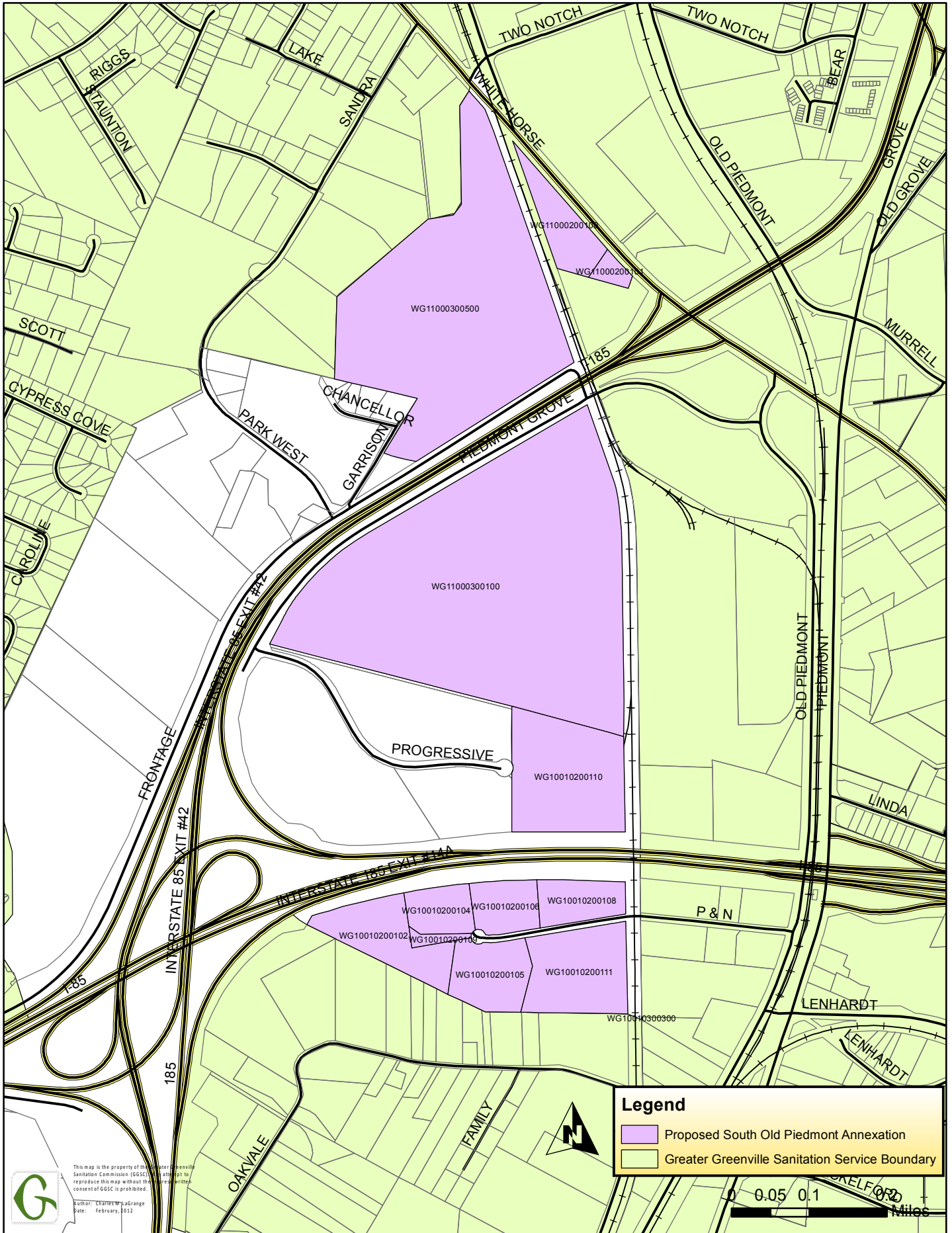

This map is the property of the Greater Greenville Sanitation Commission (GGSC). No attempt to reproduce this map without the express written consent of GGSC is prohibited.
Author: CHRISTINA ADRIANO
Date: February, 2022

Legend

- Proposed South Old Piedmont Annexation
- Greater Greenville Sanitation Service Boundary

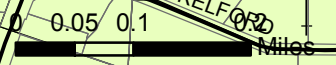

Proposed Warehouse Court Annexation

Total Properties: 7 / District 20 Sid Cates

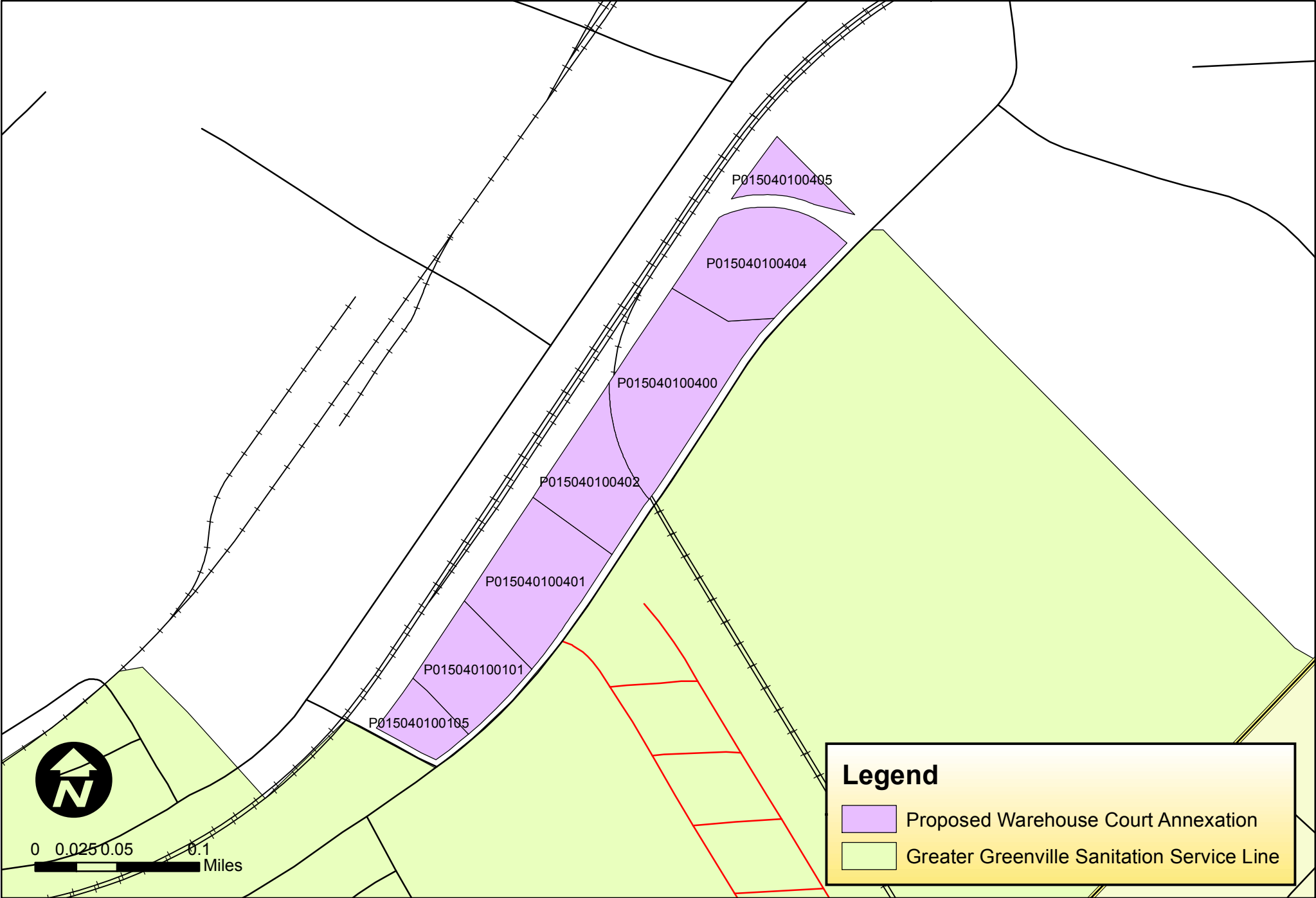

Legend

-  Proposed Warehouse Court Annexation
-  Greater Greenville Sanitation Service Line

Proposed Frontage Road Annexation

District 25 Lottie Gibson/Total Properties: 11

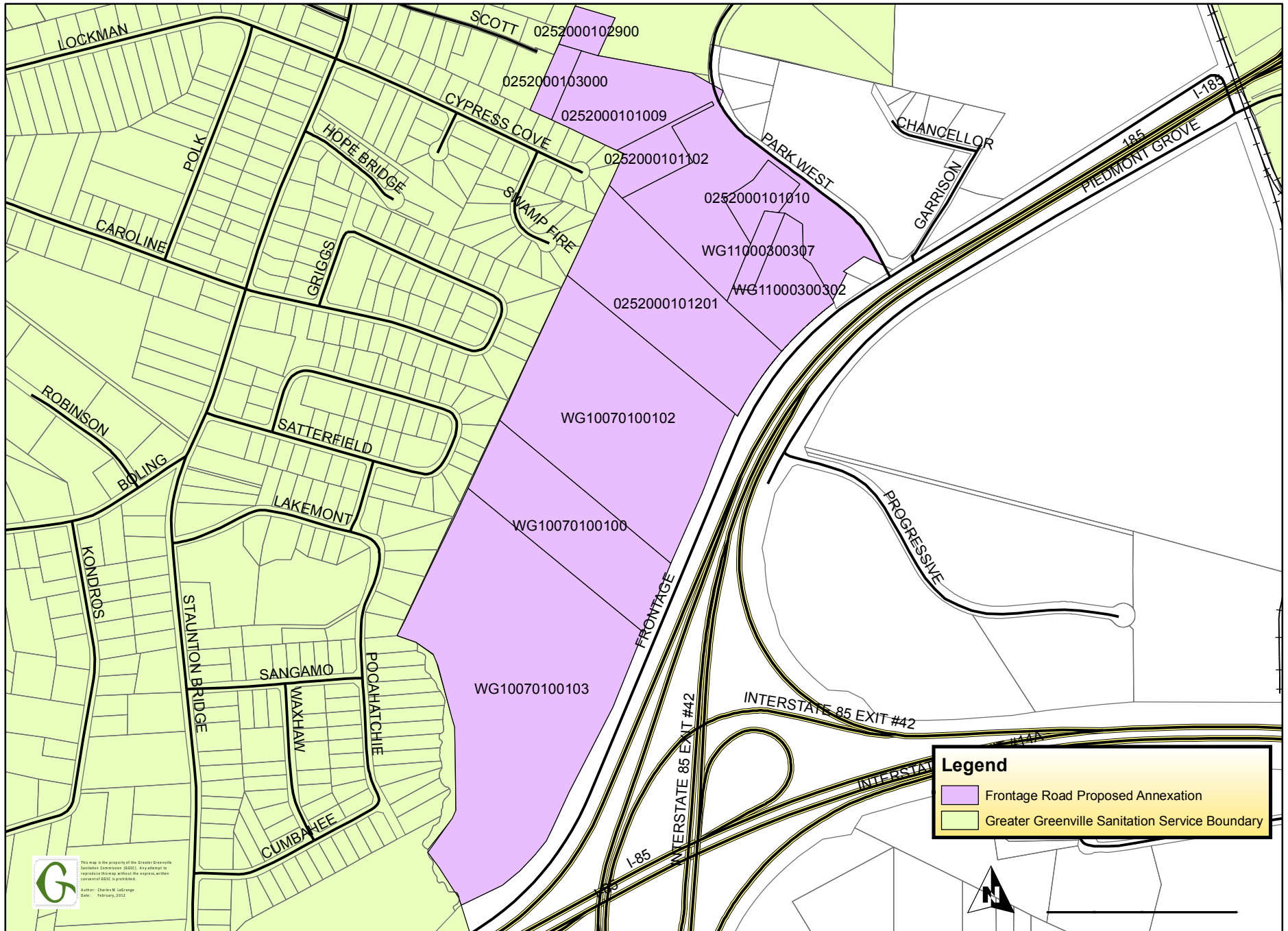

This map is the property of the Greater Greenville Sanitation Commission (GGSC). Any attempt to reproduce this map without the express written consent of GGSC is prohibited.
Author: Charles M. LaGrange
Date: February, 2022

Legend

- Frontage Road Proposed Annexation
- Greater Greenville Sanitation Service Boundary