

PROPOSED ANNEXATION

TAX MAP NO: 0252000102802
BRABHAM OIL COMPANY INC
P.O. BOX 330
BAMBERG, DC 29003-0330

COUNTY COUNCIL DISTRICT 25

Legend

 0252000102802

 GGSD_SERVICE_BOUNDARY



DATE: 3/18/2019
AUTHOR: C. LAGRANGE
CONTACT: GREATER GREENVILLE SANITATION
1600 W. WASHINGTON ST
GREENVILLE, SC 29601
864-232-6721

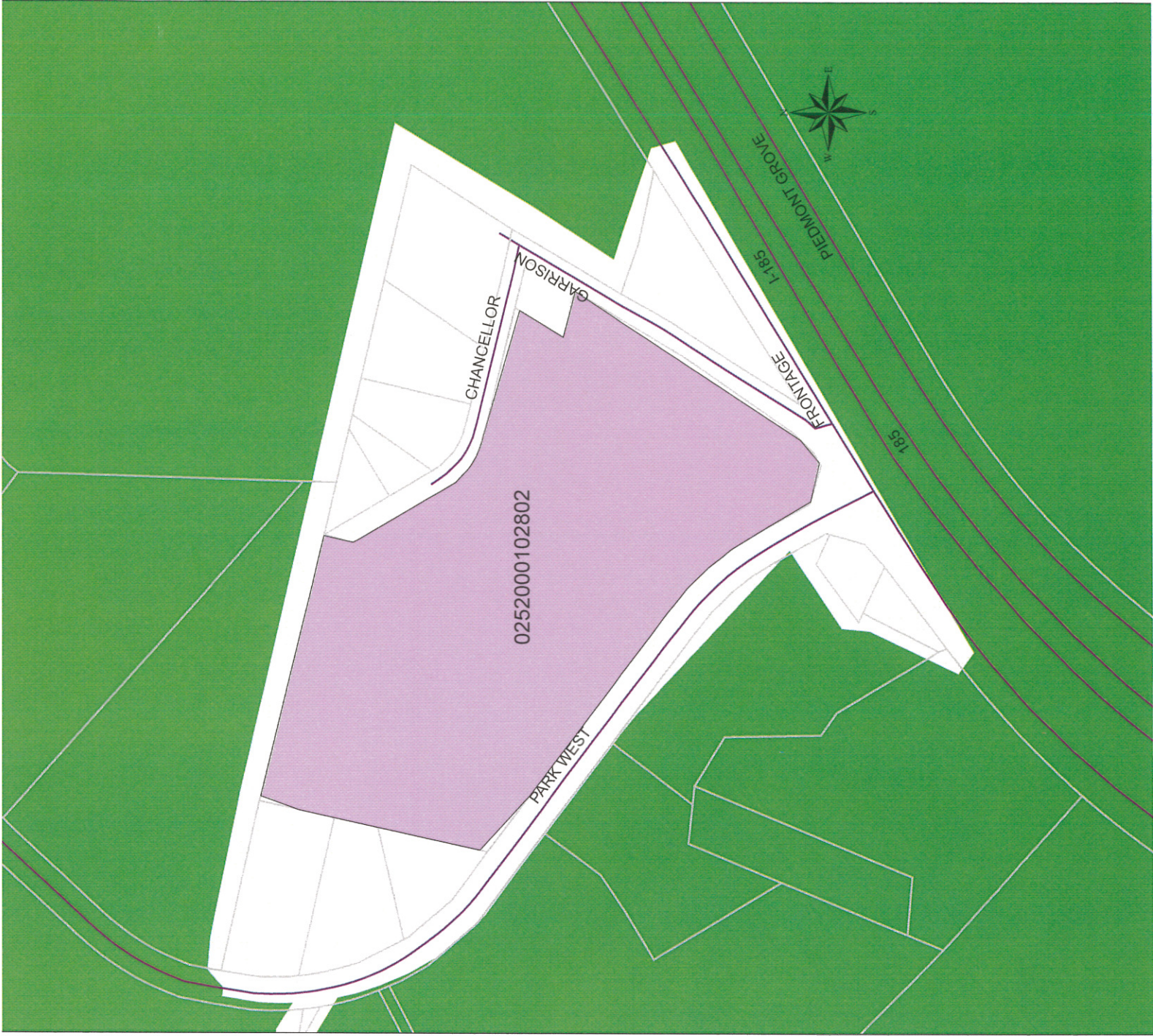



PROPOSED ANNEXATION

TAX MAP NO: P016010142300
SWANSON ROXANNE S (JTWROS)
517 HAVENHURST DR
TAYLORS SC 29687-3898

COUNTY COUNCIL DISTRICT 20

Legend

-  GGSD_SERVICE_BOUNDARY
-  517 HAVENHURST



DATE: 4/2/2019
AUTHOR: C. LAGRANGE
CONTACT: GREATER GREENVILLE SANITATION
1600 W. WASHINGTON ST
GREENVILLE, SC 29601
864-232-6721



**PROPOSED ANNEXATION
OLD HOWELL
DISTRICT 22 / BOB TAYLOR**

- Legend**
- Sanitation District
 - Proposed Annexation Old Howell



DATE: 1/31/2019
AUTHOR: C. LAGRANGE
CONTACT: GREATER GREENVILLE SANITATION
1600 W. WASHINGTON ST
GREENVILLE, SC 29601
864-232-6721

