

DUKE POWER COMPANY
REF. DWG NO 53-179

BLOCK A

35

34

33

32

31

30

29

28

JENNINGS DRIVE

DUKE POWER COMPANY
REF. DWG. NO. 156-124 & 53-179

BLOCK F

TO MOONVILLE RETAIL

ORIGINAL

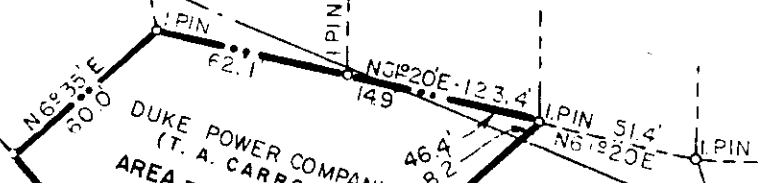

DUKE POWER COMPANY
(T. A. CARROLL)
AREA = 0.22 AC. TR.

DUKE POWER COMPANY
REF. DWG NO. 156-124 & 53-179

RELOCATION

DUKE P
REF. DWG.

COUNTY ROAD

TO CO. RD. NO. 331

DUKE P
(K. H. P
LAURA
ARE

DUKE POWER COMPANY
(LULA MELTON &
RUTH M. HERNDON)
AREA = 0.41 AC. TR.

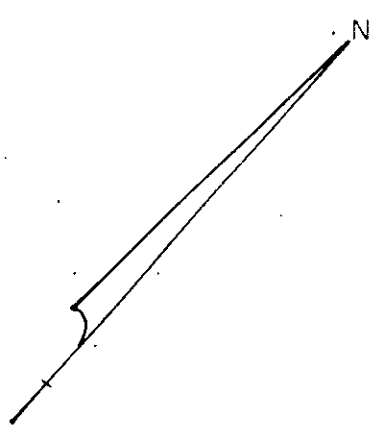

(Continued on Next Page)