

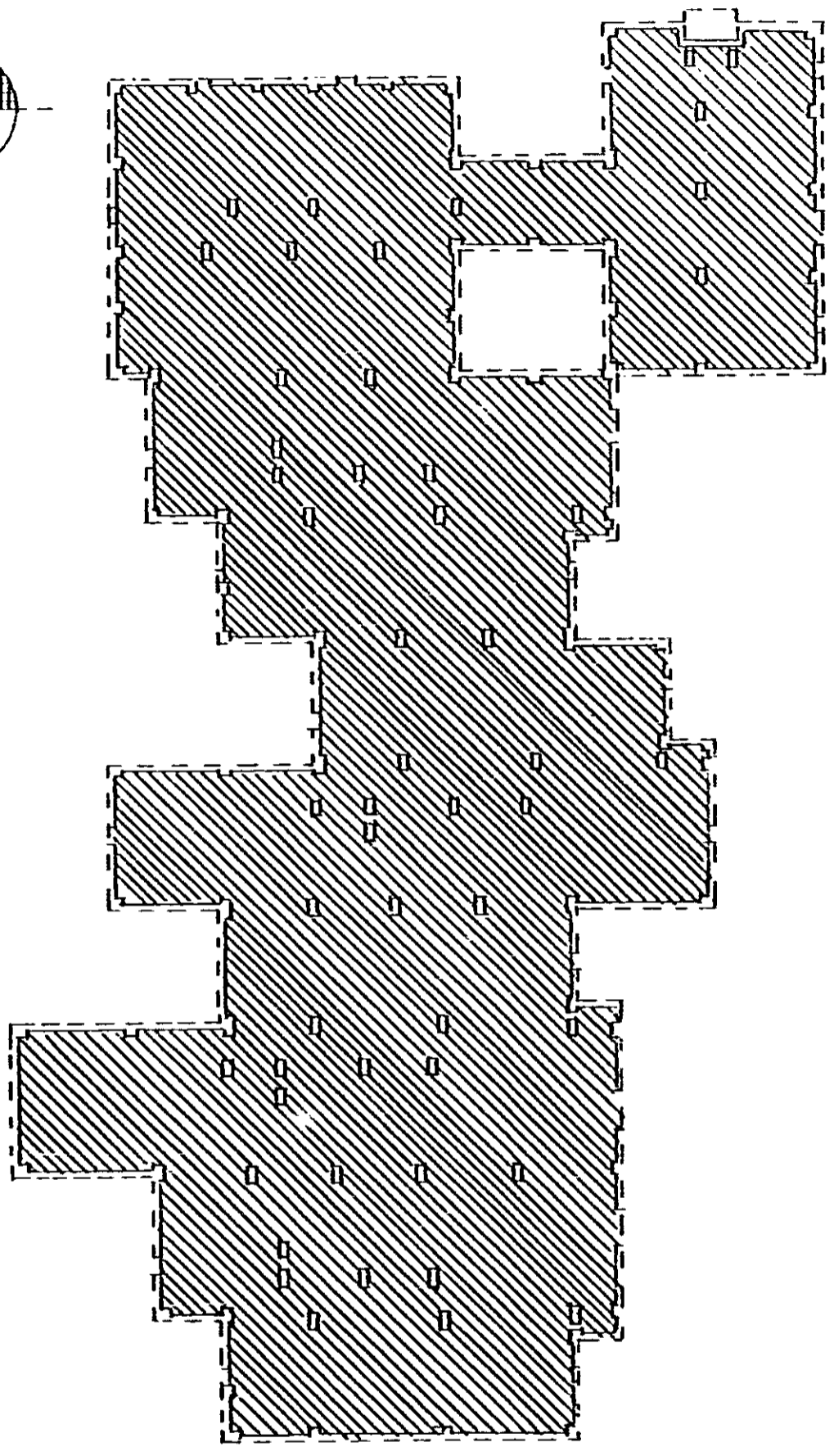

BOOK 1129 PAGE 636

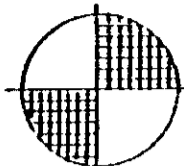

  
**NO. 252-256 FOUND. PLAN**  
 LIMITED COMMON ELEMENTS  
 GENERAL COMMON ELEMENTS

I, Charles F. Gentry, Jr., hereby certify  
 that the within floor plan are true and  
 correct copies of the original of same.  
*Charles F. Gentry, Jr.*  
 Charles F. Gentry, Jr., A.I.A.  
 South Carolina Registration No. 94



INGLESIDE HORIZONTAL PROPERTY REGIME

CHARLES F. GENTRY A.I.A. ARCHITECT

GREENVILLE

SOUTH CAROLINA

1

7-18-80

4328 RV-2

0 5 9