

GENERAL COMMON ELEMENTS --- LIMITED COMMON ELEMENTS

BUILDING A, B & C FLOOR PLAN

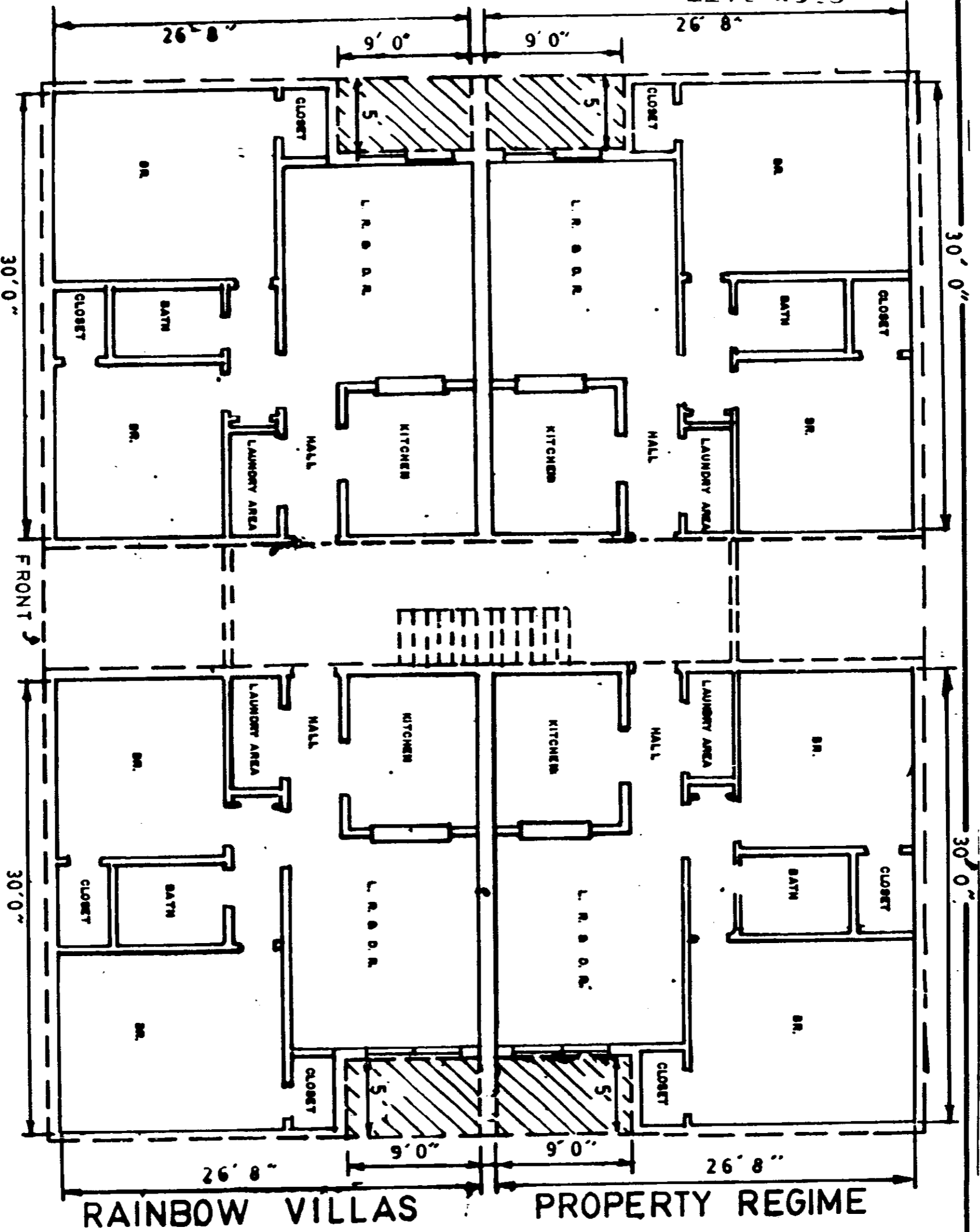

I, JAMES S. MCKINNEY, HEREBY CERTIFY THAT THE WITHIN FLOOR PLANS ARE TRUE AND CORRECT TO THE BEST OF MY KNOWLEDGE.

James S. McKinney
 JAMES S. MCKINNEY
 S. C. REG. NO. 3065

