

1000 VOL 4169 PAGE 521

FOUNDATION PLAN
CHESTERFIELD

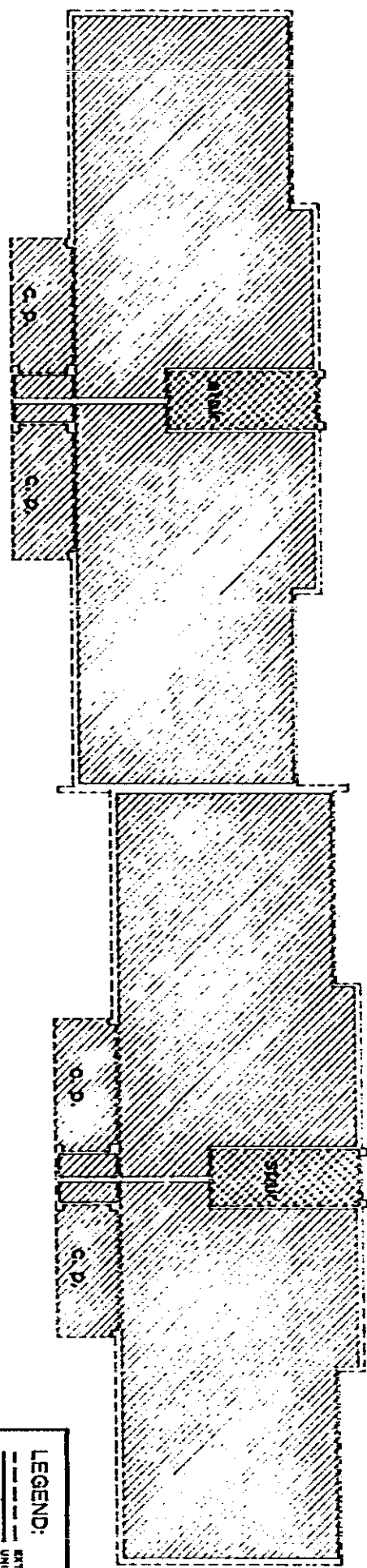

I, ORVILLE V. PLAYER, II, HEREBY CERTIFY THAT THE SE DRAWINGS
 COMPARED THE EXHIBIT ARE CORRECT ON THE BASIS OF THE
 SURVEY OF W/S WILLIAM, JR AND THAT THE AS BUILT ARCHITECTURAL
 DRAWINGS OF MILLER/PLAYER AND ASSOCIATES ARCHITECTS ARE
 AVERAGE DIMENSIONS AND SHOULD NOT BE TAKEN AS EXACT
 MEASUREMENTS

Orville V. Player, II
 ORVILLE V. PLAYER, II
 S.D. REGISTRATION #11599

LEGEND:

- EXTERIOR WALL LINE
- UNIT BOUNDARY
- GENERAL COMMON ELEMENTS
- LIMITED COMMON ELEMENTS
- C.P. DEMONSTRATES CONCRETE PORCH



30

RIVERBEND CONDOMINIUMS
 PHASE TWO
 HORIZONTAL PROPERTY REGIME
 EXHIBIT B

DATE	DESCRIPTION

MILLER/PLAYER & ASSOCIATES
 ARCHITECTS AND PLANNERS, LTD.
 1010 east north street, greenville, s.c.

James D. Miller, A.L.A. / Orville V. Player, II / Robert C. Cobble



0520

4328-472