

State of South Carolina  
 Pursuant to a warrant from John Thomas Esqr. Commissioner of Locations dated May 21st 1784. I have admeasured and laid out unto Arthur Stafford a tract of land containing five hundred acres situate in Ninety six district West of the old Indian Boundary on the branches of the Weaver dam Creek of Sagar River about one mile above the old line bounding s on land laid out unto John Clemons, all other sides on Vacant land, and hath such form and marks as the above plat represents  
 Surveyed the 1<sup>st</sup> day of July 1784  
 Recorded this 8<sup>th</sup> July 1784 / Geo. Solomon Esq.

State of South Carolina Pursuant to a Warrant to me Directed under the hand and seal of John Thomas Esqr. Commissioner of Locations for Ninety six district North of Saluda River dated the 21<sup>st</sup> day of May 1784. I have admeasured and laid out a tract of land unto Minner Hudson containing Two Hundred Acres in Ninety six district North of Saluda River, situate lying and lying on the Waters of Reddy River south side bounding on all sides on Vacant Land, and hath such shape form and Marks as the Above Plat Represents  
 Surveyed the 27<sup>th</sup> day of May 1784 Thomas Lewis Esq.  
 Recorded the 26<sup>th</sup> day of July 1784

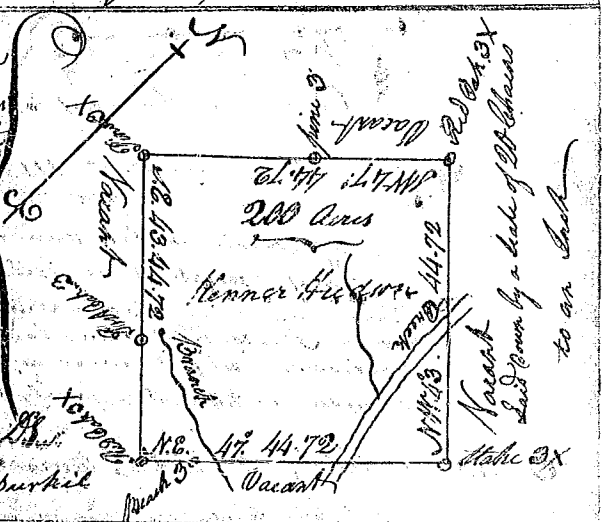

South Carolina Pursuant to a Warrant to me directed under the hand and seal of John Thomas Esqr. Commissioner of Locations for Ninety six district North of Saluda River, dated the 21<sup>st</sup> day of May 1784. I have admeasured and laid out unto Samuel Porter a tract of land containing three hundred and thirtie Acres situate lying and being in Ninety six district North of Saluda River, on the corner of the Golden Grove land bounding on the S.E. on land laid out by Rouse, on the N.E. on land Vacant, on the N.W. on Land Vacant on the S.W. on Land laid out to William Wood, and hath such form shape and Marks, as the above Plat represents  
 Surveyed the 24<sup>th</sup> day of May 1784 Thomas Lewis Esq.  
 Recorded the 26<sup>th</sup> day of July 1784

