

State of South Carolina 96 District (91)

Pursuant to a warrant to me directed by John Thomas Esq. Commissioner of Locations for the District of the north side of Saluda River, I have surveyed and laid out unto Abel Pennington a tract of land containing 120 acres Situate lying and being above the ancient Boundary Line on the south fork of Saluda river, Below Wattoos place Bounded N.E. by land survey, by Hopkins N.W. by the River, Every other side Vacant, and hath such shape and marks as the above plat Represents,
 Recorded the 11th day of August 1784

laid down by a scale of 20 Chains to an Inch

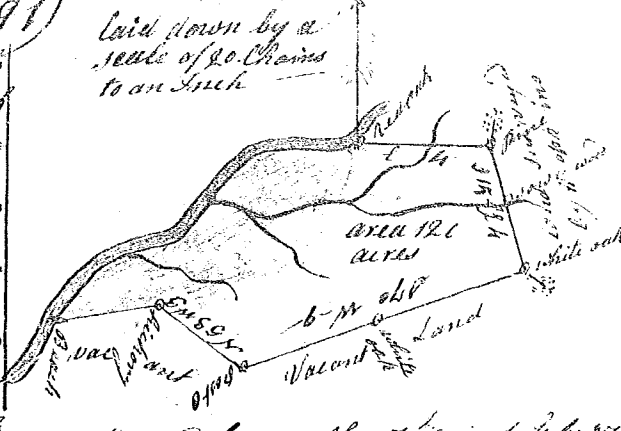

Surveyed by me the 7th day of July 1784
 James Seaborn D.S.

State of South Carolina 96 District

Pursuant to a warrant to me directed by John Thomas Esq. Commissioner of Locations for the District of the north side of Saluda I have surveyed and out unto James Pitney a tract of land containing 200 acres Situate lying and being above the old Indian Boundary on both sides of Richland Creeks a branch of Enoree River Vacant land on all sides and hath such shape and marks as the above plat Represents,
 Surveyed by me this 6th day of June 1784
 Recorded the 11th day of August 1784

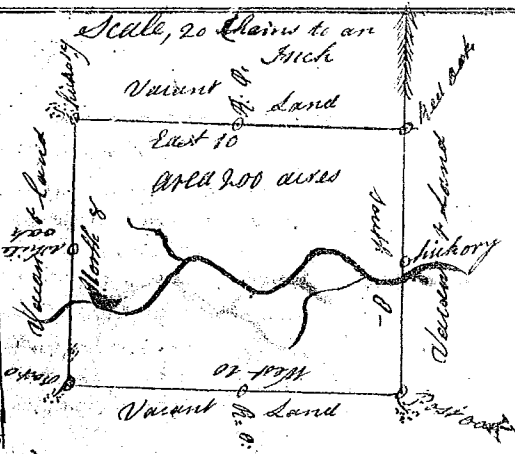

James Seaborn D.S.

State of South Carolina 96 District

Pursuant to a warrant to me directed by John Thomas Esq. Commissioner of Locations for the district of the north side of Saluda River I have surveyed and laid out unto Rebecca Wood a tract of land containing 135 acres Situate lying and being above the ancient Boundary Line on the south fork of Saluda River near the Table Mountain Boundary on the East by Abel Penningtons land on the S. by the river on all other sides Vacant, and hath such shape and marks as the above plat Represents Surveyed by me the 7th of July 1784
 Recorded the 11th day of August 1784

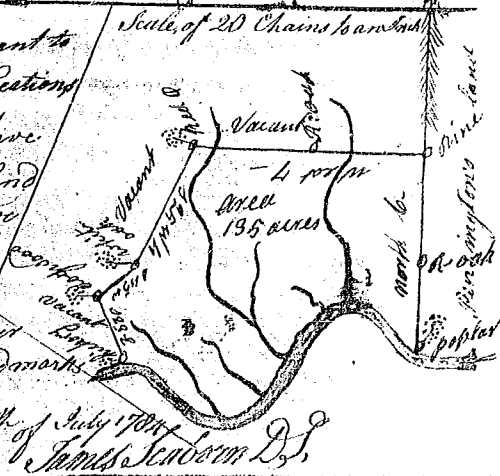

James Seaborn D.S.

State of South Carolina 96 District

Pursuant to a warrant to me directed by John Thomas Esq. Commissioner of Locations for the north side of Saluda River I have surveyed and laid out unto Absalom Carney a tract containing 220 acres Situate lying and being above the old Indian Boundary on Enoree River known by name of Carneys Improvement Vacant Land on every side, and hath shape and marks as the above plat Represents Surveyed by me the 8th day of June 1784

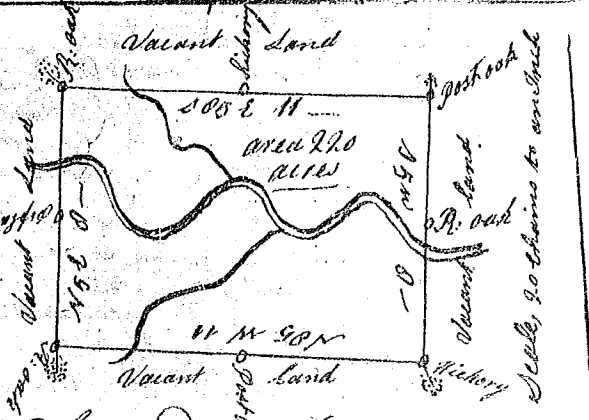

Recorded the 11th day of August 1784
 James Seaborn D.S.