

State of South Carolina, 96 District  
 Pursuant to a warrant from John Thomas Esq. Commissioner of Locations on the North side Saluda River dated the 7th July 1784 I have Admeasured and laid out unto John Ford Junr. a tract of Land containing three hundred and fifty acres lying and being on a creek called Ford's Creek to the S. E. by Vacant Land eastwardly by lines the owners unknown to the N. Westwardly by lines the owners unknown westwardly and Andrew Hendricks's land all other sides Vacant and shall such other shape and Markes as the annexed Plat Represents, Surveyed the 17th July 1784 — Phil. Watters D. S.  
 Recorded the 8th Sept. 1784

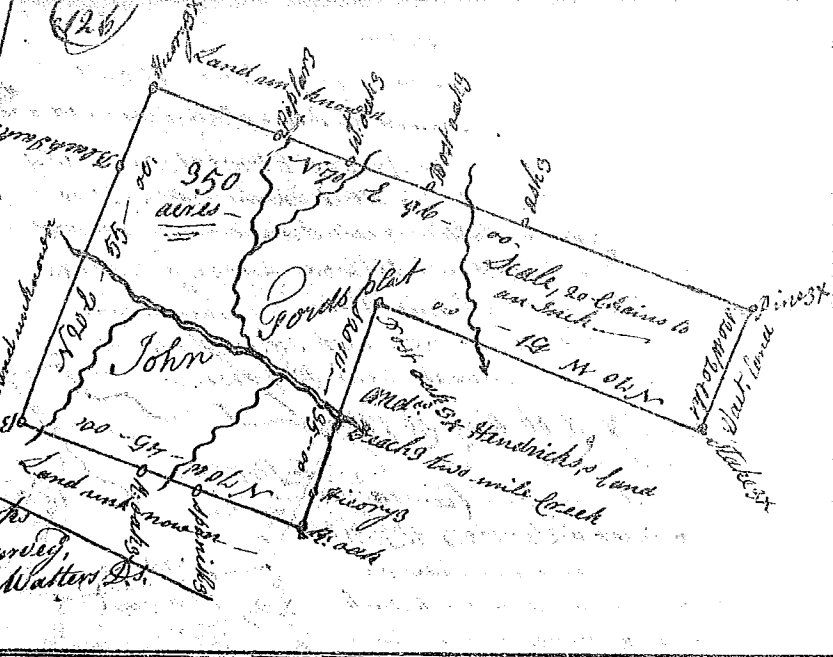

State of South Carolina 96 Dist  
 Pursuant to a warrant to me Directed by John Thomas Esq. Commissioner of Locations for the District of the North side of Saluda river I have Surveyed and laid out unto Ann Armstrong's Tract of land containing Five Hundred Acres Situate Lying and Being above the Ancient Boundary line on the North side of Saluda River. Bounded Westwardly by the S. River all other sides on Vacant Land This known by the Name of Armstrongs Improvement and has such shape and Markes as the Annexed plat Represents Surveyed by me the 12th June 1784  
 Recorded the 9th of Sept. 1784  
 James Seaborn D. S.

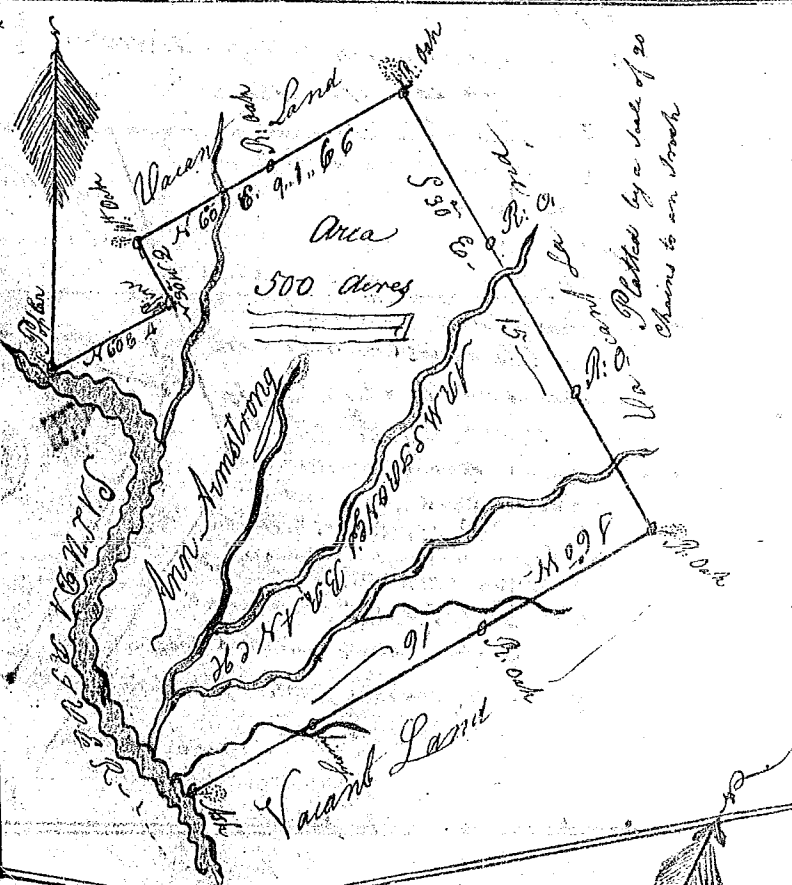

State of South Carolina 96 District  
 Pursuant to a warrant to me Directed by John Thomas Esq. Commissioner of Locations for the District of the North side of Saluda River, I have Surveyed and laid out unto Elizabeth Young a Tract of land containing 300 acres Situate Lying and Being above the Ancient Boundary line on Beaver-dam creek of Enoree River Near Parson's Mountain Bounded N. E. by Thomas Ferrar's land, all other sides Vacant and has such shape and markes as the Annexed plat Represents. Surveyed by me the 15th of June 1784  
 Recorded the 4th of Sept. 1784  
 James Seaborn D. S.

