

State of South Carolina

Pursuant to a warrant from John Thomas Esq. Commissioner of Locations in the 1st District north of Saluda River, bearing date the 26. day of May 1784 I have admeasured and laid out unto John Lind a tract of land containing two hundred & seventy one acres - on a branch of Indian Creek known by the name of the Old Fort Branch, Below the Indian Boundary, bounded Eastwardly on lands laid out to Theodoras Fullmuth and on Vacant Land W. wardly & S. wardly on Land laid out to Abraham Gray, and on John Pennington's land, and hath such shape and Marks as the annexed Plat Represents hereby.

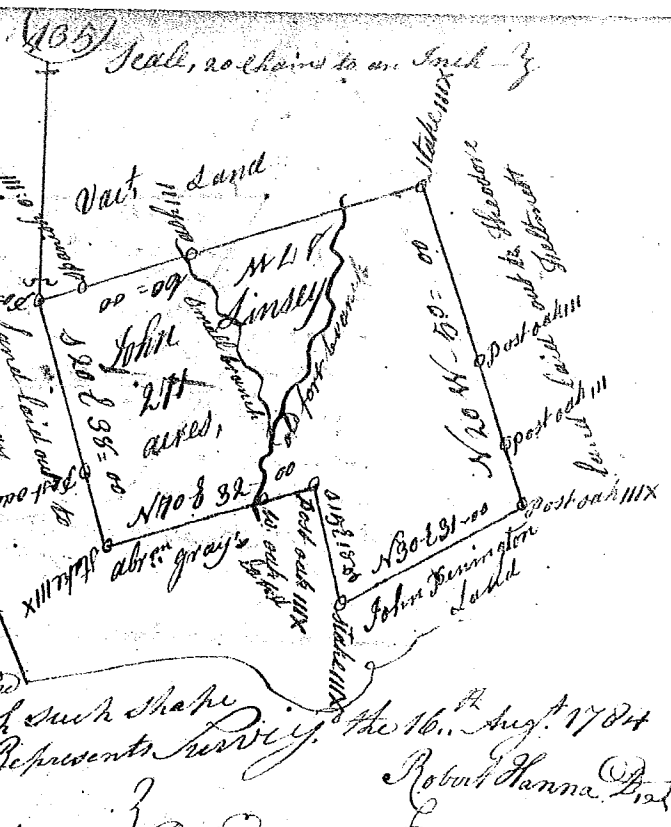

Recorded the 15. Sept. 1784 (Deliv. to Mr. Webster)

Robert Hanna Esq.

State of South Carolina

Pursuant to a warrant from John Thomas Esq. Commissioner of Locations dated the 21st day of May 1784, I have admeasured and laid out unto John Speak a tract of land containing five hundred and seventy six acres on a branch of Funchals Creek known by the name of Hodder's branch below the Indian Boundary bounding SW. on Robert Willsons and James Kelly's land and on lands of James Gales and James Abraham's, on the NE on Arthur M. Craher's land and on the NW on land laid out for J. H. H. and on all other sides on Vacant land and hath such shape and Marks as the annexed Plat Represents.

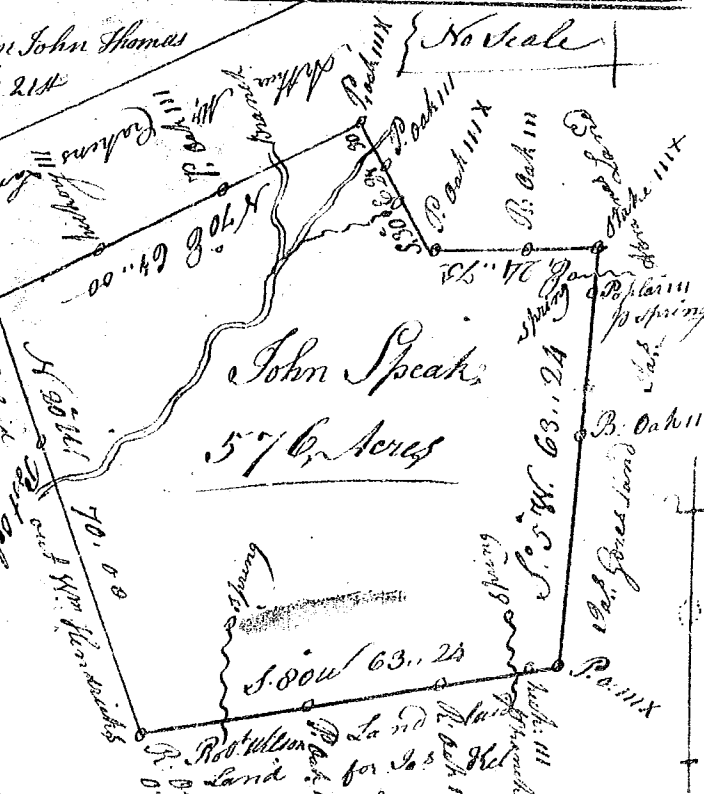

Surveyed the 10th August 1784  
 Robt Hanna Esq.  
 Recorded 16th day Sept. 1784  
 Deliv. to Mr. Webster

State of South Carolina

Pursuant to a warrant from John Thomas Esq. Commissioner of Locations dated the 21st day of May 1784 I have admeasured and laid out unto Brock Hooper a tract of one hundred & forty one acres of land situated in Ninety six District on Saluda River bounding on the north side of the aforesaid River and on all other sides on Vacant Land, and hath such shape and marks as the annexed Plat Represents Surveyed the 28 July 1784

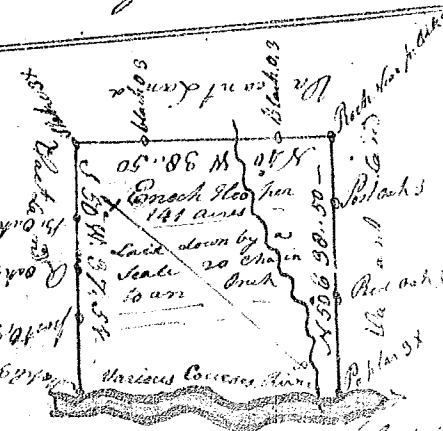

Recorded the 16. Sept. 1784  
 Wm. Peterson Esq.