

State of S. Carolina 96 District

(137)

On the East side of the Ancient Bowen
 = day line Pursuant to a warrant
 from John Thomas Esq of Commis-
 = sioner of Locations, dated the 1st June
 1784. I have admeasured and laid
 out unto Ephraim Hill a Tract of land
 containing Two Hundred and sev-
 = enty seven acres. lying on a small
 Spring branch of (Duck Creek)
 Bounded to the North by Samuel
 Morris land, to the west by an old
 Survey, all other sides by Vacant
 Land and hath such shape and marks as
 the annexed plat Represents. Surveyed the
 3rd of August 1784

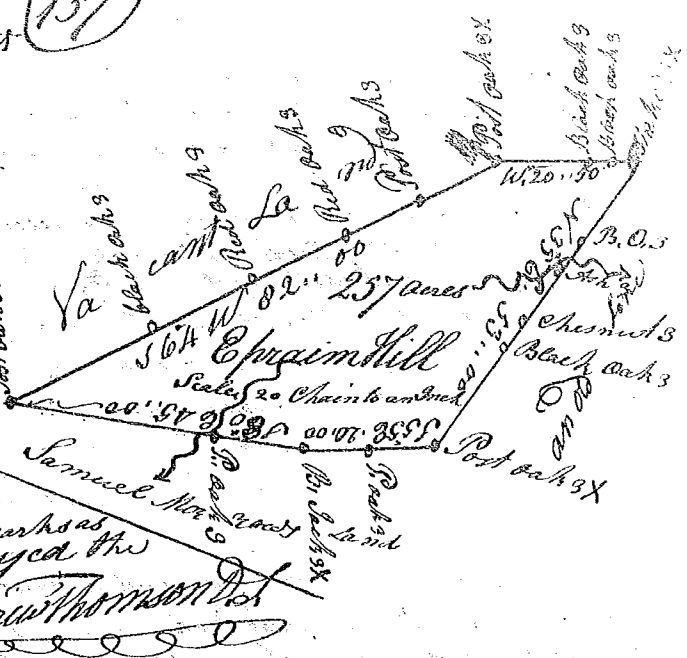

Recorded the 27th Aug^r 1784

State of South Carolina Ninety six district, East of the Indian Boundary line

Pursuant to a warrant from John Thomas Esq.
 Commissioner of Location on the North side of Saluda
 River dated the 17th July 1784. I have admeasured
 and laid out unto William Thomson a tract of land
 containing Two hundred and forty seven acres,
 lying on a small branch of Shickety Creek bounded
 to the SW by one Morris land NW by the said
 William Thomson's land, all other sides
 Vacant Land and hath such shape and marks
 as the above plat Represents.

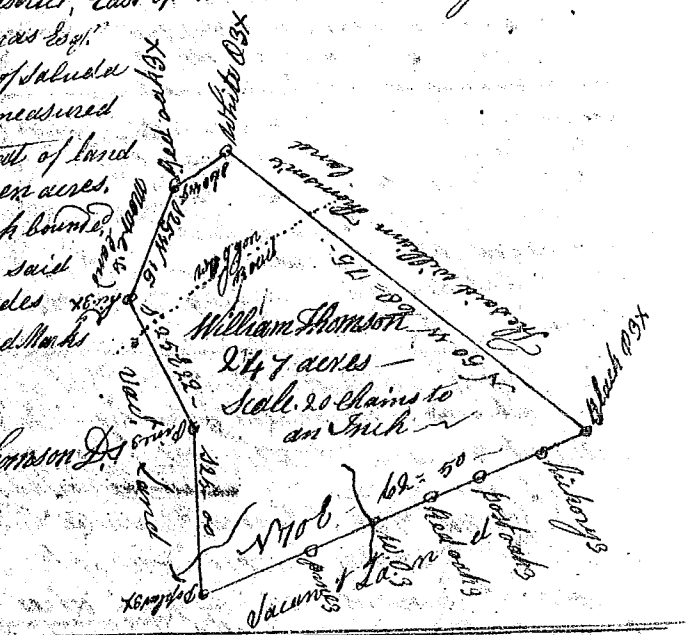

Surveyed the 17th day July 1784

Recorded 27th Sept^r 1784

State of South Carolina 96 District

Pursuant to a warrant to me directed by John Thomas Esq.
 Commissioner of Locations for the district of the North
 side of Saluda River I have surveyed and laid
 out unto Isaac Chapman a tract of land contain-
 = ing two hundred and fifty acres situate ly-
 = ing and being below the ancient boundary line
 on the south side of Broad River beginning at the
 Mouth of people's Creek about 4 out below the Old
 = rooke ford Bounded by the name of Malvern's improve-
 = ment, Bounded NE on Broad River on all other sides
 by Vacant Land and hath such shape and marks as the
 above plat Represents Surveyed 2nd Sept^r 1784

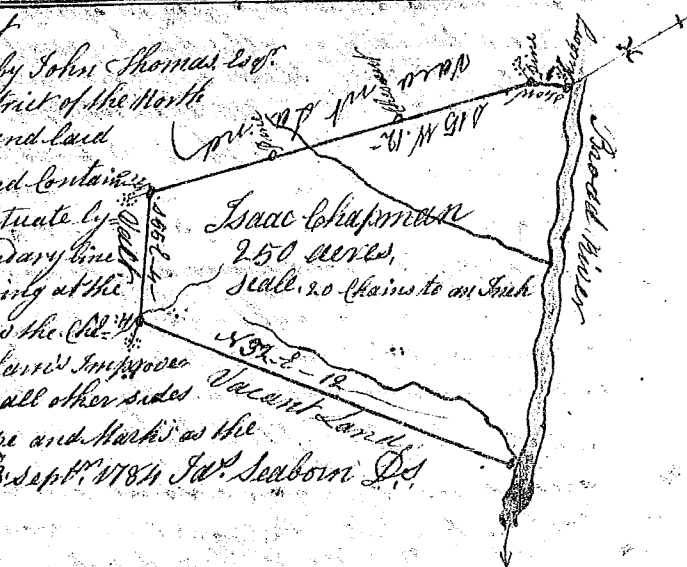

Recorded 27th Sept^r 1784