

State of South Carolina

Pursuant to a warrant from John Thomas Commissioner of Locations dated 10th day of July 1784 I have admeasured and laid out unto William Marchbanks a tract of land containing six hundred acres situate in Ninety Six district on the south side of Moore River including the of Giddens Creek and Peters Creek of said River bounding SW and SE on Benj. Roney and vacant land NW on Ann Johnstons and Benj. Roney NE on John Henderson's land East of the old Indian boundary and hath such form and Marks as the above plat represents  
 Surveyed 5th Augt 1784 George Salmon Esq  
 Deliv. Abner Churchfield  
 Recorded 28th Sept 1784

State of South Carolina 9th District East of the ancient boundary line

Pursuant to a warrant from John Thomas Esq. Commissioner of Locations North side Saluda River Dated the 6th day of July 1784 I have admeasured and laid out unto Matthew Patton Esq. a tract of Land containing one hundred and thirty acres lying on Mc. Chivers Creek bounded NW by William Patton's land, all other sides Vacant Land and hath such shape and Marks as the annexed plat represents, Surveyed 12th July 1784  
 Recorded 28th Sept 1784 Phil. Waters Esq.

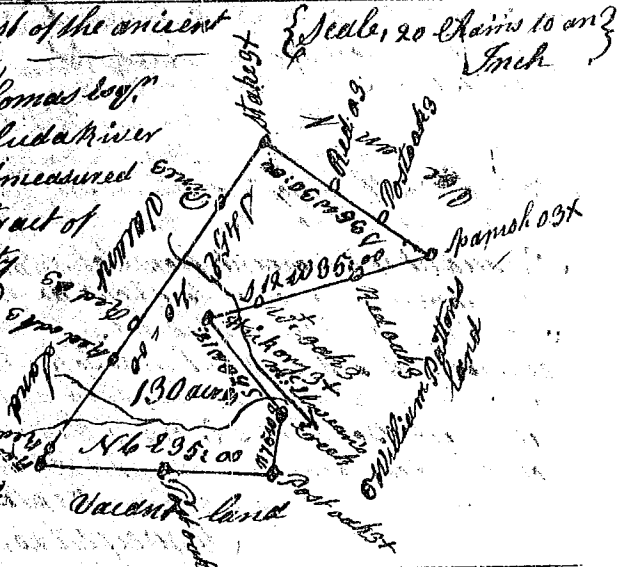

State of South Carolina 9th District East of the Boundary line

Pursuant to a warrant from John Thomas Esq. Commissioner of Locations North side Saluda River dated 21 June 1784 I have admeasured and laid out unto Isaac Bogan a tract of land containing three hundred acres lying on Sugar Creek bounded SW by said Bogan's land, and John Blossingame's land, all other sides Vacant Land and hath such shape and Marks as the above Plat represents, Surveyed the 3. July 1784  
 Recorded 29th Sept 1784

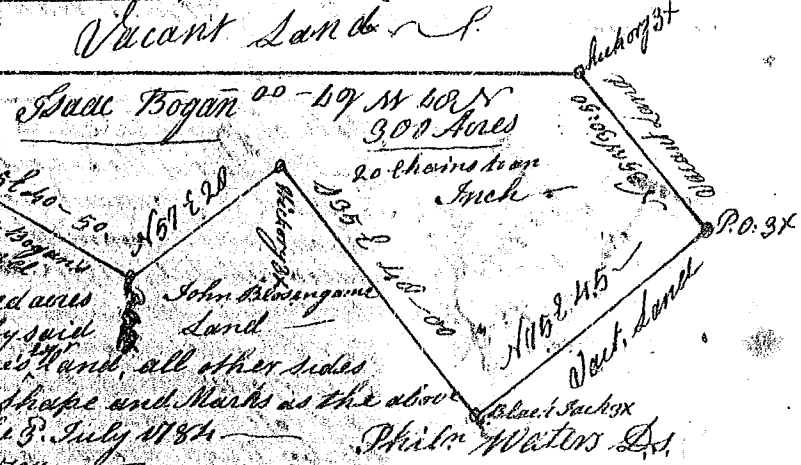

Phil. Waters Esq.