

State of South Carolina Ninety Six (169)
 District East of the ancient Boundary
 Pursuant to a warrant from John Thomas
 Esq. Commissioner of Locations for the North
 side of Saluda River Dated 24 June 1784 I have
 Admeasured and laid out unto William Aldridge
 a Tract of land containing two hundred
 acres, bounded S.W. by King's Mahomys
 Land N.W. by Vac. Land N.E. by M. B. land
 North by Pacolet River And hath such shape
 and marks as the annexed plat Represents
 Surveyed the 10 July 1784 D. Waters
 Recorded the 30 Sept. 1784

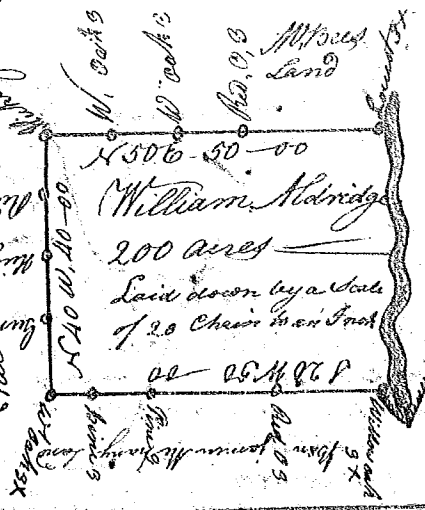

State of South Carolina
 Pursuant to a warrant from
 John Thomas Esq. Commissioner of Loca-
 tions. I have admeasured and laid out
 unto John Albritain a tract of land con-
 taining two hundred and twenty
 acres. Situate in Ninety six District
 on the waters of Browns creek. Bounded
 N.E. by Vac. Land & all other sides Vac.
 Land & land laid out. Hath such shape
 and marks as the Annexed plat Represents
 Surveyed the 11 August 1784 D. Hopkins
 Recorded the 30 Sept. 1784 (Delivered to J. Albritain)

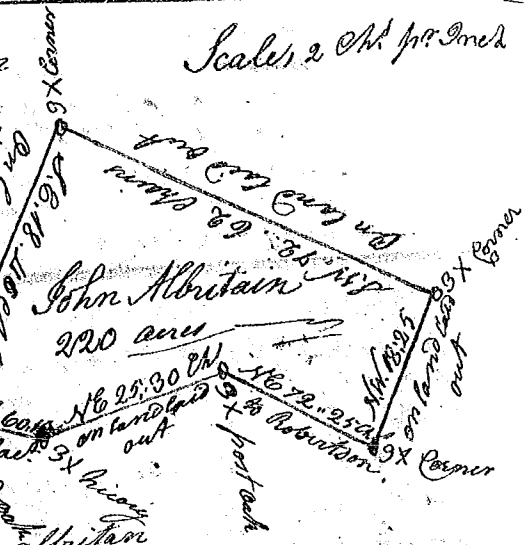

State of South Carolina
 Pursuant to a warrant from John Thomas,
 Esq. Commissioner of Locations
 in Ninety Six District N. Saluda
 (dated the 14 June 1784) I have ad-
 measured & laid out unto James
 Crooks a tract of land containing
 five hundred & fifty acres on Browns
 creek below the Indian Boundary
 in Ninety Six District Bounded
 S. on Bounty land E. on Thomas Deans
 Land N. on John Atways Land S.E. on John
 McClintock's Land. S.W. on Survey Land
 and hath such shape and marks
 as the annexed plat Represents
 Surveyed the 16 June 1784 D. Thomas
 Recorded the 5 day of Oct. 1784 (Deliv. to J. Crooks)

