

State of South Carolina 96 District 1784

Pursuant to a warrant from John Thomas Esq. Commissioner of Locations I have measured and laid out unto David Ferguson a tract of 300 acres of land situated in Ninety Six District on the waters of Peters creek on the South Side of Broad River bounding N.E. by the Hill & Mary Crawls land S.W. on Aubry Nolans land Chandlers Land N.W. on Sa. Robertsons land all other sides Vac. and hath such shape and marks as the above plat represents Surveyed this 26th day of Aug. 1784 (D. Hopkins Esq.) Recorded the 4th day of Oct. 1784 Delivered to David Ferguson

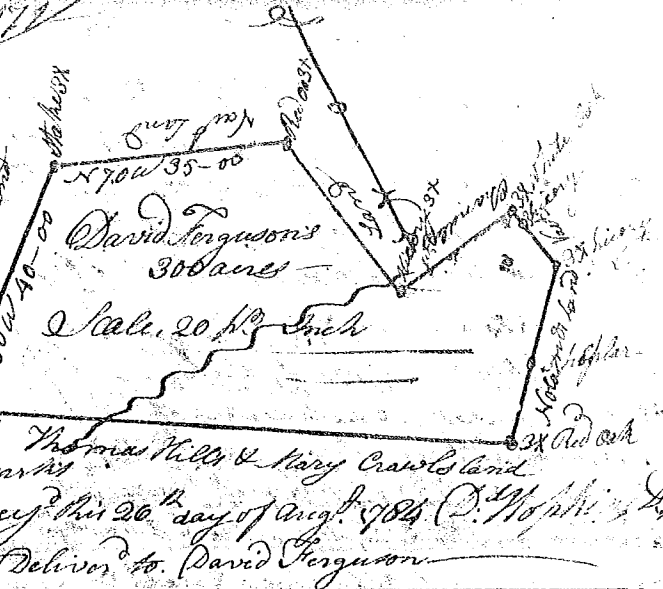

State of S. Carolina

Ninety Six District Pursuant to a warrant from John Thomas Esq. Officer of Locations dated I have Admeas-ured and laid out unto John Valentino a tract of three hundred acres of land situate in Ninety Six District on the South Side of Enoree River bounding South East on Robert Johnsons and on Enoree River N.W. on said River & Virging And Doils land & S.W. on land belonging to Beard, and hath such shape and marks as the annexed plat represents Surveyed this 21st day of Sept. 1784 (David Hopkins Esq.) Recorded the 1st Oct. 1784 (Delivered to David Ferguson)

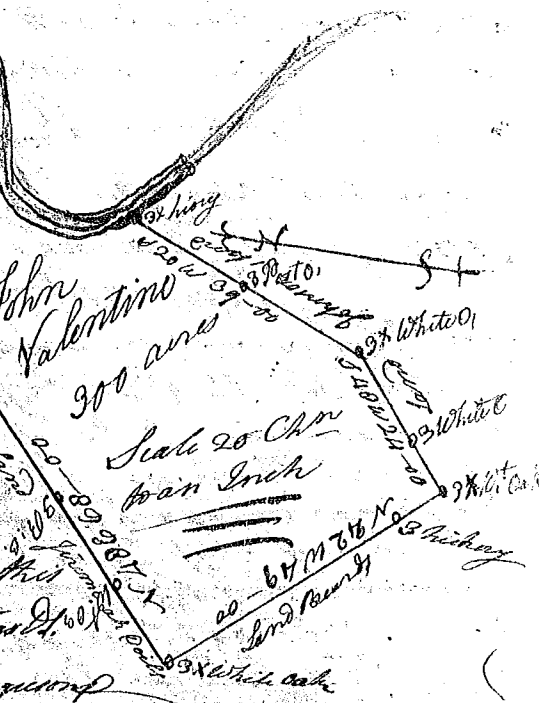

State of S. Carolina

Pursuant to a warrant from John Thomas Esq. Commissioner of Locations dated the 27th day of Sept. 1784 I have Admeasured and laid out unto James Terrel a tract of land containing one hundred & thirty four acres situate in Ninety Six Dist. East of the Old Boundary on the S side of Broad River including part of M. Cowns Island bounding S.E. on land Unknown all other sides Vac and land Broad River and hath such form & marks as the above plat represents Surveyed the 29th of Sept. 1784 (George Salmon) Recorded the 5th Oct. 1784

