

State of South Carolina 96 Dec 113
 On the East side of the ancient Boundary line
 Pursuant to a warrant from John Thomas Esq.
 Commissioner of Locations for the North side of
 Saluda River bearing date the 21st July 1784
 I have admeasured & laid out unto Henry White
 a tract of land containing seventy acres
 lying & being on the waters of fair forest
 bounded Et by John Thomas Jun. N.W. by
 James Lakin the other two sides by the said
 Henry White's land Survey of Aug 1784
 Recorded the 5th Oct 1784
 P. Waters Esq.

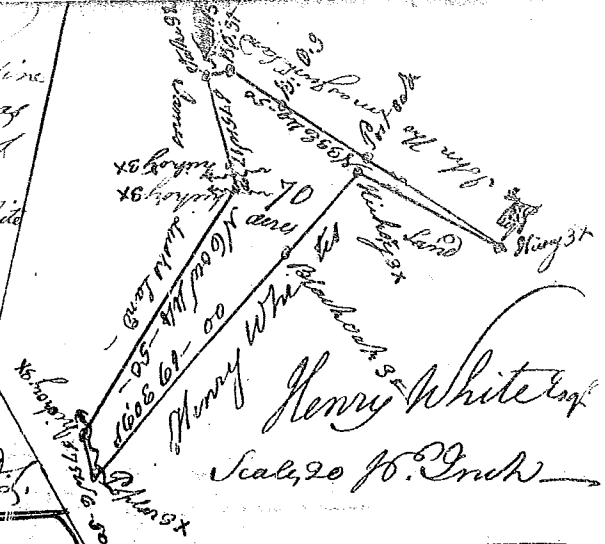

Henry White Esq
 Scale, 20 ft. Inch

State of South Carolina 96 Dis.
 On the East side of the ancient Boundary
 Pursuant to a warrant from John Thomas Esq.
 Commissioner of Locations for the north side
 of Saluda River bearing date the 5th June
 1784. I have admeasured & laid out unto
 George McAster a tract of land contain-
 ing three hundred acres lying & being
 on the waters of fair forest bounded
 West by an old line S.E. by Crues land N.E.
 by Hugh Donaldson's land N.W. by Jack-
 Land & both such shape and marks as the
 the annexed Plat represents Survey of the 9th
 of July 1784
 Recorded the 5th of Oct 1784
 P. Waters Esq.

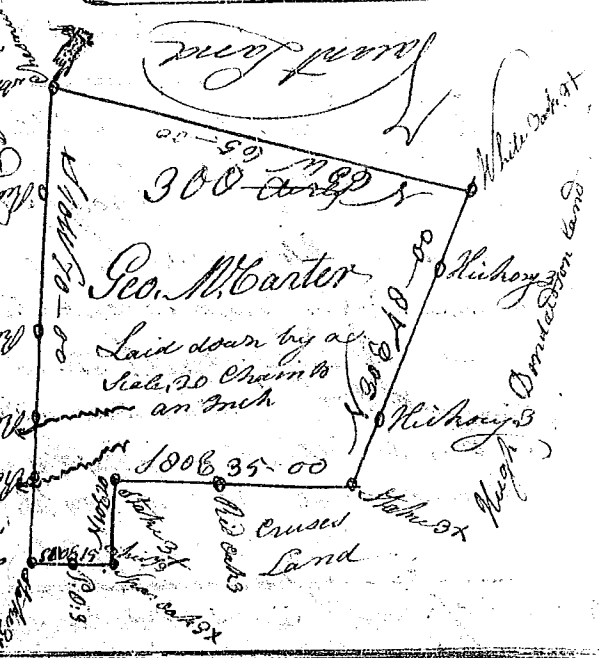

Geo. McAster
 Laid down by a
 Scale, 20 Chains to
 an Inch
 1006 35-00
 Crues
 Land

State of South Carolina
 Variety Six District East of
 of the old Boundary line
 Pursuant to a warrant
 from John Thomas Esq.
 Commissioner of Locations
 dated June 1st 1784 I have
 admeasured and laid
 out unto George Storey
 Junr. a tract of land
 containing six hun-
 dred acres, lying on
 both sides of Foster's
 Mill Creek bounded
 N.E. by Robert
 Harris N.W. by Isaac
 Land & Joseph Nicolls
 N. by Sam. Kelso and
 vacant land & both such shape
 and marks as the above plat represents
 Survey of 13th of July 1784 Per
 Recorded the 5th October 1784

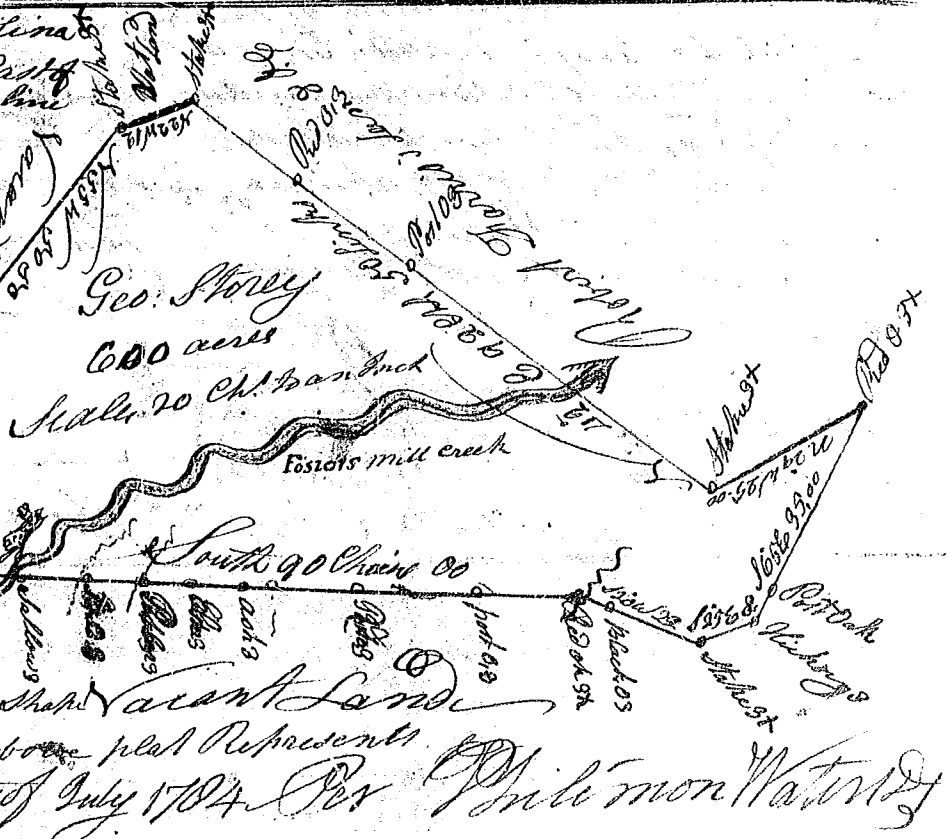

Geo. Storey
 600 acres
 Scale, 20 Ch. to an Inch

Per P. Waters Esq.