

State of South Carolina

(19A)

Pursuant to a warrant from John Thomas Esq. Commissioner of Locations for the district of Saluda dated the 1<sup>st</sup> day of June 1784. I have admeasured & laid out unto Charles Hunt a tract of land containing two hundred & thirty acres. On Pattersons creek below the Indian Boundary, bounded S. on John Pattersons land & on land unknown all other sides Vacant & hath such shape & marks as the above map represents



South Carolina Ninety six District

Pursuant to a warrant from John Thomas Esq. Commissioner of Locations, I have admeasured and laid out unto Moses Haynes a Tract of land containing one hundred and fifty acres. S<sup>th</sup> Warrant bearing date the 7<sup>th</sup> June 1784. said tract of land lying & being on a small branch of Tigger River on the south side of S. River bounded NW. by the S. Moses Haynes E. by Lewis Bots S.W. by Geo. Normans land all other sides Vacant & hath such shape and marks as the annexed plat represents

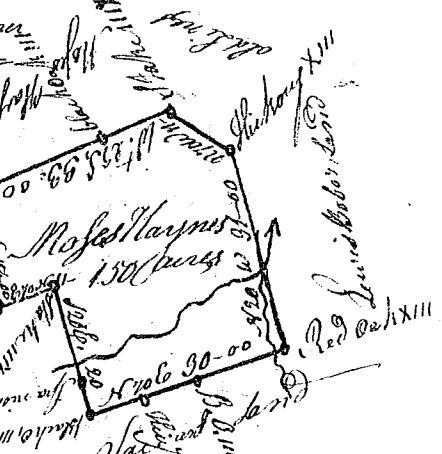

State of South Carolina

Pursuant to a warrant

from John Thomas Esq. Commissioner of Locations for the (dis. of Ninety six) dated the 11<sup>th</sup> July 1784. I have admeasured and laid out unto Robert Templeton a tract of land containing one hundred acres on a branch of Oureans Creek on both sides of the road leading from Newgroves mill to ninety six below the Indian boundary bounded on all sides by Vacant Lands, and hath such shape and marks as the annexed plat represents

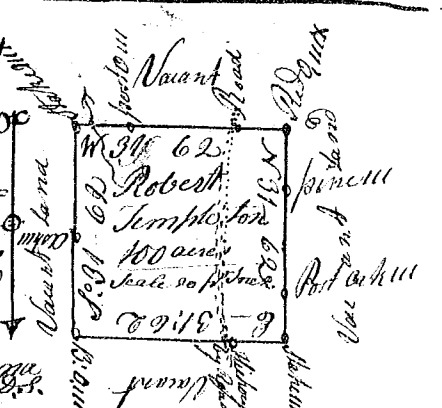

State of South Carolina

Pursuant to a

warrant from John Thomas Esq. Commissioner of Locations in Ninety six District of Saluda bearing date the 3<sup>rd</sup> day of June 1784. I have admeasured & laid out unto David Norman a tract of land containing one hundred & ninety five acres on Coursons Creek of Tigger River below the Indian line, bounded S. on land laid out to Will. Smiths All other sides Vacant lands and hath such shape and marks as the annexed plat represents

