

State of South Carolina

(204)

Pursuant to a warrant from John Thomas Esq. Commissioner of Locations dated the 10th day of August 1784, I have admeasured and laid out unto Abraham Shasteen a tract of one hundred of land, situate in Ninety six district west of the ancient boundary on a branch of South Sagar River, bounding NE of Tobias Peltier, NW to John Pitman, all other sides on Vacant land, and hath such shape and Marks as the above Plat represents Surveyed the 10th Oct. 1784

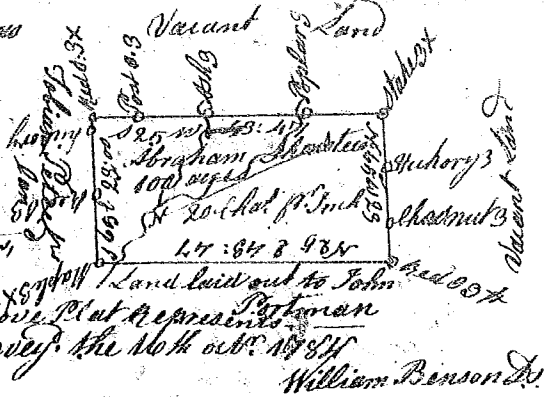

State of South Carolina

Pursuant to a warrant from John Thomas Esq. Commissioner of Locations for ninety six district North Side of Saluda River, dated 2d Oct. 1784 I have admeasured and laid out unto James Vardiman a tract of two hundred acres of Land situate in ninety six district on the north side Saluda River below the ancient boundary on waters of Enoree River bounded NE on Salub Johnstone's land SE on Mallone's land all other sides on Vacant land, and hath such shape & Marks as the annexed Plat represents Surveyed 2d November 1784 This waters Recorded Nov. 16th 1784 D. Jurg.

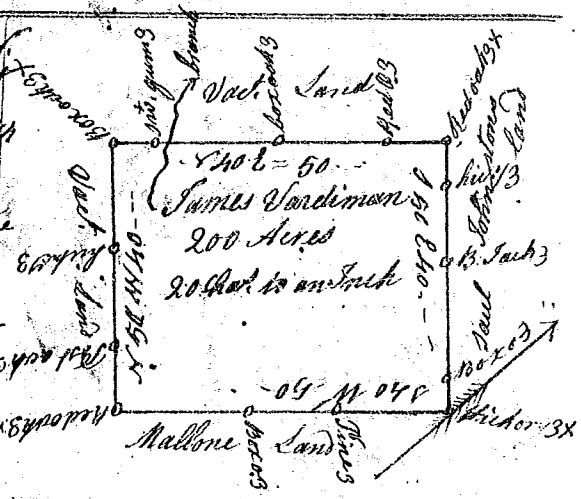

State of South Carolina

Pursuant to a warrant from John Thomas Esq. Commissioner of Locations in Ninety six district North side Saluda River dated 21st day of May 1784, I have admeasured and laid out unto James M. Laughlin a tract of Land containing one hundred acres on Needy River above the Indian Boundary, bounding SW on land laid out to Cap. Goodwin all other sides on Vacant Land, and hath such shape and Marks as the above Plat represents, Surveyed 19th June 1784 Recorded 16th Nov. 1784 Robt. Hanna D.

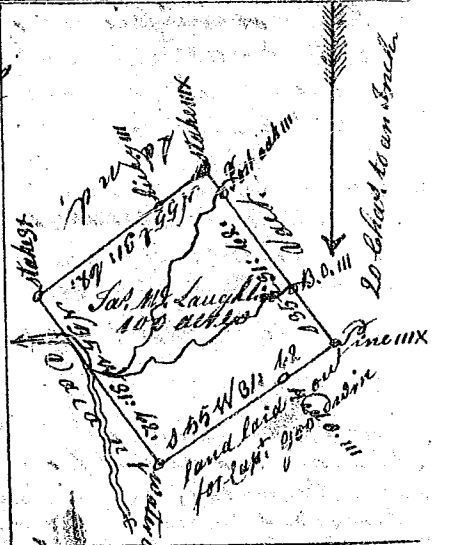

State of South Carolina

Pursuant to a warrant from John Thomas Esq. Commissioner of Locations in Ninety six district North side Saluda River dated 16th day August 1784, I have admeasured and laid out unto John Redman a tract of Land containing six hundred and forty acres on Derbins Creek above the ancient boundary line Bounded on all sides on Vacant Land, and hath such shape and Marks as the annexed Plat represents, Surveyed 2d Sept. 1784 Recorded 16th Nov. 1784 Robt. Hanna D.

