

State of South Carolina

Pursuant to a warrant from John Thomas Esq. Commissioner of Locations dated the 28th day of July 1784. I have admeasured and laid out unto Henry Moffitt a tract of land containing three hundred & thirty acres, situate in Ninety six District East of the old Indian Boundary line, on both sides of Middle branch of Sugar River Bounding N^o on Clerk's Land S.E. on Thomas Davis's land all other sides on vacant land, and hath such ~~marks~~ ^{marks} as the annexed plat represents, Survey^d the 30th July 1784
Recorded the 27th Nov. 1784

(214)

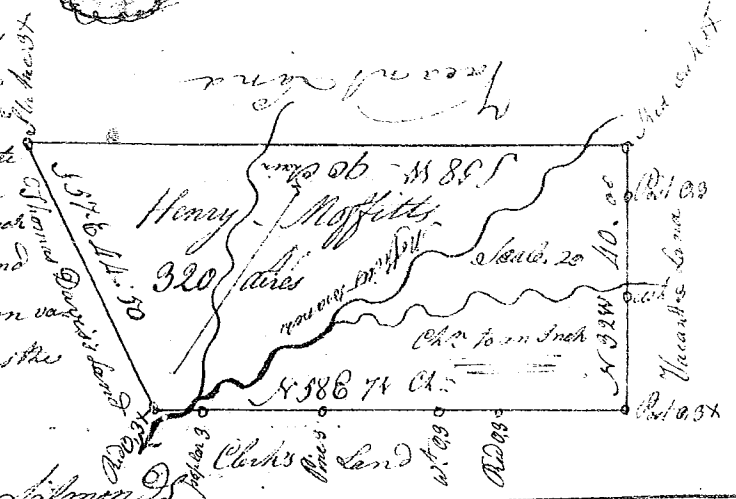

George Salmon

State of South Carolina Pursuant to a Warrant from John Thomas Esq. Commissioner of Locations dated the 0th day of July 1784. I have admeasured and laid out unto Spence Ford a tract of land containing three hundred and ten acres, situate in Ninety six District on a small Branch of forked Creek East of the Indian Boundary line, bounded N^o by vacant land Est by Hancock Smith's S^o by William Pines's Land and has such ~~marks~~ ^{marks} as the annexed plat represents, Survey^d the 28th July 1784
Recorded the 27th Nov. 1784

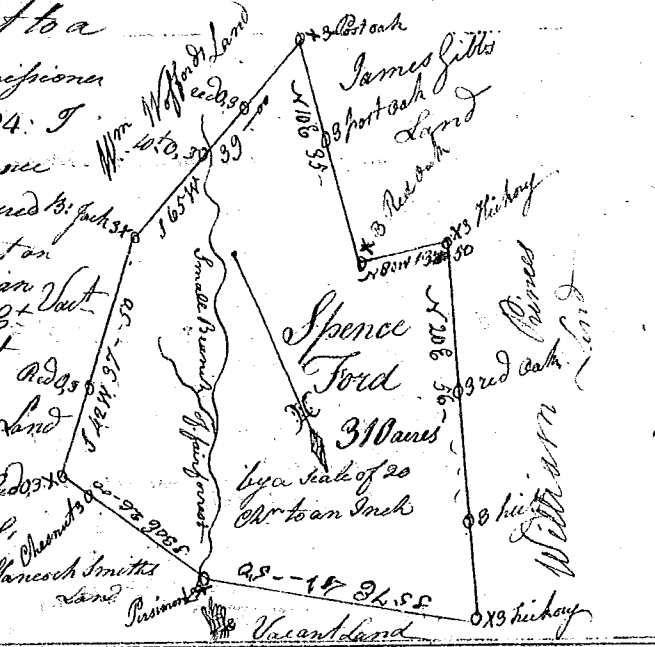

Geo. Salmon

State of South Carolina Pursuant to a warrant from John Thomas Esq. Commissioner of Locations, I have admeasured & laid out unto Daniel Latham a tract of one hundred and fifty acres of land situate in Ninety six District on the waters of Crouse & Sugar Rivers Bounding N^o on land laid out, all other sides on land laid out, and hath such shape and marks as the annexed plat represents, Survey^d the 2nd day of Sept. 1784
Recorded the 24th of Nov. 1784

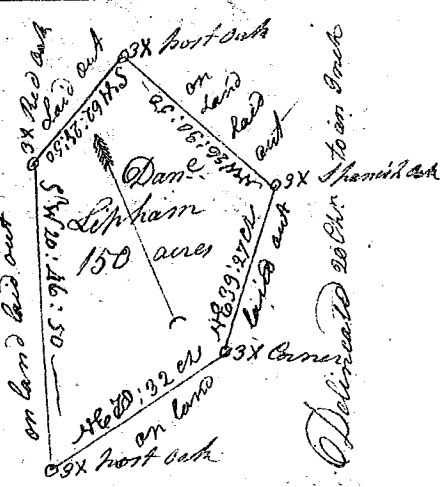

D. Hopkins

State of South Carolina Pursuant to a warrant from John Thomas Esq. Commissioner of Locations for Ninety six District N^o of Saluda, dated the 28th Day of Sept. 1784: I have admeasured and laid out unto John Goodwin a tract of two hundred & fifty acres of land situate in Ninety six District on the N^o side of Saluda, below the ancient Boundary, on waters of Jelders creek, bounded S^o by J. Goodwin's land all other sides vacant land and hath such shape and marks as a mess^g plat represents, Survey^d this 28th day of Sept. 1784
Recorded the 24th Nov. 1784

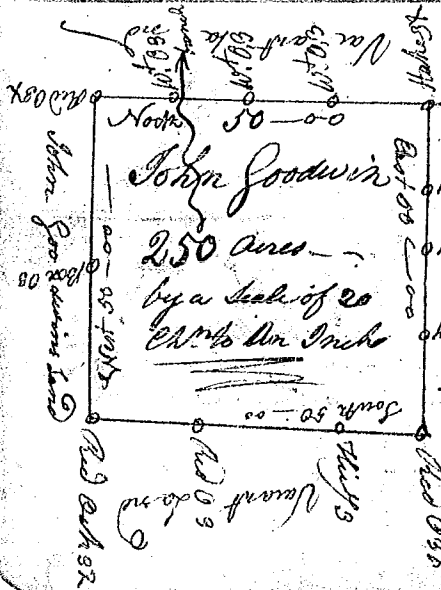

John Goodwin
250 acres
by a scale of 20 Ch. to an Inch

Waters