

South Carolina

Pursuant to a warrant from John Thomas Esq. Commissioner of Locations for the District of Ninety Six Saluda dated the 15th day of Sept. 1784 I have

surveyed and laid out unto William Cannon a tract of one hundred and fifteen acres of Land in the said District situate on a branch of gidders creek the waters of Enoree bounding Edward on Hugh Mied and William Dunlap and on Bright survey toward on Daniel Dunlap and an Irish survey name unknown situated on Daniel Williams and Samuel Cannon Edward on said Williams and Cannon Having such form and marks as the above Plat represents, Survey the 21 day of Oct. 1784 Phil Peckham Del. Recorded the 8th Dec. 1784.

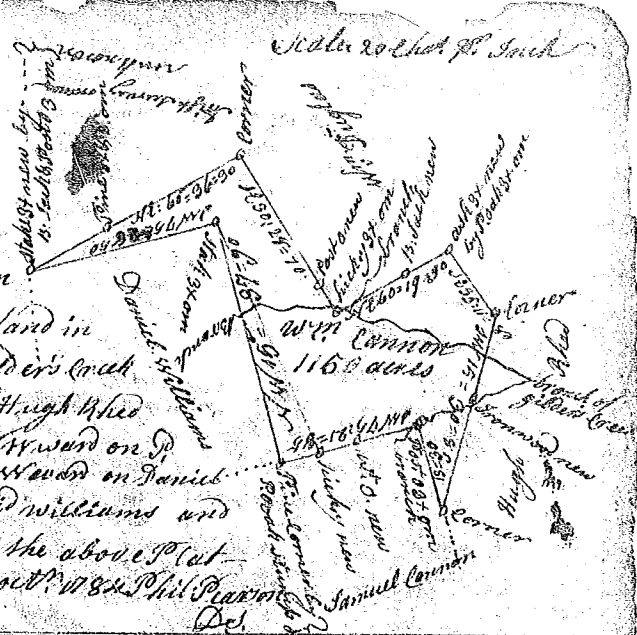

State of S. Carolina

Pursuant to a warrant from John Thomas Esq. Commissioner of Locations dated the 25th of August 1784. I have admeasured & laid out unto Samuel Neighbors a Tract of Land containing six hundred and forty acres, situate in 96 District Below the ancient Boundary line on Needy River, bounded on said River N. & N.W. by Robert Carter & Mares Samlen W. by Richard Fowler the widow Jones & Joseph Kellit S and S.E. on W. Williamson & John Bais Larney, & hath such shape and marks as the annexed Plat represents, Survey by me the 14th Oct. 1784 Recorded the 8th Dec. 1784.

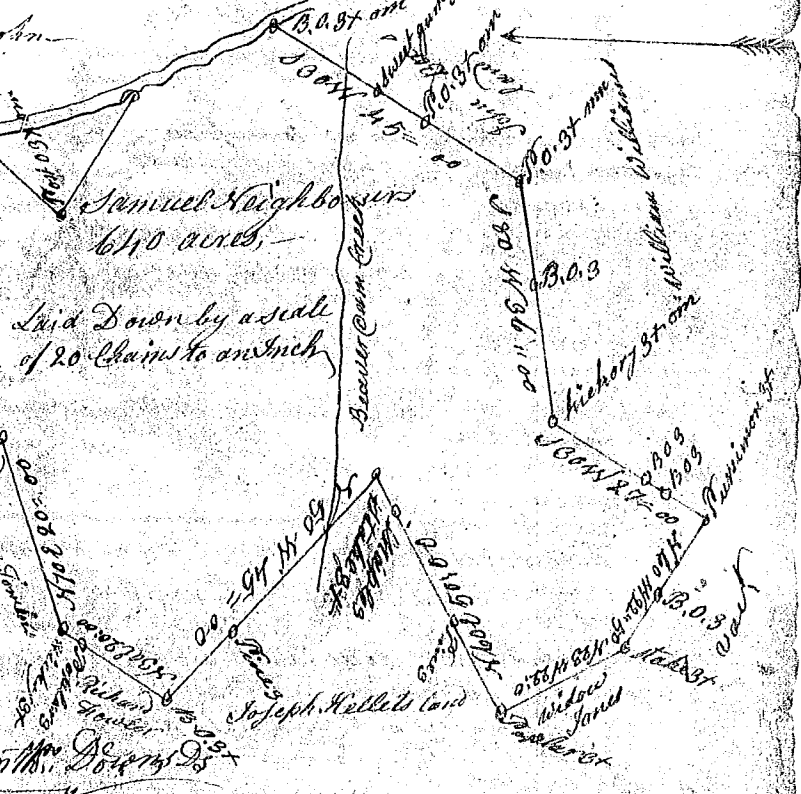

State of South Carolina. Pursuant to a Warrant from John Thomas Esq. Com. of Locations for Ninety six District N. Saluda River, dated the 22nd of Oct. 1784, I have admeasured & laid out unto Barth Johnson a Tract of one hundred and Eighty acres of Land, situate in Ninety six Dis. North of Saluda River, Below the ancient Boundary line, on Waters of Enoree River, Bounded W. by Malones Land, land laid out & Vacl Land 16 by land Laid out on all other sides by Bartholomew Johnsons Land and hath such shape & marks as the annexed Plat represents, Survey the 9th of Nov. 1784 Recorded the 8th Dec. 1784.



Waters