

State of North Carolina

Pursuant to a warrant from John Thomas Esq. Commissioner of Locations for Ninety six district No. of Saluda River dated the 23rd of Sept. 1784: I have admeasured and laid out unto John Hampton a Tract of 252 hundred & fifty two acres of land Situate in 96 District on the N^o. side of Saluda River Below the Ancient Boundary on Waters of Enoree River Bounded NW. by Nathan Boovers Morgan's lands SE by an old survey & all other Nees Vast Land And hath such shape & marks as the Annexed Plat Represents. Survey^d the 1st day of Oct. 1784
Recorded the 9th Dec. 1784

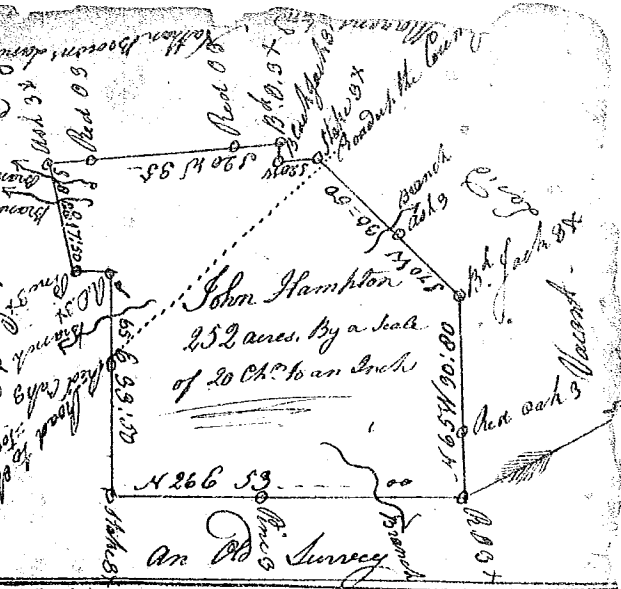

State of South Carolina Pursuant to a warrant from John Thomas Esq. Commissioner of Locations for 96 District North side of Saluda River dated 22 day of Sept. 1784. I have admeasured and laid out unto John Hampton a tract of 65 acres of land Situate in Ninety six district on the N^o. side of Saluda River Below the Ancient Boundary on Waters of Enoree River Bounded NW Corn by land laid out SE by Blaygers land and John Speaks island. All other Nees Vast & hath such shape & marks as Annexed plat Represents. Survey^d this 9th Nov. 1784
Recorded the 9th Dec. 1784



State of South Carolina Below the Line

Pursuant to a warrant from John Thomas Esq. Com^r of Locations. I have admeasured and laid out unto Stephen Sparks a Tract of one hundred acres of land Situate in Ninety six District on Waters of Indian Creek Bounding NW by on Land laid out unto John Ryans all other sides Vast Land And hath such shape & marks as the Annexed Plat Represents
Survey^d the 25th of Oct. 1784
Recorded the 9th of Dec. 1784

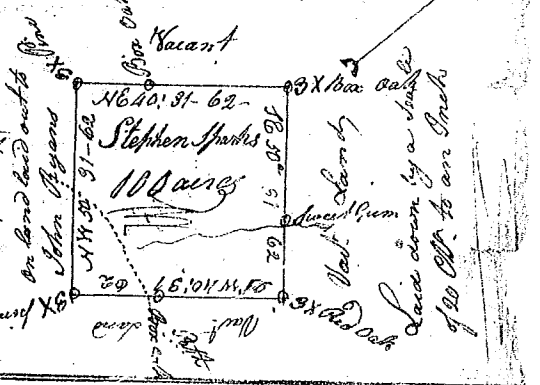

South Carolina Pursuant to a warrant Granted under hand & Seal of Sa. Thomas Esq. Commissioner of Locations for Ninety six District No. side Saluda River dated the day of August 1784. I have admeasured and laid out unto John Johnson a tract of land Containing Three Hundred & Twenty acres. Situate in Ninety six District lying land being above the Indian Boundary on Cromwell's fork of horse creek a Branch of the River Bounding SE on land laid out to Joshua Saxson & W on land Laid out to Mary Huger & land laid out to Rich. Gough. all other sides vacant land & hath such shape form and marks as the Annexed Plat Represents
Survey^d & Certified the 30th Aug. 1784
Recorded the 9th Dec. 1784

