

Pursuant to a Precept Directed under the hand and seal of John Worswick Esq. Deputy Surveyor genl. dated the 2. day of February 1773 I have admeasured and laid out unto George Lowther a plantation or tract of Land containing two hundred and fifty acres in Craven County situated lying and being on ^{a branch of} ~~the~~ ^{the} waters of Tar River and bound by John Hendricks land N. by by Isaac Hendricks land and bound W. by by Robert Pringle land and Robert Hamilton and bound on all other sides by Vacant Land, and hath such shape forms and Marks as the above Plat Represents.

Certified under my hand and the 9th Day February 1773.
Recorded the 8th day of Decr 1784.

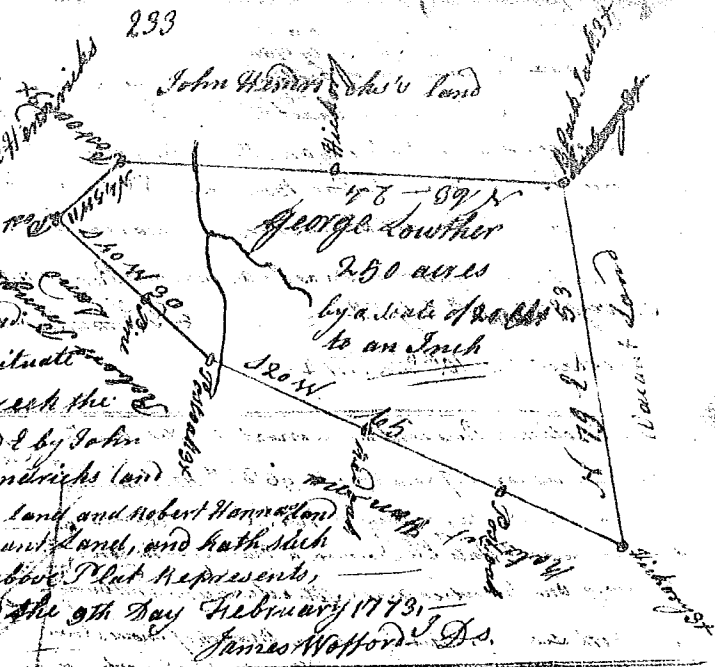

State of South Carolina - 96 Dist.
Pursuant to a warrant from John Thomas Esq. Commissioner of Locations on the North side of Saluda River dated the 24 day November 1781, I have admeasured and laid out unto John Patton a plantation or tract of Land containing three hundred acres lying on a branch called Birds Creek on both sides of said Creek bounded SW by an old line, S by David Andersons land and hath such shape and Marks as the above Plat Represents.

Recorded 9th Decr 1784.
Surveyed 6th Decr 1781 by And. Himmion Esq.

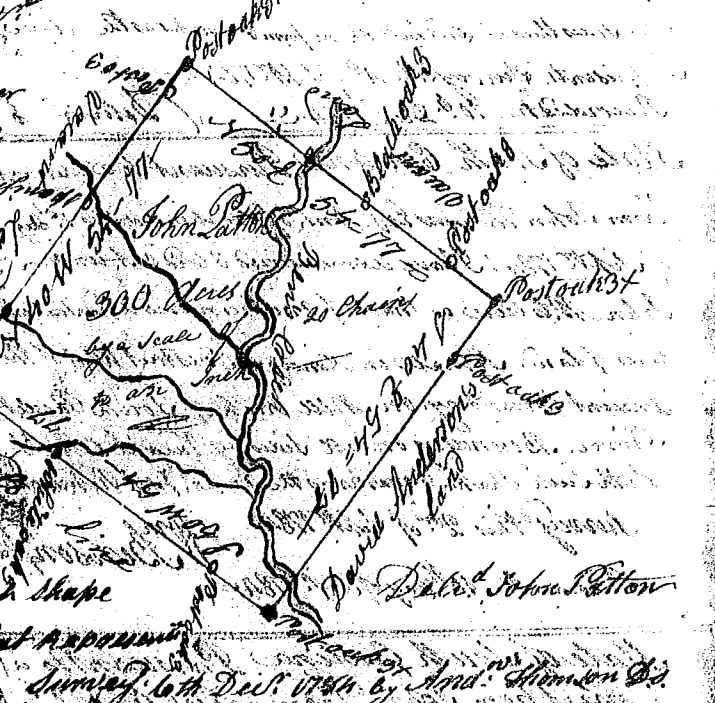

State of South Carolina - 96 District.
Pursuant to a warrant here Directed by John Thomas Esq. Commissioner of Locations for the District of the North side of Saluda River I have admeasured and laid out unto Francis Wheelers a tract of Land containing two hundred and forty acres, situated lying and being below the ancient Boundary line on both sides of Soldiers creek of Broad River bounded N. by an old Robinsons land, all other sides by Vacant Land, and hath such shape and marks as the above Plat Represents.

Surveyed the 29th Sept 1781.
Recorded the 10th December 1784.

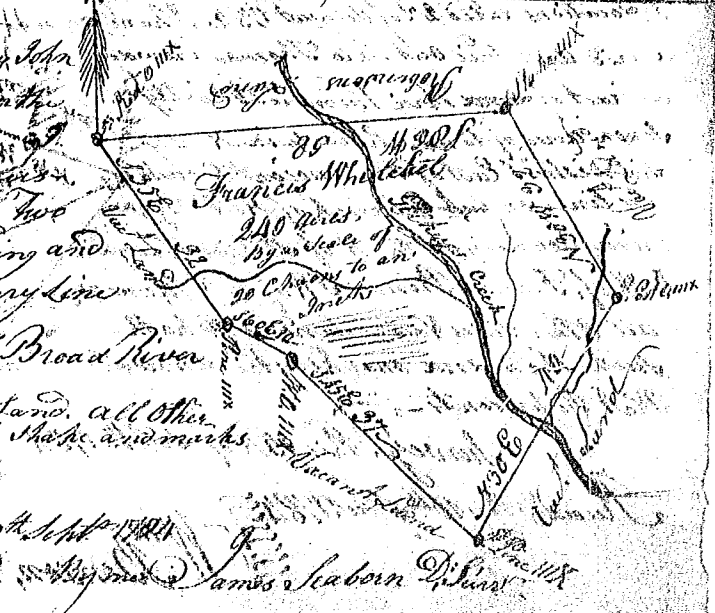

117
3