

State of Carolina
 Pursuant to a warrant from John
 Thomas Esq. Com. of Locations dated the
 15th day of Sept. 1784. I have
 measured & laid out unto
 David Caldwell a Tract of
 Land containing 255 Acres.
 Situate in the 9th District on the
 waters of Saluda River below
 the ancient boundary line bound-
 ing NW on land of Maj. Robert Gilmore & Henry
 Hazel SW on Wm. Hunter & John Caldwell's lands & on land of John
 Wallace, and hath such shape from & marks as the above plat represents
 Survey this 18th day of Nov. 1784 by South Downs Deane

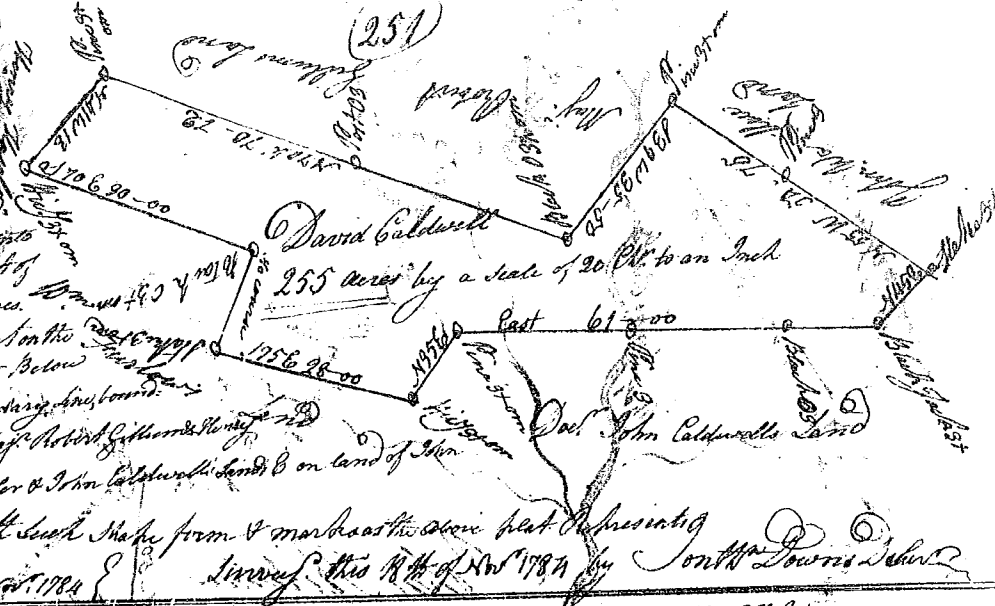

State of South Carolina
 Pursuant to a warrant from John
 Thomas Esq. Com. of Locations dated the
 30th day of November 1784. I have
 measured & laid out unto Geo. Prop
 a Tract of Land containing two hundred
 acres, situate in Ninety Six District West
 of the old boundary on both sides of Morgan's
 Creek of George Curry (Bounded) NW on land
 Morgan's land & Vacant Land SW on land laid out to
 Hays all other sides Vacant. & hath such form &
 marks as the above plat represents
 Survey this 15th day of Dec. 1784



State of South Carolina
 Pursuant to a warrant from John
 Thomas Esq. Com. of Locations dated the
 1st day of Dec. 1784. I have measured
 and laid out unto James Clark a Tract
 of Land containing four hundred acres
 situate in Ninety Six District East of
 the ancient boundary, on both
 sides of the North fork of Pickens
 Creek water of Broad River, Bounded
 Westwardly on land laid out to John
 Neal all other sides on Vacant Land
 and hath such form & marks as the
 above plat represents
 Survey this 6th day of Dec. 1784
 George Salmon Deane

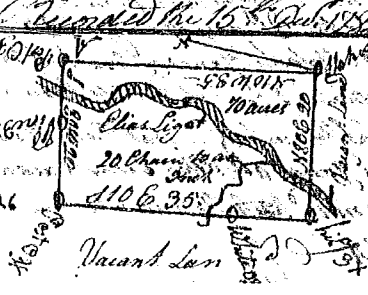

State of South Carolina. Pursuant to a warrant from John
 Thomas Esq. Com. of Locations dated the 17th day of Aug. 1784. I have measured and
 laid out unto Charles Esq. a Tract of Land containing 20 acres, situate
 in Ninety Six District East of the old boundary on both sides of
 creek of Broad River (Bounded) on all sides on Vacant Land
 and hath such form & marks as the above plat represents
 Survey this 13th day of Oct. 1784
 George Salmon Deane