

State of South Carolina Below the line
 Pursuant to a warrant from
 John Thomas Esq. Commissioner
 of Locations, I have admeasured
 and laid out unto Daniel Latham
 a Tract of two Hundred & Ninety six (296)
 Acre on the side of Enoree River, Boundary
 Westwardly on Daniel Latham Wm Woods & Vacant
 Land & Eastwardly on land laid out to Nathaniel Davis
 and Va ant Land the Other side on Enoree River
 And hath such Shape & marks as the annexed plat
 Represents Survey, the 9th Dec. 1784 By Glenn D
 Recorded the 8th January 1785. Return to Daniel Latham

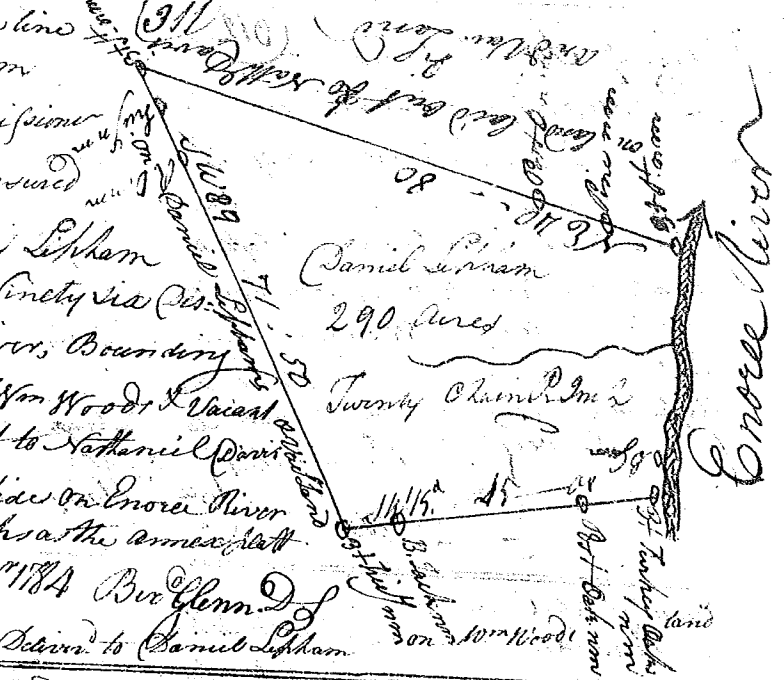

State of South Carolina
 Pursuant to a warrant from
 John Thomas Esq. Com-
 missioner of Locations, I have
 admeasured & laid out unto
 George Linam a Tract of six
 Hundred acres Situate in Ninety
 six District on the Waters
 of Tygar River, Boundary
 N.E. On land laid out to West
 Land, & hath such Shape and
 Marks as the annexed plat Repre-
 sents. Survey, 20 Oct. 1784
 P. Hopkins



State of South Carolina Ninety six District on the
 East side of the Ancient Boundary line
 Pursuant to a warrant from John Thomas Esq.
 Commissioner of Locations bearing date the 14th day of August
 1784. I have admeasured & laid out unto Frederick
 Crowder a Tract of land containing One Hundred &
 Fifty acres lying on the No side of Tygar River
 Boundary to the West by John Greer's land to the East
 by David Fairness' land & to the So by Tygar River
 all Other sides on Vacant Land. And hath such
 Shape & marks as the annexed plat Represents
 Survey September the 26th 1784



Recorded the 10th Jan'y 1785
 Andrew Thomson John Greer
 D S