

North Carolina

Pursuant to a warrant from John Thomas Esq. Commissioner of Locations in the 9th Dist. N.C. of Saluda. Dated the 16th July 1787. I have administered and laid out unto Graaf Sibels and Baaselman a tract of 1000 acres of Land. Situate in the district of Swamph Creek of Middle Tigger River and other branches of S. River and hath such iron marshes, burlings and bounding as the above plat represents.

Surveyed the 19th July 1787
 Recorded 6th Feb 1788

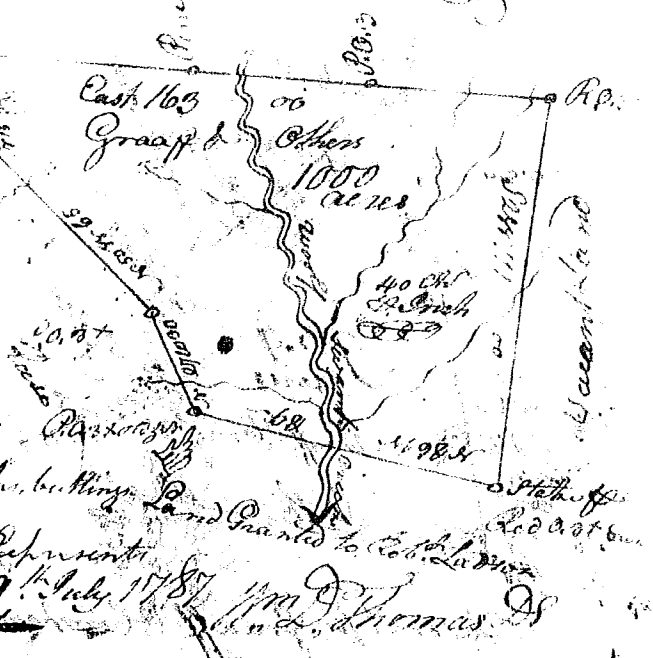

North Carolina Pursuant to a warrant from John Thomas Esq. Commissioner of Locations in the 9th Dist. N.C. of Saluda. (Dated the 16th July 1787) I have administered and laid out unto Graaf Sibels and Baaselman a tract of 1000 acres of Land. Situate in the district of Swamph Creek of Middle Tigger River. Bounding by the river S. & E. by land. Surveyed for Graaf Sibels and Baaselman and vacant land and hath such iron marshes as the above plat represents. Surveyed the 18th July 1787. Recorded the 6th day of Feb 1788.



North Carolina Pursuant to a warrant from John Thomas Esq. Commissioner of Locations in the 9th Dist. N.C. of Saluda. (Dated the 16th July 1787) I have administered and laid out unto Graaf Sibels and Baaselman a tract of 1000 acres of Land. Situate in the district of Swamph Creek of Middle Tigger River and other branches of S. River and hath such iron marshes, burlings and bounding as the above plat represents.

Surveyed the 18th July 1787
 Recorded 8th Feb 1788

