

State of Carolina Pursuant to a warrant,
 from John Thomas Esq. Court Clerk of
 the 96th District on the south side of Broad
 River on Morris's branch of a creek with
 such shape form & marks as the above
 great Represent. Shows the 29th July 1788

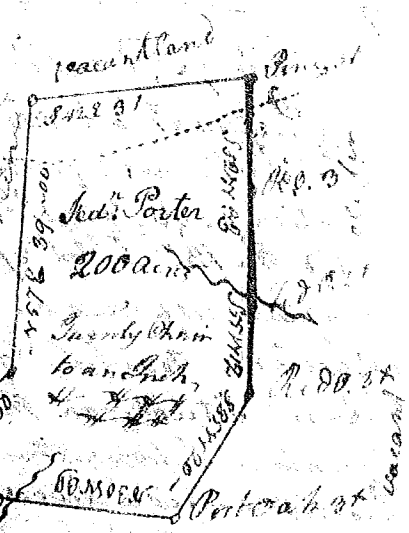

Charles Sims Esq. Surveyor

Recorded 15th Feb^y 1788

State South
 Carolina
 Pursuant to a
 warrant from
 John Thomas Esq.
 Court Clerk

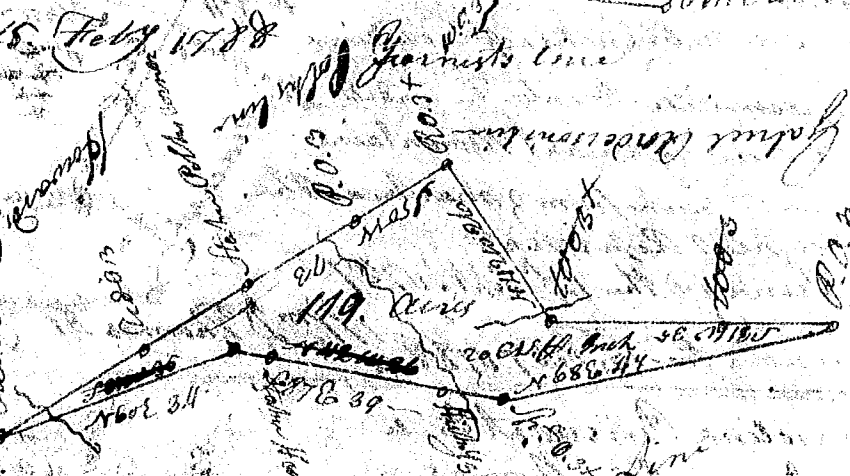

I have admeasured & laid out
 unto Jed's Porter a tract of 119 acres of land. Situated
 in the 96th District on the south side of Broad River on the
 Morris's branch of a creek with such shape form & marks as the above
 great Represent. Shows the 6th Feb^y 1788

Recorded 15th Feb^y 1788 Surveyed the 6th Feb^y 1788 Charles Sims Esq.
 Court Clerk

State of Carolina Pursuant to a warrant
 from John Thomas Esq. Court Clerk
 of the 96th District No. 10th District
 on the south side of Broad River
 I have admeasured & laid out unto
 Bayle's Earle Esq. a tract of 1000
 acres of land situated on Pagan
 creek branch of the head of Williams's
 creek of P. Tigar River in a part of
 the 96th District. Bounding by lines
 to the N. & E. by Abner Denton's land
 all other sides vacant & land unknown
 and both such form & marks as the above
 great Represent. Shows the 18th Jan^y 1788

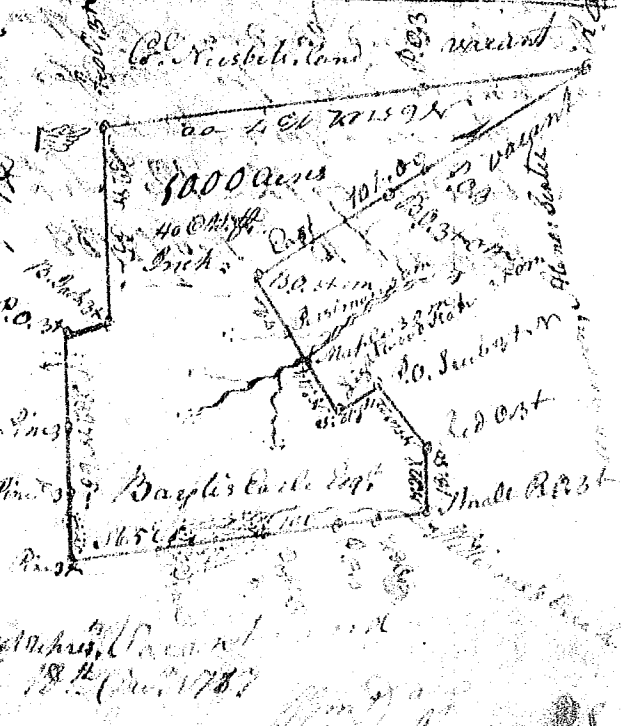

Recorded 15th Feb^y 1788 Surveyed the 18th Jan^y 1788 Charles Sims Esq.
 Court Clerk