

Carolina Pursuant to a warrant
 from John Thomas Esq. C. in Washington
 District dated the 24th Aug. 1793
 I have administered & laid out
 a tract of land in said District
 containing One Thousand acres lying on a
 branch of Saluda River Greene
 County & hath such shapes marks & boundaries
 as the above plat represents
 Done the 30th Aug. 1793
 Thomas Esq. C. in Wash. Dist.

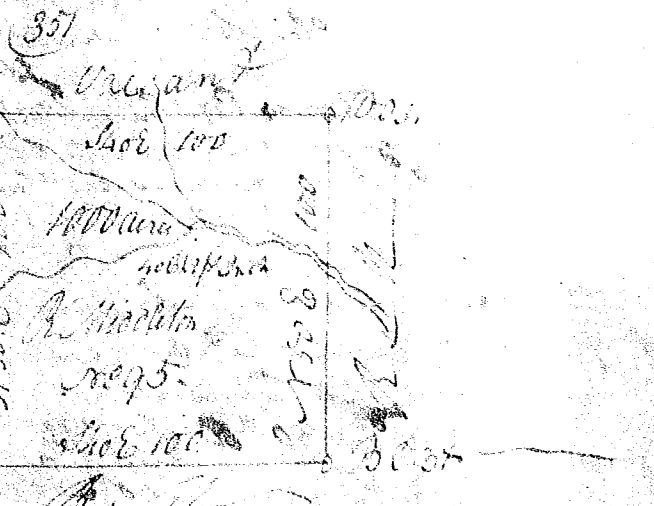

Recorded the 15th Dec. 1794
 Carolina Pursuant to a warrant
 from John Thomas Esq. C. in Washington
 District dated the 24th Aug. 1793 I have
 administered & laid out into
 Middleton a tract of land in said District
 containing One Thousand acres lying on
 a branch of Saluda River Greenville
 County & hath such shapes marks & boundaries
 as the above plat represents
 Done the 30th Aug. 1793
 Thomas Esq. C. in Wash. Dist.

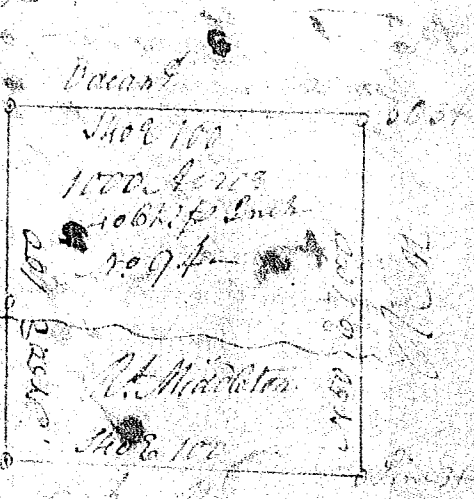

Carolina Pursuant to a warrant
 from John Thomas Esq. C. in Washington
 District dated the 24th Aug. 1793 I have
 administered & laid out into
 Middleton a tract of land in said District
 containing One Thousand acres on
 a branch of Saluda River Greenville
 County & hath such shapes marks & boundaries
 as the above plat represents
 Done the 30th Aug. 1793
 Thomas Esq. C. in Wash. Dist.

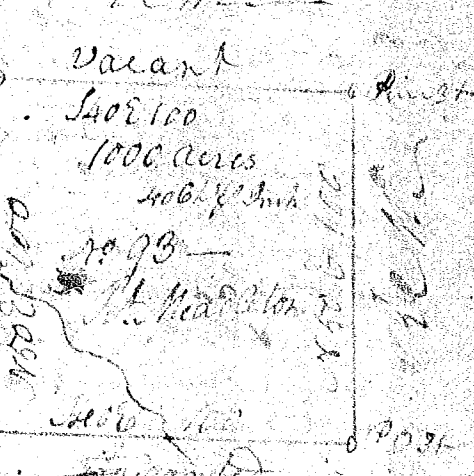

Carolina Pursuant to a warrant
 from John Thomas Esq. C. in Wash-
 ington District dated the 24th Aug. 1793
 I have administered & laid out into
 Middleton a tract of land in said District
 containing One Thousand acres lying on
 a branch of Saluda Greenville County
 & hath such shapes marks & boundaries
 as the above plat represents
 Done the 30th Aug. 1793
 Thomas Esq. C. in Wash. Dist.

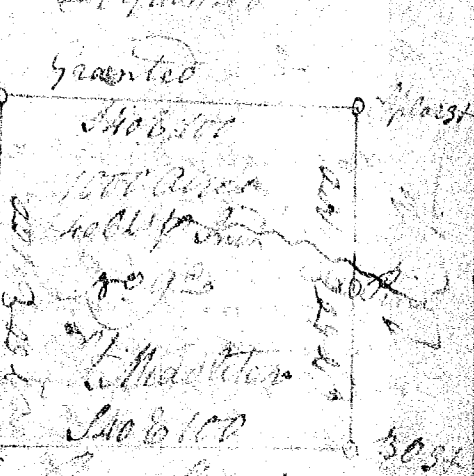

Recorded the 15th Dec. 1794