

State of South Carolina

Pursuant to a warrant from John Thomas Esq. Commissioner of Locations in Ninety Six District, No Saluda River, I have admeasured and laid out unto Charles Kelly a tract of Land containing one Hundred acres on the North side Eagle River, below the Indian Boundary, bounding N.W. by Dikes N.E. by Land held by John Bush, all other sides on vacant Land, and hath such Shape and Marks as the above Plat Represents

Survey, 27 Nov 1784 by Robert Hanna Esq.
 D.D. Charles Kelly
 Recorded 7 febr. 1785



State of South Carolina

Pursuant to a warrant from John Thomas Esq. Commissioner of Locations in Ninety Six District, No Saluda River, I have admeasured and laid out unto William Price a tract of Land containing two hundred and Sixty acres on the branches of Cumans Creek below the Indian Boundary, bounding E on Land laid out to Patrick Lunningham, S.E. on Land laid out to Patrick Bryan & 2 on Land laid out the owners names unknown, all other sides on Vacant Land, and hath such Shape and Marks as the above Plat Represents,

Survey, 10th day of December 1784. by Robert Hanna Esq.
 Recorded 8 febr. 1785,

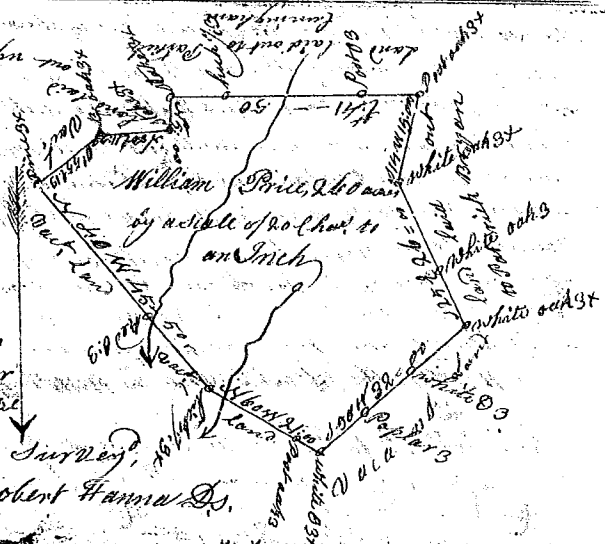

State of South Carolina Pursuant to a warrant from John Thomas Esq. Commissioner of Locations, in Ninety Six District No Saluda River, I have admeasured and laid out unto John Lindsay a tract of Land containing Two hundred and Nine acres on King's Creek, below the Indian Boundary, bounded N.W. on Samuel Lindsay's Land S.W. Part on William Willsons & Part on Gabriel Anderson's Land S.E. on Samuel Clowney's and Part on Francis Strother's Land, N.E. on William Hamilton Land and hath such Shape and Marks as the above Plat Represents

Survey, 18 Nov 1784 by Robert Hanna Esq.
 Recorded 8th febr. 1785,

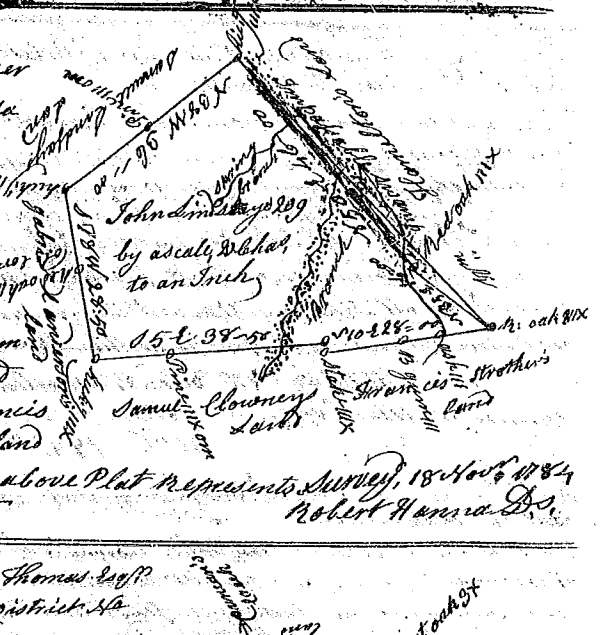

State of South Carolina

Pursuant to a warrant from John Thomas Esq. Commissioner of Locations in Ninety Six District No Saluda River, I have admeasured and laid out unto John Brown a tract of Land containing Eighty acres on Duncans Creek, below the Indian Boundary, bounding N.W. on Land laid out to Boling Bishop, S.W. on John Brown's Land, all other sides on Vacant Land, and hath such Shape and Marks as the annexed Plat Represents

Survey, 13th Dec 1784 by Robert Hanna Esq.
 Recd. 8th febr. 1785



State of South Carolina Pursuant to a warrant from John Thomas Commissioner of Locations in Ninety Six District No Saluda River I have admeasured and laid out unto Roger Brown a tract of Land containing one hundred acres on Cumans Creek, below the Indian boundary, and hath such Shape and Marks as the annexed Plat Represents

Survey, 5th Nov 1784 by Robert Hanna Esq.
 Recorded 9th febr. 1785,

