

State of S. Carolina Pursuant to a warrant from John Thomas Esq. Commissioner of Locations dated 20th day of August 1784, I have admeasured and laid out unto Atke Necks a tract of Land containing 186 acres situate in Ninety six district on the side below the ancient boundary line, bounded N on Samuel Weaver's land, and hath such shape and marks as the annexed Plat represents.

Survey'd the 11th Nov. 1784 by Jonathan Downs D.S.

Recorded 14th Feb. 1785

Atke Necks

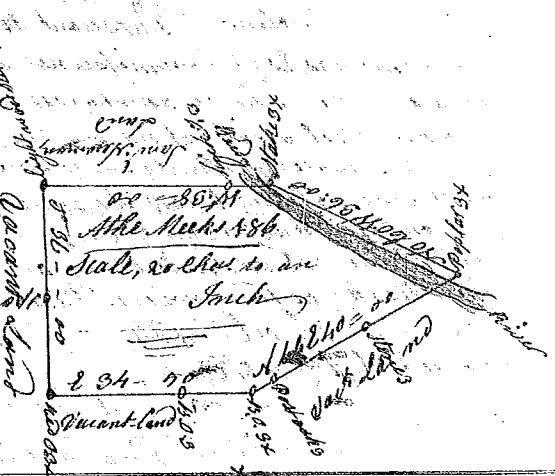

State of South Carolina Pursuant to a warrant from John Thomas Esq. Commissioner for ninety six district No. Saluda dated 9th Nov. 1784, I have admeasured and laid out unto John Lewis a tract of one hundred acres of land situate in Ninety six district on the side Saluda river below the ancient boundary on waters of big Saluda, bounded S.E. by James Charlows land, N.E. by Richard Lewis's land, N.W. by John James's land, S.W. by Arnolds land and hath such shape and marks as the above Plat represents.

Survey'd the 11th Nov. 1784 by P. Waters D.S.

Recorded the 14th Feb. 1785

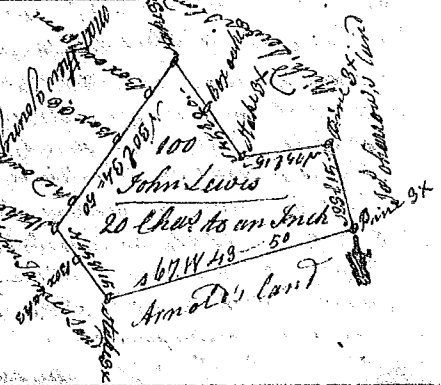

State of South Carolina Ninety six District below the ancient boundary Pursuant to a warrant from John Thomas Esq. Commissioner of Locations dated 18th Nov. 1784, I have admeasured and laid out unto Wallace Jones a tract of Land containing one hundred and fifty acres, lying on the waters of Bush River, bounded S.W. & N.W. by Col. Phil. Waters land, N.E. by Charles Perkins's land, S.E. by vacant land, S.W. by Jones land, and hath such shape and marks as the annexed Plat represents.

Survey'd the 11th Nov. 1784 by P. Waters D.S.

Recorded 14th Nov. 1785

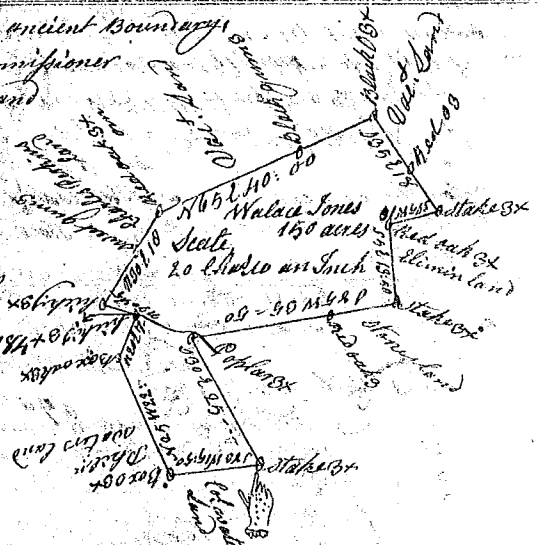

State of South Carolina Pursuant to a warrant from John Thomas Esq. Commissioner of Locations for ninety six district No. Saluda river dated 31st day Aug. 1784, I have admeasured and laid out unto Andrew Thomas a tract of two hundred acres of land, situate in ninety six district on the N. side Saluda river below the ancient boundary on the waters of Broad river, bounded S.W. on William Housel's land, S.E. on Christian Hopes land, N.E. & N.W. by Andrew Tomes land, and hath such shape & marks as the annexed Plat represents.

Survey'd the 21st Nov. 1784 by Phil. Waters D.S.

Recorded 14th Feb. 1785



State of S. Carolina Pursuant to a warrant from John Thomas Esq. Commissioner of Locations for ninety six district No. of Saluda river dated 2nd day of Sept. 1784, I have admeasured and laid out unto Peter Stockman a tract of seventy acres of land situate in Ninety six district No. of Saluda river below the ancient boundary on Thomas's Creek waters of Broad river bounded S.E. by Peter Stockman's land, S.W. by Peter's land laid out S.W. by P. Hopes's land, all other sides by vacant land, & hath such shape & marks as the annexed Plat represents.

Survey'd the 29th Nov. 1784

Recorded the 14th Feb. 1785

by P. Waters D.S.

