

State of South Carolina Pursuant to a warrant from John Thomas Commissioner of Locations dated the 17th Nov<sup>r</sup> 1784, I have admeasured and laid out unto Tepe Kobby a tract of Land containing four hundred acres situate in the 6th district on the waters of the River, bounded N on Samuel Poling's land E on land laid out in Anderson, S on land laid out, and all other sides on vacant land and hath such shape and Marks as the above Plat represents, Surveyed 14th Dec<sup>r</sup> 1784 by John M. Downs, Recorded 25th Febr<sup>y</sup> 1785

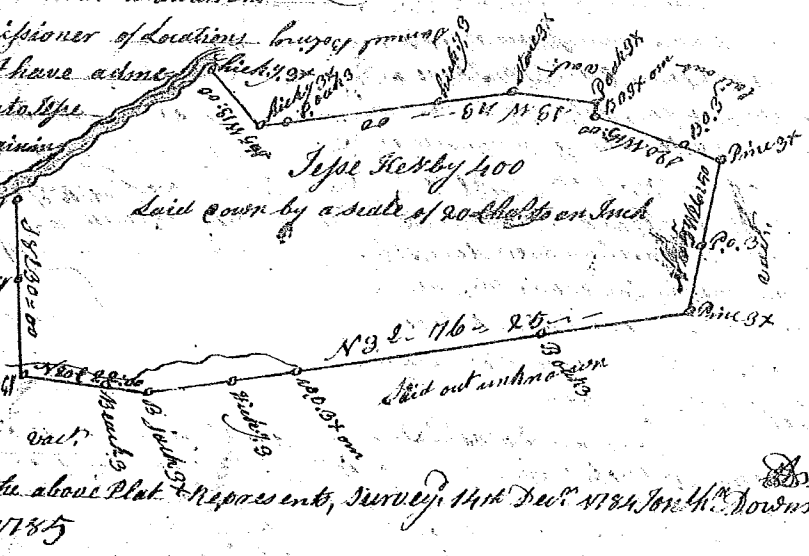

State of S<sup>c</sup> Carolina Pursuant to a warrant from John Thomas Esq<sup>r</sup> Commissioner of Locations dated the 29th Sept<sup>r</sup> 1784, I have admeasured and laid out unto Martin Martin a tract of Land containing one hundred and fifty acres situate on a branch of Little River below the ancient boundary line bounded N on land laid out NW on James Young's land, SE on land laid out, SE by Michael McKeen's and James McKeen's land, and hath such shape and Marks as the above Plat represents, Surveyed 11th Oct<sup>r</sup> 1784, Recorded 26th Febr<sup>y</sup> 1785



State of S<sup>c</sup> Carolina Pursuant to a warrant from John Thomas Esq<sup>r</sup> Commissioner of Locations dated the 24th Sept<sup>r</sup> 1784, I have admeasured and laid out unto Martin Martin a tract of Land containing one hundred and eighty acres situate in the 6th district on a branch of Little River called Martins Branch below the ancient boundary line bounded N on Shadrach Martins Land W on land laid out to John McKeen S by the widow Craddock & Mich<sup>l</sup> Currier Land, and hath such shape and Marks as the annexed Plat represents, Surveyed 4th Oct<sup>r</sup> 1784, Recorded the 26th Febr<sup>y</sup> 1785

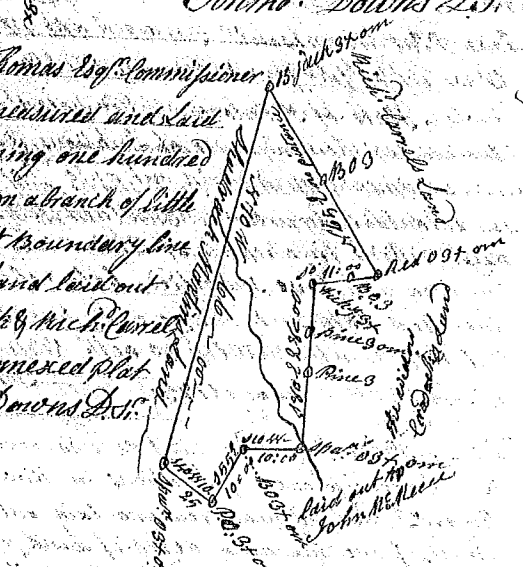

State of S<sup>c</sup> Carolina Pursuant to a warrant from John Thomas Commissioner of Locations dated the 5th day Nov<sup>r</sup> 1784, I have admeasured and laid out unto Abijah Oneal a tract of Land containing one hundred and fifty acres situate in the 6th district on the waters of Middle River below the ancient Indian line bounding SW on land of John Caldwell Mich<sup>l</sup> Garrison and on Little River's Land NW on land of James Barron's and William Heals, and hath such shape and Marks as the above Plat represents, Surveyed the 15th Dec<sup>r</sup> 1784, Recorded the 25th Febr<sup>y</sup> 1785

