

State of S. Carolina. Pursuant to a warrant from John Thomas Esq. Commissioner of Locations Dated the 13<sup>th</sup> Nov. 1784. I have admeasured & laid out unto Nicolas Darnal a Tract of Three Hundred & four acres of Land Situate in Ninety six District West of the Old Boundary on the branches of Koopers Creek, Branches of Armstrongs Creek & a Branch of Reedy River. Bounding to the SE on land laid out to Chas. Denson NW. to Job. Bridges NE to Joseph Duncombs all other sides vacant & hath such shape & marks as the annexed plat Represents. Surveyed this 22<sup>nd</sup> Nov. 1784 by W<sup>m</sup> Benson Esq. Recorded the 9<sup>th</sup> March 1785

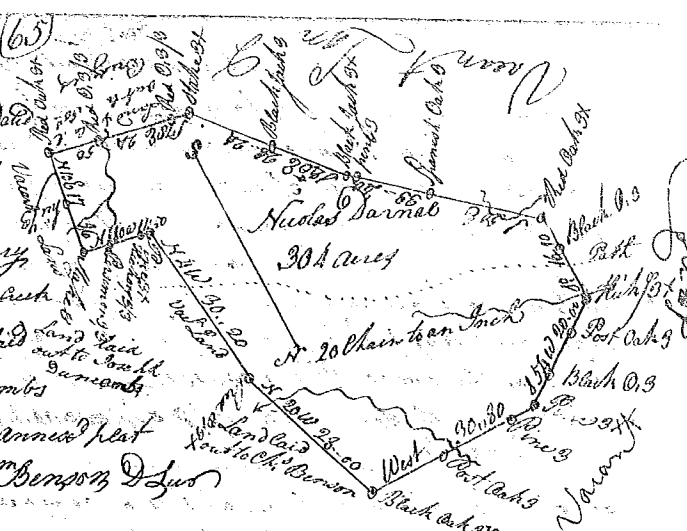

State of South Carolina. Pursuant to a warrant from John Thomas Esq. Comr. of Locations in Ninety six District N. of Savena River. I have admeasured & laid out unto Joseph Thompson a Tract of Land containing one Hundred & fifty acres on Enoree River below the Indian Boundary, bounding sb. on land claimed by John Garret & c on land laid out to James Mahon and on all other sides vacant & hath such shape & marks as the annexed plat Represents. Surveyed the 30<sup>th</sup> Dec. 1784 by Robert Hanna Esq. Recorded the 7<sup>th</sup> March 1785 Del. to David Neil



South Carolina. Pursuant to a Warrant from John Thomas Esq. Commissioner of Locations Dated the 13<sup>th</sup> Dec 1784 I have admeasured & laid out unto Robert Cooper a Tract containing 240 Acres of Land Situate in Ninety six District on Norths creek of Little River below the ancient Boundary, Bounded NW on the ~~land of~~ Rob. Cooper & Hugh Youngs land NW on Thomas Blakelys land SE on James Dandys land NE on Thos. Cargils land & hath such shape & marks as the annexed plat Represents. Surveyed this 18 Dec. 1784. North Downs Esq. Recorded the 7<sup>th</sup> March 1785 Del. to Rob. Cooper

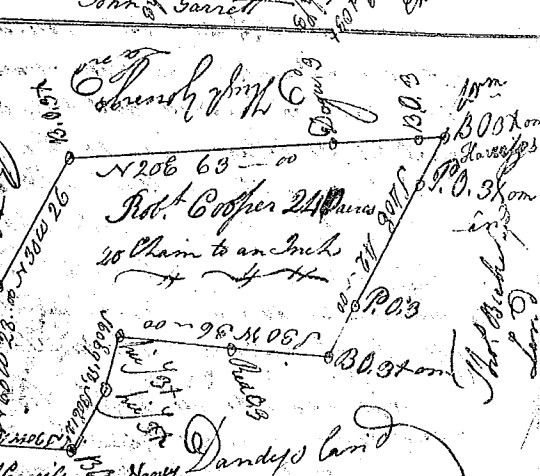

State of South Carolina. Pursuant to a warrant from John Thomas Esq. Commissioner of Locations dated the 30<sup>th</sup> day of December 1784. I have admeasured & laid out unto John Farmer a Tract of one Hundred and Three acres of Land. Situate in Ninety six District East of the ancient Boundary on the South Fork of Sycan River. Bounding to the SE on the R. River, all other sides vacant & hath such shape & marks as the annexed plat Represents. Surveyed this 30<sup>th</sup> Dec. 1784. By W<sup>m</sup> Benson Esq. Recorded the 9<sup>th</sup> March 1785

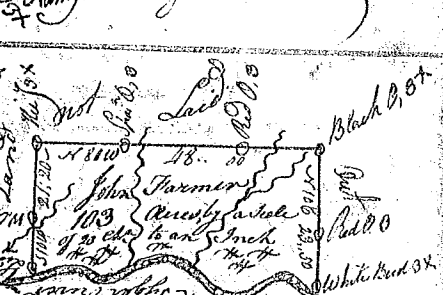

State of S. Carolina. Pursuant to a warrant from John Thomas Esq. Commissioner of Locations dated the 3<sup>rd</sup> day of Oct. 1784. I have admeasured & laid out unto William King a Tract of sixty acres of Land Situate in Ninety six District West of the ancient Boundary on the Glafus Mountain and a Branch of the South fork of Roald River. Bounding Vacant on all sides on Vacant Land. - - and hath such shape & marks as the annexed plat Represents. Surveyed this 11<sup>th</sup> November 1784 by W<sup>m</sup> Benson Esq. Recorded the 9<sup>th</sup> March 1785

