

State of South Carolina, Pursuant to a (73)
 Warrant from John Thomas Esq. Commissioner of Locations
 in 96 District N^o. Saluda River, I have admeasured & laid
 out unto Robert Scott a Tract of Land containing one
 Hundred & Thirty acres, on Allison's Branch of Sumner's
 Creek below the Indian Boundary, bounding S.E. on
 land laid out to Thomas Allison S.E. N.W. and W on land
 laid out to William Sumner, all other sides vacant Land
 & hath such Shape & marks as the annexed plat Represents
 Survey the 6th July 1785. By Robert Joanna Surveyor
 Recorded the 21st March 1785

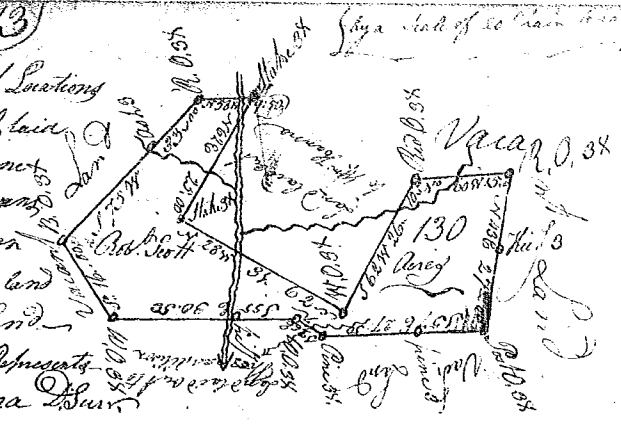

State of South Carolina
 Pursuant to a warrant from John
 Thomas Commissioner of Locations in
 in Ninety six District N^o. Saluda River
 I have admeasured & laid out unto Samuel
 Thomson a Tract of Land containing Three
 Hundred & Eighty four acres on the N^o Side
 of Enoree River, Below the Indian Boundary
 bounding S.E. on said Enoree River & land laid
 out to Castriage N.E. part on Patrick Hinds &
 part on William Slaughters land S.W. on W^o
 Stambeys land N.E. S.E. & N.W. on Benjⁿ Wofford's
 Land & all other sides on vacant Land & hath such
 Shape & marks as the annexed plat Represents
 Survey the 19th Dec^r 1784 By Robert Joanna Surveyor
 Recorded the 21st March 1785

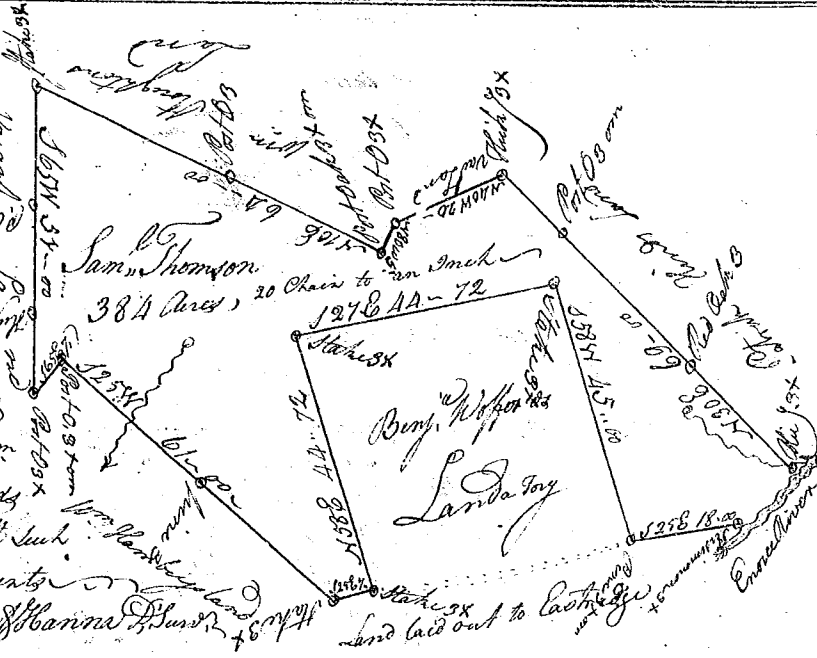

State of South Carolina Pursuant to a war-
 rant from John Thomas Esq. Com^r of Locations
 dated the 22nd of January 1785, I have admeasured
 and laid out unto Dennis Duff a Tract of
 Land in 96 District containing 158 acres
 West of the ancient boundary, on Checheson
 River of Saluda, bounding to the N.E. on land laid
 out to W^o Cornelius S.E. & S.W. to James McHenry's S.E. to John
 Motlow & all other sides vacant. & hath such Shape & marks as the above plat Represents
 Survey the 7th day of July 1785 by W^o M^o M^o Surveyor
 Recorded the 21st March 1785



State of S. Carolina Pursuant to a
 Warrant from John Thomas Esq. Com^r
 of Locations dated the 27th Dec^r 1784, I have
 admeasured & laid out unto Ephraim Elly
 a Tract of Land containing Three Hun-
 dred & Fifty acres Situate in 96 Dist^{ct}
 West of the ancient Boundary on both
 sides of Elly's fork of the Middle fork of
 Saluda River bounding on all sides
 on vac^t Land, & hath such Shape and
 marks as the annexed plat Represents
 Survey the 28th Dec^r 1784
 by George Salmon S^r LAND
 Recorded the 21st March 1785

