

Pursuant to a warrant from John Thomas Esq. Commissioner of Locations. I have caused to be admeasured and laid out unto James Dougharty one hundred and thirty ^{30 acres} of land situate ninety six district on the waters of Canons Creek, bounding S. & S.W. on John Thomas land & S.E. on Peter Hains land and all other sides on land laid out, and hath such shape and Marks as the above Plat Represents. Surveyed the 10th Dec. 1784. and recorded the 14th April 1785.

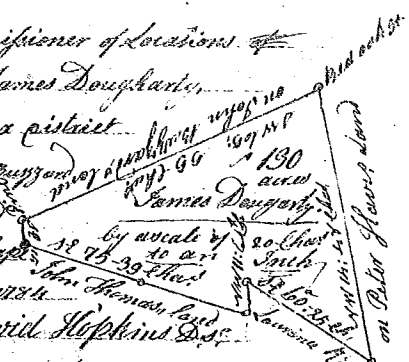

Pursuant to a warrant from John Thomas Esq. Commissioner of Location, I have caused to be admeasured and laid out unto James Dougharty a tract of sixty three acres of land situate in ninety six district, on the waters second creek bounding S.W. on J. Dougharty's land S.W. on George Agnes land & William Suggart land and S.E. on George Lacey's land and hath such shape and Marks as the above Plat Represents. Surveyed the 10th Dec. 1784. and recorded the 14th April 1785.

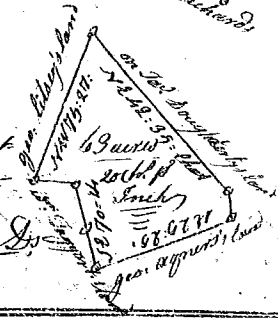

Believ: Thomas Jenkins both the above David Hopkins D.S.

State South Carolina Pursuant to a warrant from John Thomas Commissioner of Locations, I have admeasured and laid out unto Daniel M. Claren a tract of land on the south side of Bonaventure River, containing two hundred & eighty acres. Bounding S.E. on R. River and on lands granted to Persons unknown and said M. Claren, S.W. on Samuel Sarat S.W. & S.E. on vacant Land having such form and Marks as the annexed Plat Represents, Surveyed the 5th Feb. 1785. and recorded the 14th April 1785.



State of South Carolina 96 district East of the boundary line Pursuant to a warrant from John Thomas Esq. Commissioner of Locations dated 9th March 1785. I have admeasured and laid out unto John Foster a tract of Land containing three Hundred and fifty two acres lying on the South side of Spring Creek on both sides of the whet stone branch bounded S.E. by Henry Foster's land W. by John Thomas Esq.'s land S.W. by said John Thomas Esq.'s land S.E. by George Story's land, and hath such shape and Marks as the above Plat Represents. Surveyed the 15th day of March 1785. and recorded the 14th April 1785.

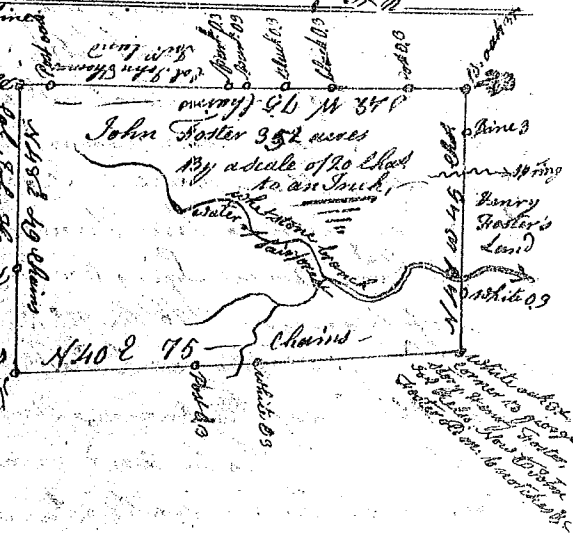

And: Thomson D.S.