

South Carolina / below the ancient boundary

Pursuant to a warrant from John Thomas
 Commissioner of Locations of 96 District
 dated the 9th March 1785, I have laid out
 unto Lewelin Threewits a tract of Land
 containing 396 acres, situate on the south
 side of Broad River, NW side of Land laid
 out to James Thomas, on William Trumels
 Lands and on the widow Wrights Land, and
 has such shape and Marks as the above
 Plat represents, Surveyed 24th March 1785
 by J. W. Winn D.S.

Recorded 28 March 1785

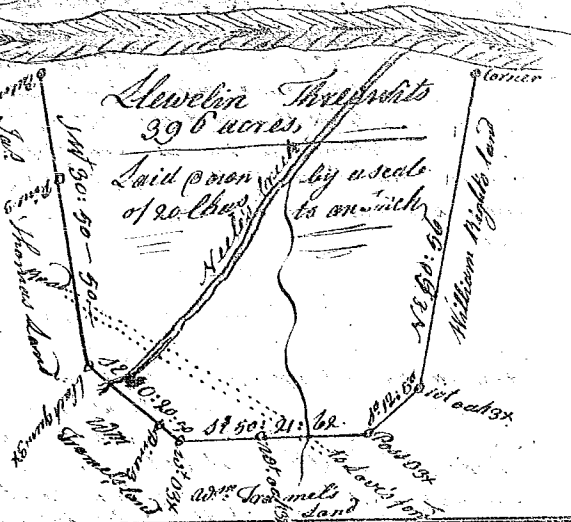

State of S^c Carolina

Pursuant to a warrant from
 John Thomas Esq. Commissioner
 of Locations dated 12th febr^y 1785
 I have admeasured and laid
 out unto Thomas Kivell a
 Tract of four hundred and forty
 acres of Land, situate in the
 Six District East of the ancient
 boundary on Broad River, bounding
 to the NE & NW on Land laid out
 to Benjⁿ Kivell, SE to John House's &
 by the various courses of said River
 all other sides on vacant Land, and
 hath such shape and Marks as the above
 Plat represents, Surveyed 15th febr^y 1785
 W^m Benson D.S.
 Recorded the 21 day of April 1785

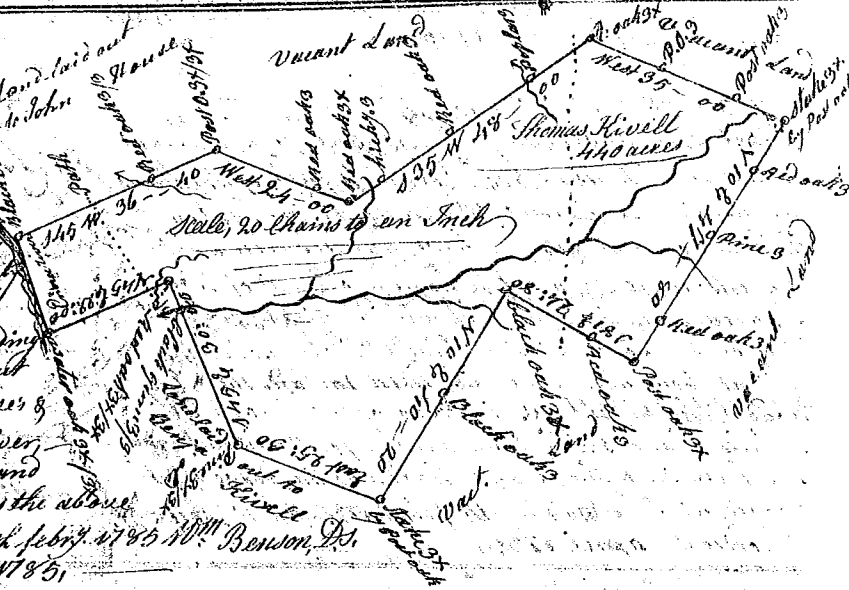

State of S^c Carolina

Pursuant to a warrant from
 John Thomas Esq. Com^r of Locations, Dated the 28th of
 Jan^y 1785, I have admeasured & laid out unto James
 Leah a Tract of one hundred & thirteen acres of Land
 Situate in the Sixth District East of the ancient boundary on
 Creek of Horse River, bounding to the S.E. on Land laid out
 to Joseph Branchfield, all other sides Vac^t. It hath such shape and
 Marks as the above Plat represents
 Surveyed this 16th Feb^r 1785 by W^m Benson D.S.
 Recorded the 25th April 1785

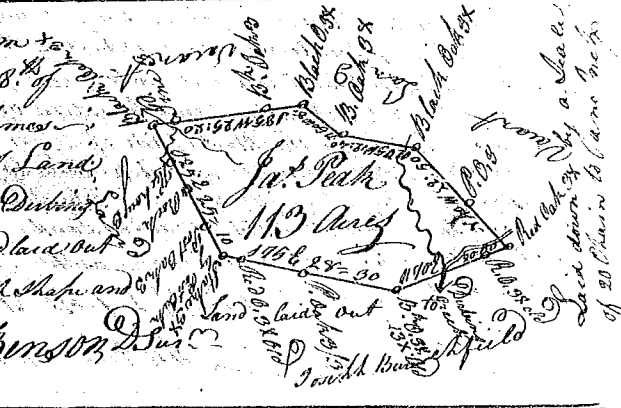

State of S^c Carolina

Pursuant to a warrant
 from John Thomas Esq. Commissioner of Locations
 dated the 10th Jan^y 1785, I have admeasured and
 laid out unto William Goodlett a tract of
 Land containing two hundred and sixty acres
 situate in Ninety six District East of the an-
 cient boundary, on the branches of the North
 fork of Tygar River, bounding to the NE on
 Land unknown &c on Bishop's and on all
 other sides on vacant Land, and hath such
 shape and Marks as the above Plat represents
 Surveyed the 10th day Jan^y 1785,
 W^m Benson D.S.

Recorded the 21 April 1785, W^m Benson D.S.

