

State of S^c Carolina 96 District East of the old line
 Pursuant to a warrant from John Thomas Esq^r Commissioner of Locations dated February 25-1785
 I have admeasured and laid out unto Jacob League a tract of Land containing Three Hundred acres situate lying and being on the South side of Enoree River bound East N^o and S^o by Mary's land Thomas Civil's land W by land laid out for Mary Austin, all other sides Old lines and Vacant Land, and hath such shape and marks as the above Plat represents, Survey: 24th March 1785
 Recorded 2^d May 1785. And^o Thomson D^s

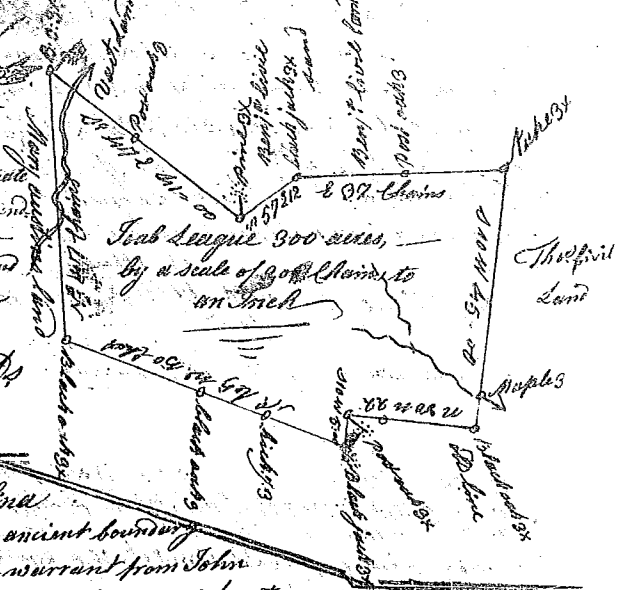

State of S^c Carolina 96 District East of the ancient boundary
 Pursuant to a warrant from John Thomas Esq^r Commissioner of Locations dated the 26th day of February 1785.
 I have admeasured and laid out unto Edmond Ellis a tract of Land containing Three hundred acres, situate lying and being on the North side of Pacolet River, bound W by John Kerkonel's land, all other sides Vacant Land, and hath such shape and marks as the above Plat represents, Survey: the 17th March 1785, And^o Thomson D^s Recorded 3^d May 1785.

admeasured and laid out unto Nathaniel Perry a tract of Three hundred and ninety eight acres of Land situate in Ninety six District West of the ancient Boundary on North fork of Enoree River bounding on all sides on Vacant Land and hath such shape and marks as the above annexed Plat represents, Survey: the 14th day of April 1785, by W^m Benson D^s recorded the 3^d day of May 1785.

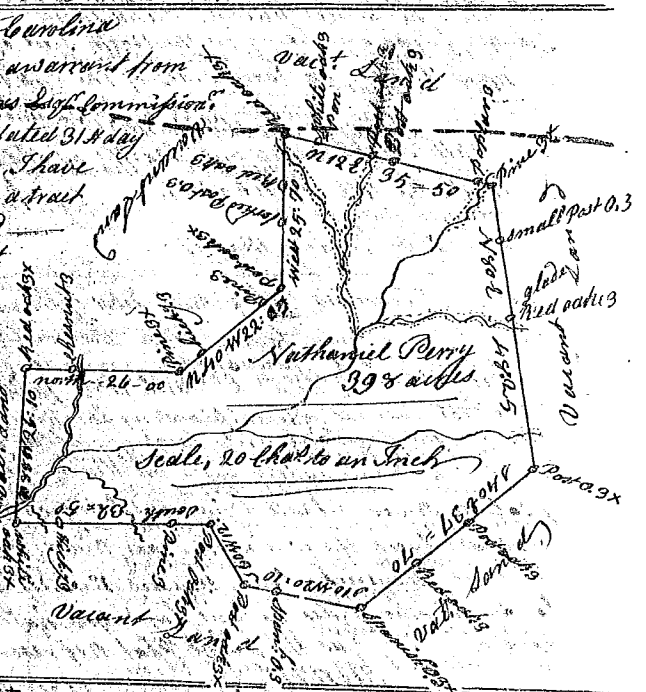

State of S^c Carolina, Pursuant to a warrant from John Thomas Esq^r Commissioner of Locations dated 30th day of March 1785, I have admeasured and laid out unto Nathaniel Perry a tract of two hundred & forty acres of Land, situate in Ninety six District West of the ancient boundary, on Enoree River bounding NW by N^o, on land laid out for Robert Prince, all other sides on Vacant Land and hath such shape and marks as the above annexed Plat represents, Survey: the 4th day of April 1785, by W^m Benson D^s Recorded 3^d May 1785.

