

State of S<sup>c</sup> Carolina 96 District East of the ancient boundary line, (113)

Pursuant to a warrant from John Thomas Esq<sup>r</sup> Commissioner of Locations dated the 14th day of March 1785, I have admeasured and laid out unto

Fredrick Eisen a tract of Land containing two hundred and thirty eight acres of Land lying on the South side of Fall forest, bounded N by Rich<sup>d</sup> Hampton's Land NE by John Smith's Land, all other sides vacant Land, and hath such shape and Marks as the above Plat represents, Survey<sup>d</sup> the 14th April 1785.

Recorded 13th May 1785

by Anselm<sup>o</sup> Thomson D<sup>s</sup>

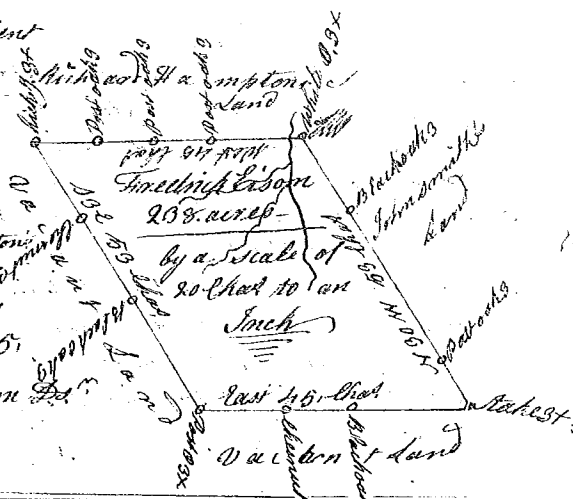

State of S<sup>c</sup> Carolina 96 District East side of the ancient Boundary line,

Pursuant to a warrant from John Thomas Esq<sup>r</sup> Commissioner of Locations the 14th day of March 1784, I have admeasured and laid out unto Fredrick Eisen a tract of Land containing one Hundred and forty nine acres lying on a small branch of Wood-Creek waters of Tugar River, bounded NW by Daniel Stephens Land, all other sides vacant Land, and hath such shape and Marks as the above Plat represents, Survey<sup>d</sup> the 14th April 1785

Recorded 13th May 1785

by Anselm<sup>o</sup> Thomson D<sup>s</sup>

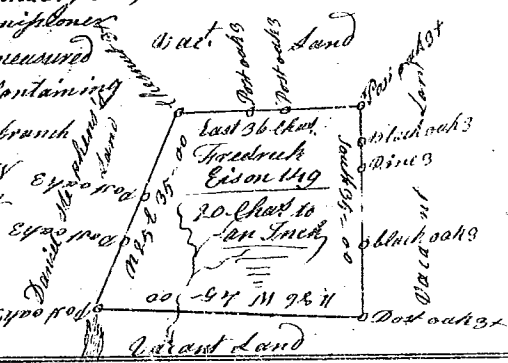

State of S<sup>c</sup> Carolina 96 District W<sup>t</sup> of the old Boundary line

Pursuant to a warrant from John Thomas Esq<sup>r</sup> Commissioner of Locations dated the 18 febr<sup>y</sup> 1785, I have admeasured and laid out unto

John Beck a tract of Land containing five Hundred acres situate lying and being on the small branches of Musk-Creek waters of Tugar River bounded S<sup>o</sup> & E<sup>o</sup> by Ether Thomas's Land, all other sides vacant Lands, and hath such shape and Marks as the above Plat represents, Survey<sup>d</sup> the 28 febr<sup>y</sup> 1785

Recorded 13th May 1785

by Anselm<sup>o</sup> Thomson D<sup>s</sup>

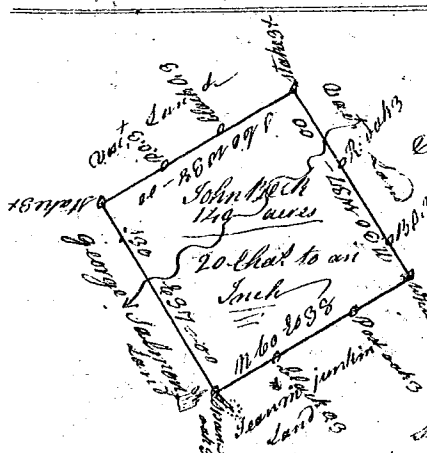
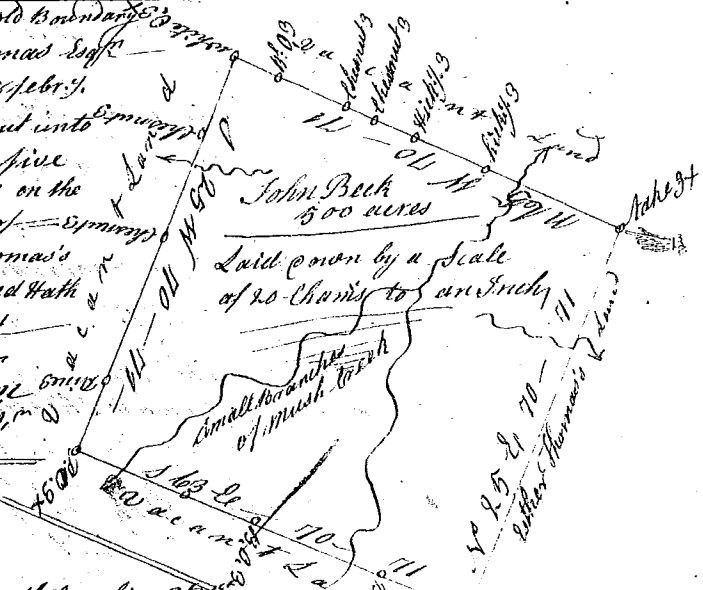

State of South Carolina 96 District East of the old boundary line

Pursuant to a warrant from John Thomas Esq<sup>r</sup> Commissioner of Locations dated the 18th day of February 1785, I have admeasured and laid out unto John Beck a tract of Land containing one hundred and forty acres, lying on both sides of Peter's branch waters of Saluda River bounded S.W. by George Salmon's Land, S.E. by Land laid out for Sean M. Junkin, all other sides vacant Land, and hath such shape and Marks as the above Plat represents, Survey<sup>d</sup> the 28th febr<sup>y</sup> 1785

Recorded the 13th May 1785

by Anselm<sup>o</sup> Thomson D<sup>s</sup>