

State of S<sup>c</sup> Carolina 9<sup>th</sup> district East of the old Boundary.

Pursuant to a warrant from John Thomas Commissioner of Locations dated the 4<sup>th</sup> Nov<sup>r</sup> 1784 I have admeasured and laid out unto William Grant Esq. a tract of land containing one Hundred acres, on the Middle fork of Brown's Creek, a branch of Broad River, bounded on all sides by Vacant Land, and hath such shape and Marks as the above Plat represents, Survey<sup>d</sup> the 10 Nov<sup>r</sup> 1784, by Andrew Thomson Esq.

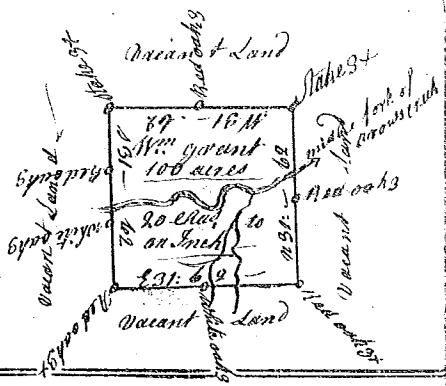

State of S<sup>c</sup> Carolina 9<sup>th</sup> district East of the old Boundary line

Pursuant to a warrant from John Thomas Commissioner of Locations dated 23 March 1785, I have admeasured and laid out unto William Spillers a tract of Land containing Eighty six acres, on Two mile Creek a branch of Enoree River bounded S<sup>e</sup> by Benjamin Robuch's land, w<sup>e</sup> by, by Edw. Nash's land N<sup>e</sup> by Joseph Barnett's land, and hath such shape and Marks as the above Plat represents, Survey<sup>d</sup> 30 March 1785, Recorded 17<sup>th</sup> May 1785, by Andrew Thomson Esq.

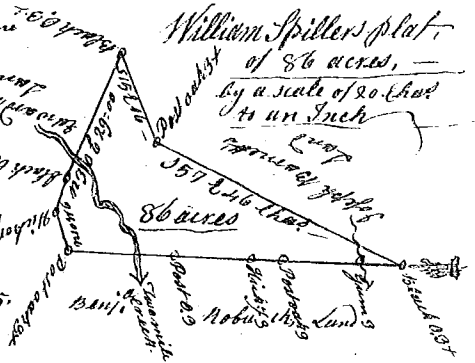

State of S<sup>c</sup> Carolina 9<sup>th</sup> district East of the old Boundary line,

Pursuant to a warrant from John Thomas Esq. Commissioner of Locations dated the 23 day of March 1785, I have admeasured and laid out unto William Barnett a tract of Land containing six Hundred and forty seven acres, on the small branches of Two mile Creek waters of Enoree River, bounded S<sup>e</sup> by Joseph Barnett's land, w<sup>e</sup> by, by Jean M. Clarkin's land, Westwardly by Richard Chesney's land, S<sup>e</sup> by William Nash's land, all other sides Vacant Land, and hath such shape and Marks as the above Plat represents, Survey<sup>d</sup> the 4<sup>th</sup> day of April 1785, Recorded the 17<sup>th</sup> May 1785, Andrew Thomson Esq.

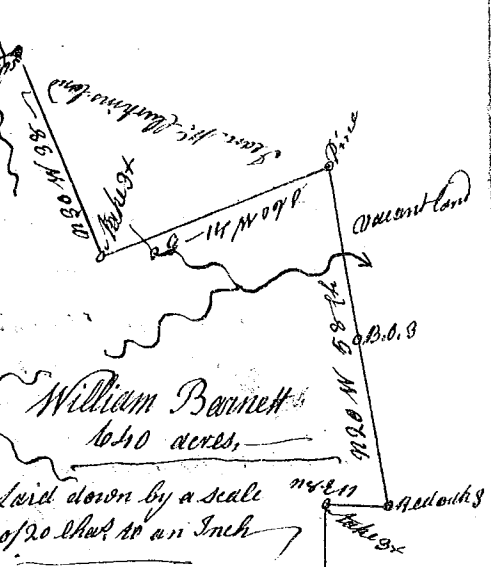

State of S<sup>c</sup> Carolina 9<sup>th</sup> district East of the old Boundary line

Pursuant to a warrant from John Thomas Commissioner of Locations, dated the 29<sup>th</sup> day of March 1785, I have admeasured and laid out unto Daniel O'arr a tract of six hundred and forty seven acres, on the branches of Forgeons Creek a branch of Sygar River, bounded N<sup>e</sup> by James Wofford's land NW by John Peden's land, all other sides by old lines and Vacant Land, and hath such shape and marks as the above Plat represents, Survey<sup>d</sup> the 4<sup>th</sup> day of April 1785, Recorded 17<sup>th</sup> May 1785, by Andrew Thomson Esq.

