

State of South Carolina (150)
 Pursuant to a warrant from John Thomas as Esq. Comr. of Locations dated the 13th of May 1755 I have admeasured and laid out unto John Young a Tract of Two hundred & ninety four Acres situate in District No. 20 of the S. Side of Saluda on a Branch of Saluda having such and such shape marks Buthings and Boundings as the above Plat Represents

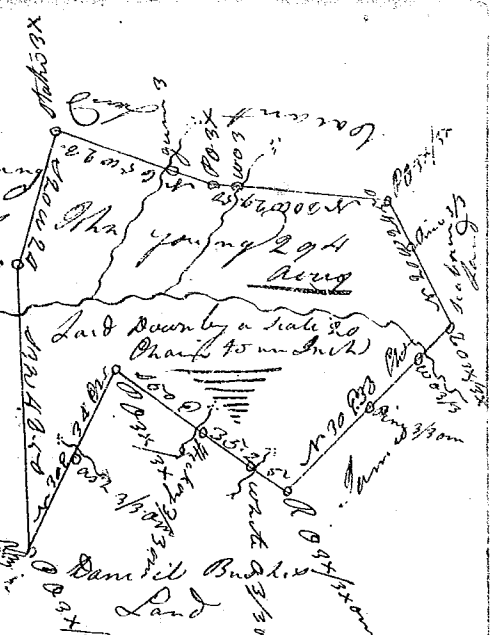

Surveyed the 7th of May 1755
 Recorded the 14th of June 1755
 J. J. Whitham

South Carolina Pursuant to a warrant from John Thomas, Commissioner of Locations, I have admeasured and laid out unto John Watson a tract of six hundred and twenty eight acres land, situate in District No. 20 on North branch of Chick-creech, bounding SW on lands belongg to Vardery, M. B. and John Watson and all other sides vacant and hath such shape and marks as the above plat Represents
 Surveyed the 25th May 1755
 Recorded the 17th June 1755
 J. J. Martin

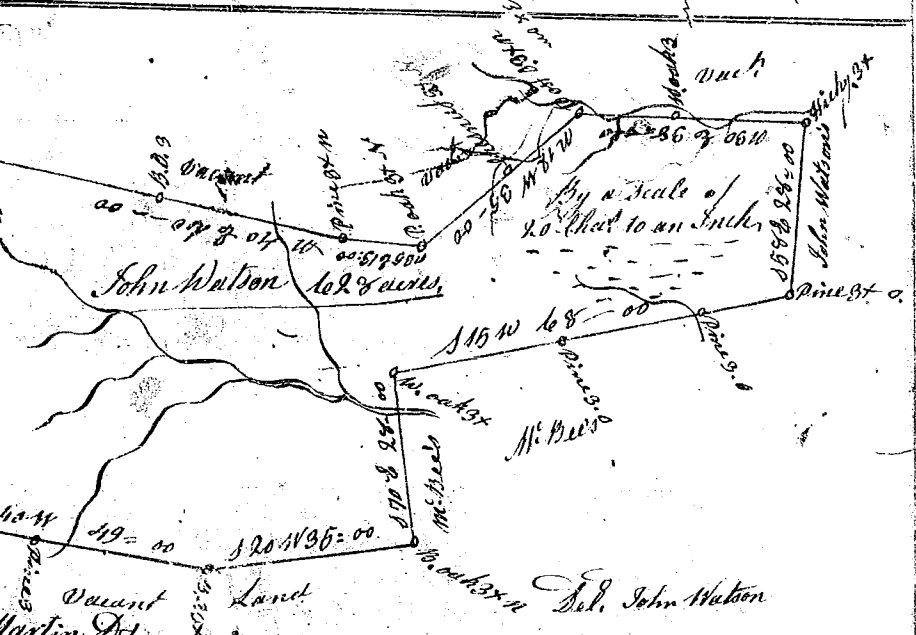

State of South Carolina Pursuant to a warrant from John Thomas Commissioner of Locations for ninety six District north side of Saluda, I have admeasured and laid out unto William Lipscomb a tract of land containing one hundred and seventy acres situate in the said District on Beaverdam-creech adjoining William Lipscombs line, and on all other sides as the above plat Represents, and hath such shape and marks as the above Plat Represents, Surveyed the 13th June 1755
 Recorded the 15th June 1755
 J. J. Kulloch
 Del. John Watson

