

State of S<sup>c</sup> Carolina Pursuant to a warrant from John Thomas Commissioner of locations dated the 26 day of April 1785, I have admeasured and laid out unto George Morgan a tract containing 30 acres of land, situate in Ninety six district on Needy River of Saluda below the ancient boundary line, bounded N<sup>o</sup> on George Morgans land, SW on D<sup>o</sup> Smith's land, S<sup>o</sup> on said River, and hath such shape and Marks as the above Plat represents, SWW<sup>ly</sup>, 30 April 1785,  
Recorded the 16 July 1785, by Joshua Seaton D<sup>y</sup>

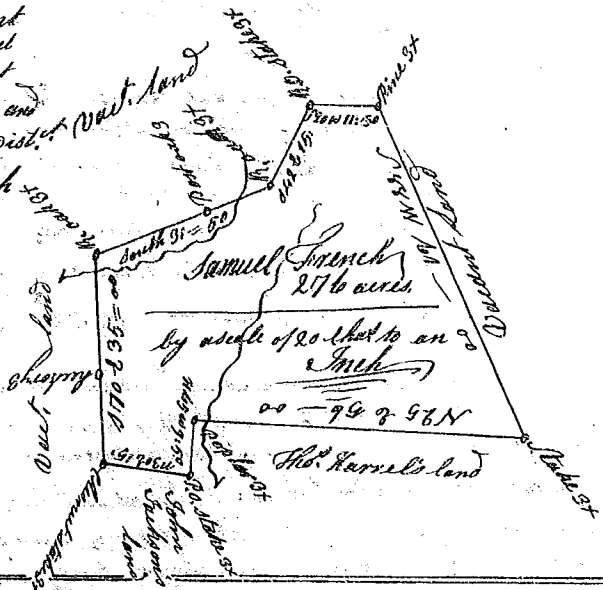

State of South Carolina Pursuant to a warrant from John Thomas Commissioner of locations dated 2<sup>d</sup> day of May 1785, I have admeasured and laid out unto Samuel French a tract of Two hundred and seventy six acres of land, situate in Ninety six dist<sup>o</sup> on the branches of Saluda River, and hath such shape, Marks, hitings and boundings as the annexed plat represents SWW<sup>ly</sup>, 2<sup>d</sup> May 1785.  
by George Salmon D<sup>y</sup>,  
Recorded 16<sup>th</sup> July 1785,



State of S<sup>c</sup> Carolina Pursuant to a warrant from John Thomas Commissioner of locations, dated 17<sup>th</sup> May 1785 I have admeasured and laid out unto John Maxwell a tract of two hundred acres of land, below the ancient boundary, situate in Ninety six district N<sup>o</sup> Saluda River bounding on all sides on Vacant land, and hath such shape and Marks as the above Plat represents, SWW<sup>ly</sup>, the 6<sup>th</sup> June 1785,  
Recorded 9<sup>th</sup> July 1785, by Thomas Loston D<sup>y</sup>  
D<sup>y</sup> David Milroy

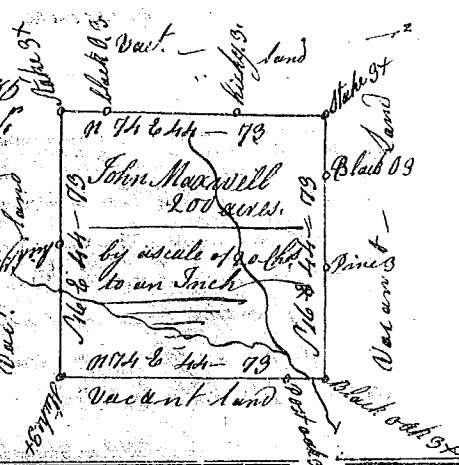

State of S<sup>c</sup> Carolina Pursuant to a warrant from John Thomas Commissioner of locations, dated the 25 day of May 1785, I have admeasured and laid out unto William Helms a tract of land containing one hundred acres, situate in Ninety six district Laurens County on a branch of Enoree River called the Weaver Dam, below the ancient boundary line, bounded on all sides by Vacant land, and hath such shape and Marks as the above Plat represents - SWW<sup>ly</sup>, the 3<sup>d</sup> day June 1785,  
Recorded the 17<sup>th</sup> July 1785, by Jonathan Downer D<sup>y</sup>

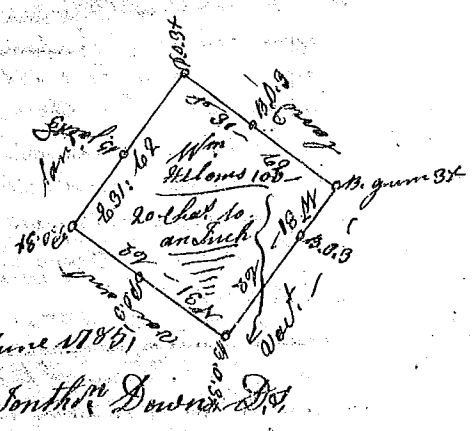

44.73  
26.72  
134.18  
31.31  
178.82  
178.82  
2000.1129