

State of South Carolina

(173)

Pursuant to a warrant from John Thomas Esq. Commissioner of locations, I have admeasured and laid out unto Alexander Gilleland tract of two hundred and fifty one acres of land, on the North side of Saluda River, situate in ninety six parish and bounded N<sup>o</sup> on land laid out to David Gentry E<sup>o</sup> on land laid out to Robt. Gilleland and Joseph Meed SW<sup>o</sup> & NW<sup>o</sup> on land laid out to George Meed & Joseph Duncanson who Saluda River, on the other side, and hath such shape and marks as the above Plat represents

Survey, the 16th July 1785, by John Hunter Esq.  
Recorded the 16th July 1785,



State of S<sup>c</sup>. Carolina Pursuant to a warrant from John Thomas Esq. dated 15th April, 1785, I have admeasured, and laid out unto Robert Gilleland tract of two hundred and seventy one acres of land, above the ancient boundary line, situate in Ninety Six District, on south branches of Grove Creek waters of Saluda River, bounding S<sup>o</sup> on Joseph Meed NE on John Bowie NW on David Gentry, on all other sides on vacant land, and hath such shape and marks as the above Plat represents,

Survey, the 17th April 1785, by Thos. Lofton Esq.  
Recorded 16 July 1785,

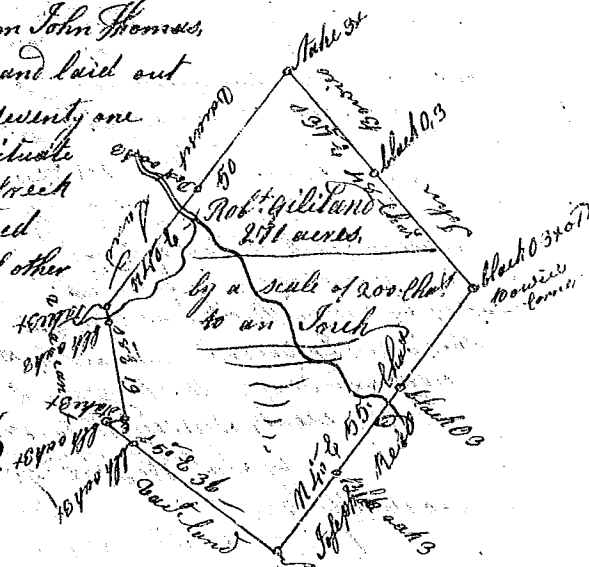

State of South Carolina 9<sup>th</sup> District N<sup>o</sup> Saluda East of the boundary line

Pursuant to a warrant from John Thomas Commissioner of locations dated 2<sup>o</sup> day April 1785, I have admeasured, and laid out unto Tennet Barry tract of land containing one hundred and fifty acres, situate lying and being on a branch of Cox's Creek the waters of whose River, bounded S<sup>o</sup> E<sup>o</sup> by Abraham Gray's land, W<sup>o</sup> E<sup>o</sup> by Henry Hamilton's land, all other sides by vacant land and hath such shape form and marks as the above Plat represents, Survey, 25th May 1785,

Recorded 16th July 1785, James Mofford Esq.



State of S<sup>c</sup>. Carolina Pursuant to a warrant from John Thomas Commissioner of locations. Dated 3 day of May 1785, I have admeasured and laid out unto John Saxon tract of land containing three hundred and thirty acres, situate in 96<sup>th</sup> District on a branch of Rocky River call Goodwin's branch below the ancient boundary line, bounded N<sup>o</sup> & N<sup>o</sup> on John Goodwin's land & Lewis Saxon, and all other sides on vacant land, and hath such shape and marks as the above Plat represents, Survey, 30 May 1785,

Recorded the 16 July 1785, by South<sup>n</sup>. Downs Esq.  
Jed. Jed. Wilkison

