

State of S. Carolina 96 District West of the old Boundary (105)
 Pursuant to a Warrant from John Thomas Esq. Com. of Locations Dated
 17th June 1785. I have admeasured & laid out unto Joseph Walker
 a tract of 200 Acres lying on both sides of Rocky creek
 Bounded Southwardly by Moses Langley's land, all other sides
 on vacant land, & hath such shape & marks as the annexed plat
 Represents. Surveyed this 20th June 1785 Andrew Thomson Esq.
 Recorded the 4th day of August 1785

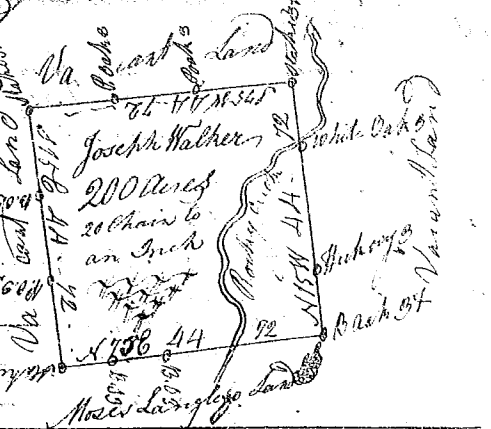

State of S. Carolina Ninety and District East of the Ancient Boundary
 Pursuant to a Warrant from John Thomas Esq. Com. Loc.
 Dated the 12th May 1785, I have admeasured & laid out unto
 John Roebuck a tract of land containing Two Hundred Acres
 Situated lying & being on the S. Side of Sugar River & on both
 sides of James Creek Bounded on all sides by Vacant Land, &
 hath such Shape & marks as the annexed plat Represents
 Surveyed this 22nd May 1785 Andrew Thomson Esq.
 Recorded the 4th of August 1785

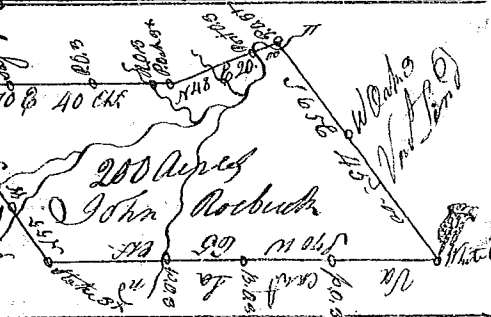

State of S. Carolina. Pursuant to a Warrant from
 John Thomas Esq. Com. of Locations. I have admeasured
 & laid out unto Richard Bond a tract of One Hundred
 and fifty seven acres of land. Situate in 96
 District, on Bever creek a branch of Enoree River
 & hath such Shape marks Buttings & Boundings
 as the annexed plat Represents. Surveyed 29th July 1785
 Recorded the 4th August 1785 J. Bond
 Ben. Glenn Esq.

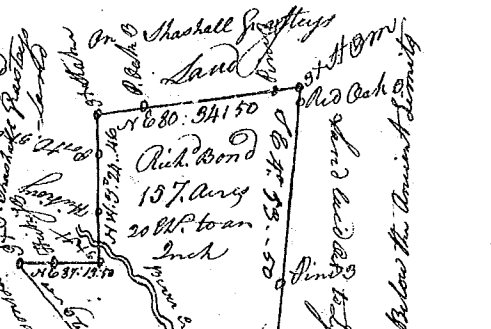

State of S. Carolina
 Pursuant to a Warrant from
 John Thomas Esq. Com. of Locations
 I have admeasured & laid out unto
 James Helley a tract of Eighty one Acres of land Situate in 96 District
 on N. side of Enoree River, a branch of Broad River, & hath such Shape & marks
 Buttings & Boundings as the annexed plat Represents. Surveyed this 28 July 1785
 Recorded the 4th August & Deliv'd to Rich. Bond both the above Ben. Glenn Esq.

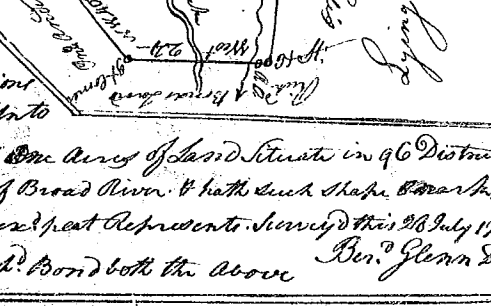

State of South Carolina 96 District West of the old
 Boundary line. Pursuant to a Warrant from John
 Thomas Esq. Com. of Locations Dated 10th May 1785. Chair admeasured
 I laid out unto Thomas Doag a tract of land containing One Hundred
 & Twenty eight Acres situated lying & being on the S. side of the S. fork
 of Sugar River & on both sides of a branch of Marsh Creek of
 Sugar River Bounded on all sides on Vacant Land & hath such
 shape & marks as the annexed plat Represents. Surveyed 1st June 1785
 Recorded 4th August 1785 Andrew Thomson Esq.

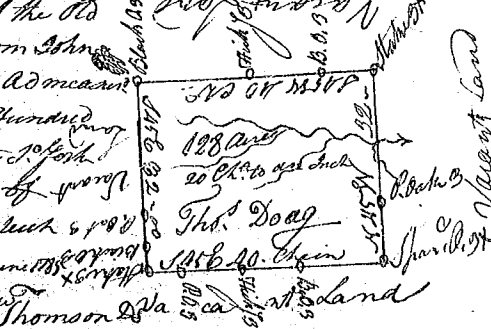

State of South Carolina. Pursuant to a Warrant from
 John Thomas Esq. Com. of Locations. I have admeasured &
 laid out unto John Boyd a tract of two hundred &
 two Acres of land Situate in 96 District below the
 Ancient Boundary, on a branch of Enoree River known
 by the Name of Ramages Creek. Bounded S. on S. Ramages
 N. on S. Ramages & land laid unknown & W. on Ramages
 & hath such Shape & marks as the annexed plat Represents
 Surveyed this 11th June 1785
 Recorded the 4th Aug 1785 John Hunter Esq.
 Deliv'd to John Boyd

