

State of South Carolina

(396)

Pursuant to a Warrant from John Thomas Esq^r Com^r of Locations in 96 District N^o of Saluda. Dated the 9th Day of June 1785. I have admeasured & laid out unto John Boye a tract of four hundred & twenty two acres of land situated in 96 District Below the Ancient Boundary on a branch of Enore Call^d Head of Creek Bounded N^o & E^o by U.C. on land unknown & N^o on land unknown N^o on William Davis's land & hath such shape & marks as the annexed plat represents. Survey'd this 17th of June 1785. By Andrew Thomson Dep. Sec^y Recorded the 4th August 1785. Deliv^d John Boye

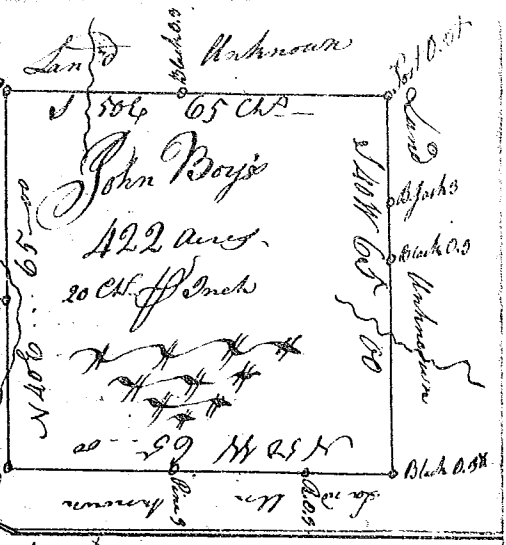

State of South Carolina Ninety six District East of the Old Boundary Pursuant to a Warrant from John Thomas Esq^r Com^r of Locations Dated the 16th May 1785. I have admeasured & laid out unto Abraham Thompson a tract of land containing eighty eight acres lying on the N^o side of Fairforest Creek Bounded N^o & E^o by John Thompsons land N^o by Leonard Bandy Bullocks land John West by Samuel Thompsons land & hath such other shape & marks as the annexed plat represents. Survey'd this 31st May 1785. Andrew Thomson Dep. Sec^y Recorded this 5th day of August 1785.

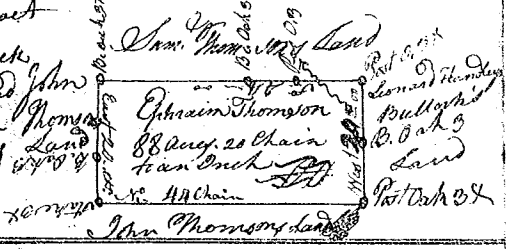

State of South Carolina Ninety six District West of the Old Boundary Pursuant to a warrant from John Thomas Esq^r Com^r of Locations Dated the 2nd June 1785. I have admeasured & laid out unto Joseph Richardson a tract of land containing two hundred acres lying on the S^o side of Reddy River on both sides of the Reddy Branch Bounded N^o by Fredericks Crawford's land E^o by John Brashars land all other sides on Vacant land. I hath such shape & marks as the annexed plat represents. Survey'd this 9th June 1785. Andrew Thomson Dep. Sec^y Recorded this 5th day of August 1785. J.C.

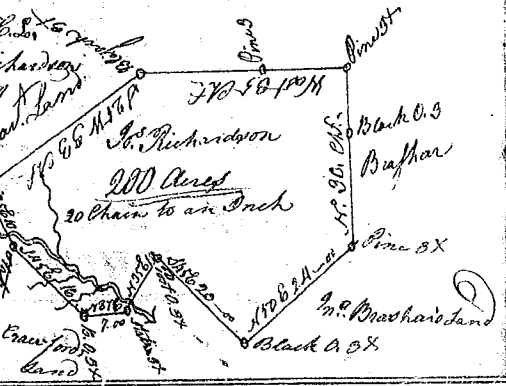

State of South Carolina Ninety six District West of the Old Boundary Pursuant to a Warrant from John Thomas Esq^r Com^r of Locations Dated the 26th April 1785. I have admeasured & laid out unto John Brashar a tract of land containing one hundred acres on both sides, bounded to the N^o & E^o by Samuel Bileys land all other sides by Vacant land & hath such shape & marks as the annexed plat represents. Survey'd this 18th day of May 1785. By Andrew Thomson Dep. Sec^y Recorded the 5th day of August 1785.

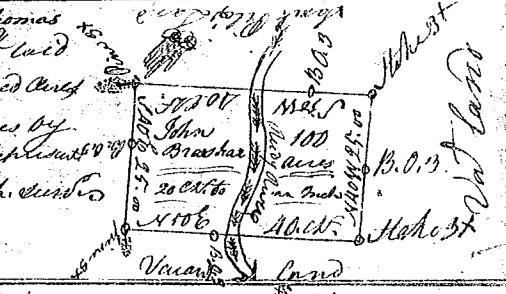

State of S^o Carolina Pursuant to a Warrant from John Thomas Esq^r Com^r for 96 District N^o of Saluda. Dated the 9th of May 1785. I have admeasured & laid out unto James Johnson a tract of two hundred & thirty nine acres of land situated in 96 District N^o of Saluda Below the Ancient Boundary on the waters of Little River Bounded N^o & E^o on J^o James Johnsons land & James Gaugins land N^o & E^o on John Hays land & Stephens Lewis's land N^o & N^o part John Hooks's part James Walkups land, & hath such shape & marks as the annexed plat represents. Survey'd this 10 June 1785. Recorded this 8th Aug. 1785.

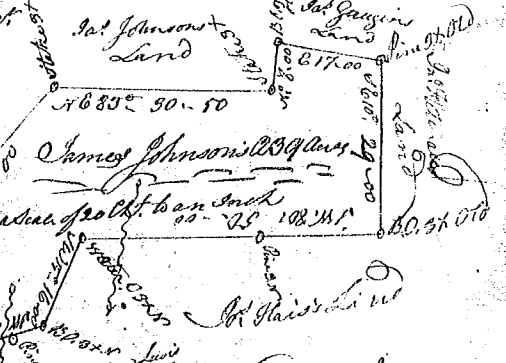

State of S^o Carolina Pursuant to a Warrant from John Thomas Esq^r Com^r of Locations Dated the 9th May 1785. I have admeasured & laid out unto James Johnson a tract of one hundred & thirty one acres of land situated in 96 District N^o of Saluda below the Old Boundary on Waters of Bush River. Bounded N^o part on Benjamin Neals & part Vacant land all other sides Vacant & hath such shape & marks as the annexed plat represents. Survey'd this 10 June 1785. Recorded the 5th August 1785.

