

State of S^c Carolina
 Pursuant to a warrant from John Thomas Esq^r
 Commissioner of Locations dated the 15th June 1785,
 I have admeasured and laid out unto Benjamin
 Wharton a tract of four hundred and forty acres
 of land, situate in Ninety six district, on both
 sides of Redder dam Creek of Enore River, and
 hath such shape, Marks, buttings and boundings
 as the above plat represents,
 Witness my hand the 29th July 1785,
 John Young Jun^r Esq^r
 Recorded 12 Aug^r 1785.

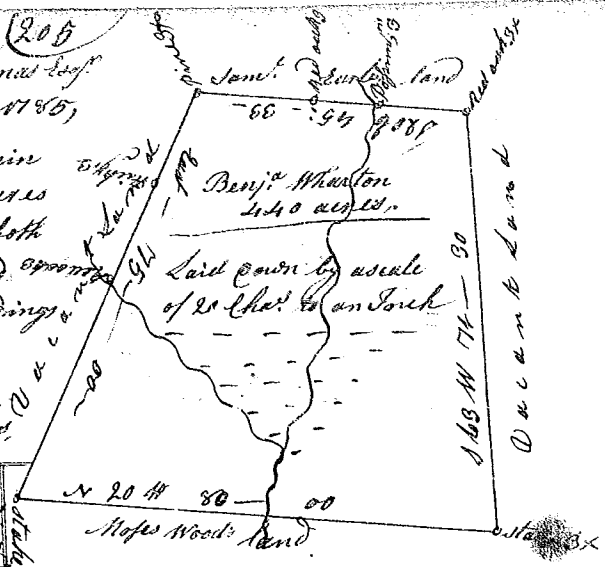

State of South Carolina
 Pursuant to a warrant
 from John Thomas Esq^r Commissioner of Locations
 dated the 2nd day of August 1785 I have admeasured
 and laid out unto William Russell
 a tract of Land on town lands
 Hundred and forty acres situate in
 Ninety six district west of the
 old Boundary on both sides of
 Enore River and Mountain Creek
 of S^c River bounding on all sides
 Vacant Land & with such shape
 as the above Plat Rep^s
 Witness my hand the 3rd day of
 August 1785
 George Salmon Esq^r
 Recorded the 13th day August 1785

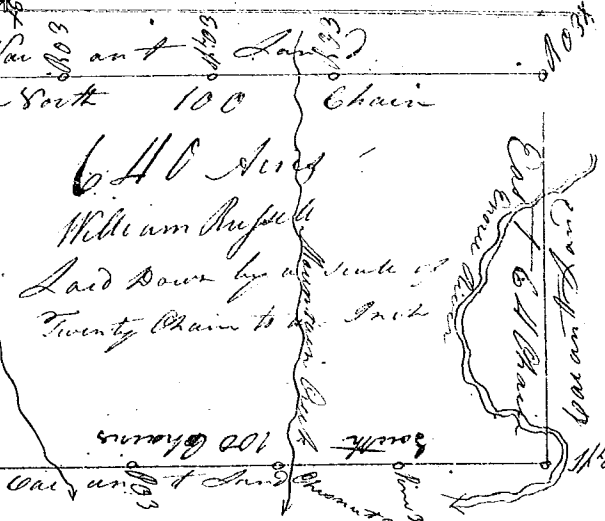

State of South Carolina. Pursuant to a
 Warrant from John Thomas Esq^r dated the
 29th July 1785, I have admeasured & laid out
 to Daniel Kelly a tract of three Hundred and
 Twenty five Acres of land, situate in 96th District
 on the branches of Saluda River & hath such
 shape & marks as the annexed Plat represents
 Surveyed the 9th day of Aug^r 1785
 Recorded the 13th Aug^r 1785
 George Salmon Esq^r

State of S^c Carolina
 Pursuant to a
 Warrant from John
 Thomas Esq^r
 I have admeasured
 & laid out unto Abel
 Pearson a tract 224 Acres of land, situate in
 Ninety six district, on the side Enore River, bounding
 on the N^e side by Enore, S^e by land laid out to John
 Evans, E^{ly} by Abel Pearson's 187 by Josephus Burchett
 & hath such shape & marks as the annexed Plat represents
 Surveyed this 7th August 1785. Abel Pearson Esq^r



State of S^c Carolina. Pursuant to a warrant from
 J^o Thomas Esq^r Esq^r I have admeasured laid out to
 Abel Pearson a tract of 187 Acres of land situate in
 Ninety six district below the ancient limits on Burnings in
 to Enore River, bounding N^e by land laid out to Rich^d Hinton
 E^{ly} by Roger Rogers S^e by Wm Rogers W^t by land unknown
 & hath such shape & marks as the annexed Plat represents
 Surveyed this 20th July 1785. Abel Pearson Esq^r
 Recorded the 15th Aug^r 1785. Abel Pearson Esq^r

