

State of S. Carolina. Pursuant to a warrant from John Thomas Esq. Com. of Prob. for the District of 96 N. of Saluda. Dated the 16th June 1785. I have laid out unto James Simpson a tract of two hundred & eighty two acres of land situate in 96 District below the old boundary on a branch of Little River the waters of Saluda. Bounded on all sides as above mentioned & hath such shape & marks as the annexed plat represents. Survey'd this 9th Aug. 1785. John Hunter Esq. Recorded this 22nd Aug. 1785. D. J. Simpson.

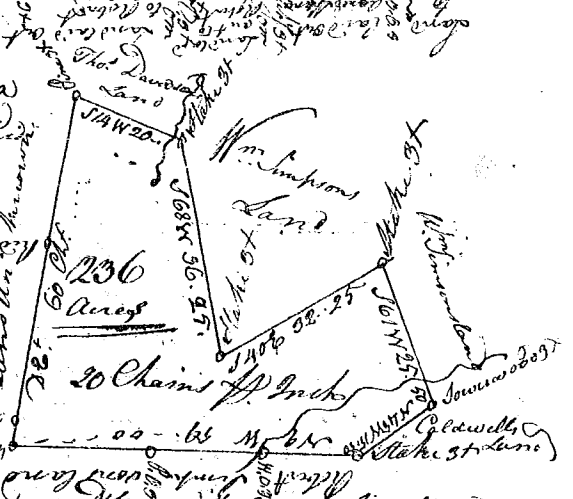

State of S. Carolina. Pursuant to a warrant from John Thomas Esq. Com. for 96 District N. of Saluda. Dated the 16th June 1785. I have Admeasured & laid out unto James Simpson a tract of 236 Acres of Land situate in 96 District below the old Boundary line, on a branch of Saluda River called Quakers Branch running into Little River bounded N. on land unknown N. East on Mr. Davidson's tract on W. Simpson's, on E. Caldwell's & W. on Robert Simpson's & hath such shape & marks as the annexed plat represents. Survey'd this 18th June 1785. John Hunter Esq. Recorded 22 Aug. 1785. D. J. Simpson.



State of S. Carolina. Pursuant to a warrant from John Thomas Esq. Com. for the District of 96 N. of Saluda River. Dated the 14th Jun. I have admeasured & laid out unto Wm Simpson a tract of 103 Acres of land. Situate in 96 District N. of Saluda River on Quakers Branch of S. River running into Little River bounded N. on land laid out to James Simpson N. E. on land laid out to Thos. Davidson S. on land laid out to Ellis Caldwell & hath such shape & marks as the annexed plat represents. Survey'd this 7th Aug. 1785. Recorded the 22nd Aug. 1785. D. J. Simpson.



State of S. Carolina. Pursuant to a warrant from John Thomas Esq. Com. of Prob. Dated the 20th day of June 1785. I have Admeasured & laid out unto Samuel Cooper a tract containing 218 Acres of land situate in 96 District on a branch of Little River waters of Saluda. Bounded on all sides as above mentioned & hath such shape & marks as the annexed plat represents. Survey'd this 19th Aug. 1785. Joshua Saxon Esq. Recorded the 22nd Aug. 1785. D. J. to J. Floyd.

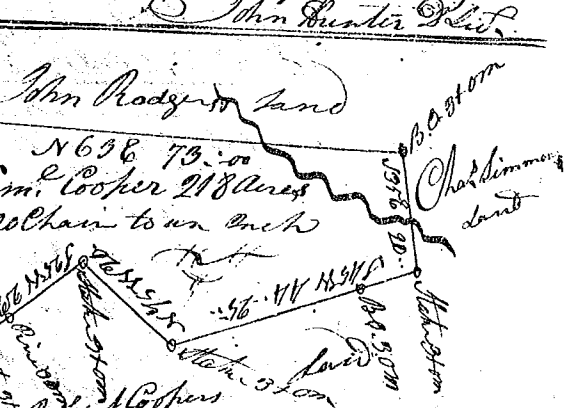

Pursuant to a warrant from John Thomas Esq. Com. for 96 District on the N. Side of Saluda. I have admeasured & laid out unto Nathaniel Bullock's tract of land containing one hundred & fifteen acres situate on the N. Side of said River. Bounded to the S. on said Bullock's land West on Ferris Connell's land N. on Common Ellis's land all other sides vacant & hath such shape & marks as the annexed plat represents. Survey'd the 20th August 1785. Nath. Bullock Esq. Recorded this 24th August 1785. D. J. Edmund Ellis.

