

State of S. Carolina Pursuant to a
 Warrant from John Thomas Esq. C. L. dated
 this 15th July 1785. I have admeasured
 & laid out unto Edmund Dukes a
 tract of two Hundred acres of Land below
 the Ancient Boundary, in Laurens County
 Bounding N: on Holloway Powers Land
 S: on Currys Land & the other sides not
 known & hath such shape form & marks as
 the above tract do represent
 Survey'd this 24th July 1785
 Recorded this 24th August 1785

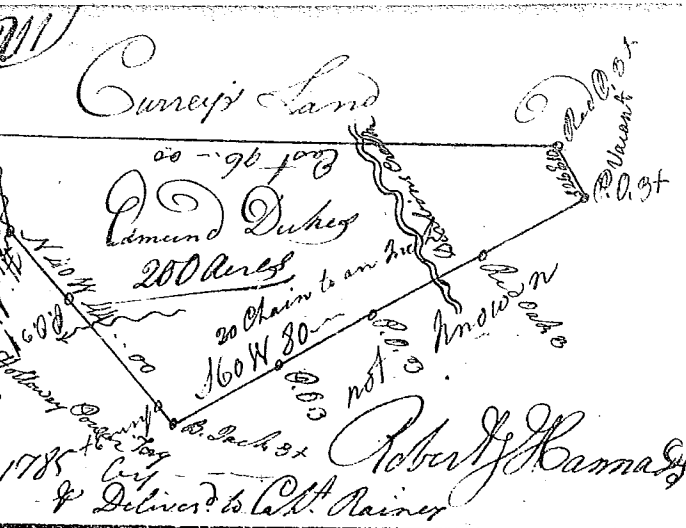

State of S. Carolina Pursuant to a warrant
 from John Thomas Esq. C. L.
 dated the 15th April 1785. I have admeasured
 & laid out unto William Steel a tract of four
 Hundred & forty acres of Land, on the waters of
 Dubins Creek below the Ancient Boundary
 Bounding N: on Land of Wm Steels the other
 sides by Vacant Land & hath such shape
 form & marks as the annex'd plat represents
 Survey'd this 6th July 1785 John Rodgers Esq
 Recorded this 25th August 1785

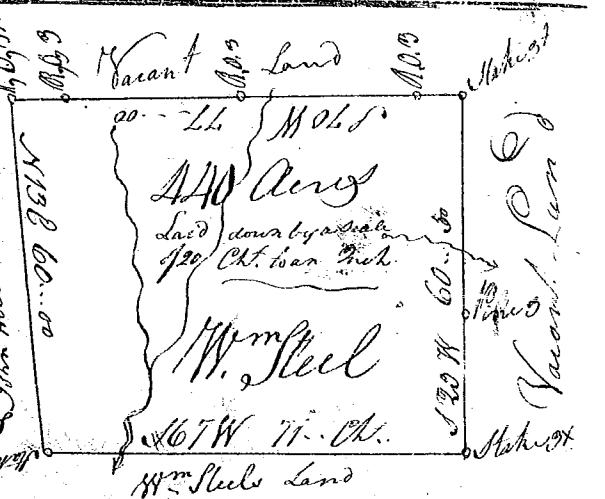

State of S. Carolina Pursuant to a warrant from
 Laurens County John Thomas Esq. C. L. dated the
 15th April 1785 I have admeasured
 and laid out unto Wm Steel a tract of Land con-
 taining Two Hundred acres on a branch of Dubins
 Creek below the Ancient Boundary Bounding N: on
 Land laid out for John York W: on Vacant Land & on William Steels Land
 and hath such shape form & marks as the above plat represents
 Survey'd this 6th July 1785 by John Rodgers Esq
 Recorded this 25th August 1785

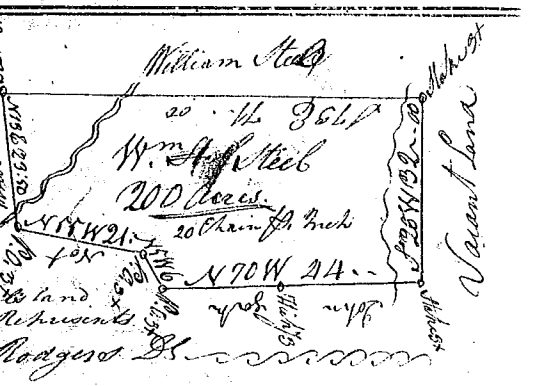

State of S. Carolina Pursuant to a warrant from John Thomas Esq.
 Laurens County C. L. dated the 12th August 1785. I have ad-
 measured & laid out unto Robert Roper a tract
 of Land containing one Hundred & fifty four acres on a branch
 of Warriors Creek below the Ancient Boundary Bounding N: by E: on
 Marshal Franks Land N: on John Madril & N: W on Francis Roper
 the other boundaries not known. & hath such shape form &
 marks as the annex'd plat represents. Survey'd this 16th Aug^r 1785
 Recorded this 25th August 1785 John Rodgers Esq

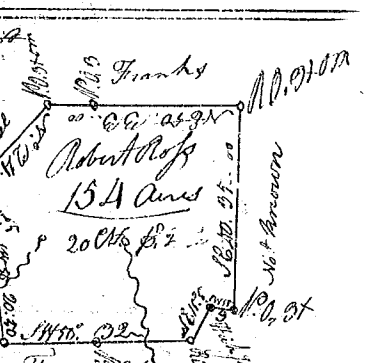

State of S. Carolina Pursuant to a warrant from John Thomas Esq.
 C. L. bearing date the 12th June 1785. I have admeasured & laid
 out unto Hugh Young a tract of land containing one hun-
 dred & twenty two acres, situated in 96 District below the old
 Boundary line, on the waters of Beard's fork, a branch of Duncan's
 Creek. Bounded on all sides as above specified & hath such shape
 and marks as the annex'd plat represents
 Survey'd this 15th June 1785 by Geo^r M^r Jones Esq
 Recorded this 25th August 1785 Deliv^d to Geo^r Rodgers the 4 above

