

State of Carolina

Pursuant to a warrant from John Thomas Commissioner of locations, I have admeasured and laid out unto William Gray a tract of five hundred and sixty six acres of land on Indian Creek Newberry County, Having such shape, Marks, Distings and boundings as the above plat represents, Survey, 1st Sept, 1785

By Robt. Hanna Ds.
Recorded 12 sept, 1785

Del. W. Read

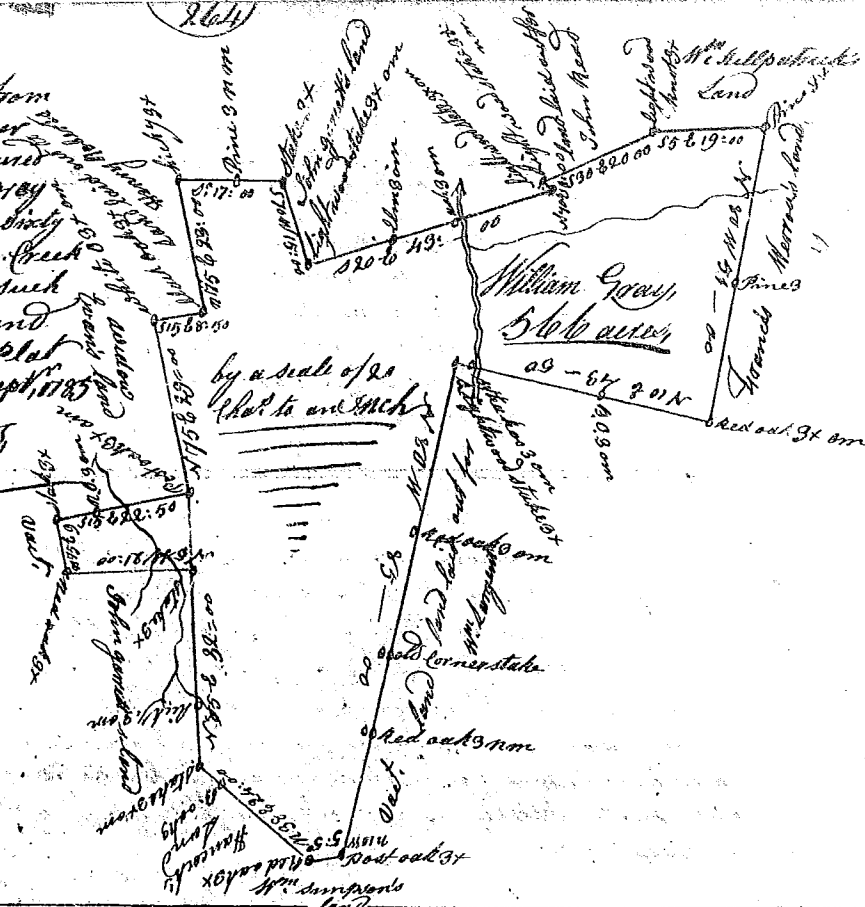

State of South Carolina

Pursuant to a warrant from John Thomas, Esq. Commissioner of locations dated the 23 day of April 1785, I have admeasured and laid out unto George Grayson a tract of one hundred and seventy eight acres of land situate in 96 District above the ancient boundary line to the south side of Needy on a branch thereof bounded N & on William Height's and Saml Pyles's land and all other sides on Vacant Land, and hath such other shape and Marks as the above plat represents, Survey, 6th June 1785, by Joseph D. Downs Ds.

Recorded 13th sept, 1785

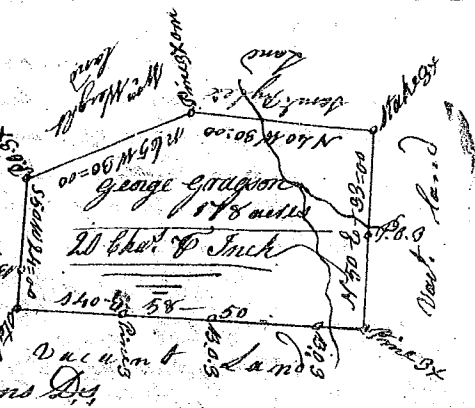

State of South Carolina Pursuant to a warrant from John Thomas Esq. Commissioner of locations dated the 14th day of April 1785, I have admeasured and laid out unto Benjamin Aynsey a tract containing one hundred and sixteen acres of land, situate in 96 District above the ancient boundary line, on a branch of Needy River call. Aynsey's branch, bounded on all sides as above specified, and hath such shape, and Marks as the above plat represents, Survey, 21 June 1785, by Joseph D. Downs Ds.

Recorded 13th sept, 1785



State of Carolina Pursuant to a warrant from John Thomas Commissioner of locations dated 14th day of April 1785, I have admeasured and laid out unto Benjamin Mynsey a tract containing 38 acres of land, situate in 96 District above the ancient boundary line, on the waters of the Needy fork branch of Needy River, bounded on all sides as above mentioned, and hath such shape, and marks as the above Plat represents

Recorded 13th sept, 1785

Survey, 21 day June 1785, by Joseph D. Downs Ds.

