

State of S^c Carolina,

Pursuant to a warrant from John Thomas Esq^r Commissioner of Locations Dated the 14th Nov^r 1785 I have admeasured and laid out unto Paul Abner a tract of two hundred acres of land, situate in Ninety Six District, on both sides of Runaway Creek of Enoree river, and hath such shape, Marks, buttings and boundings as the above Plat Represents, Survey, 19th of Nov^r 1785,
Recorded 21st Dec^r 1785, by John K. Killpatrick
Del. Isaac Newman

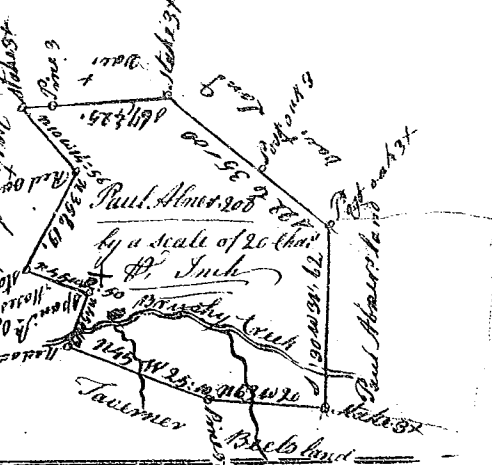

State of South Carolina Pursuant to a warrant from John Thomas Esq^r Commis^r of Locations Dated 22nd Nov^r 1785, I have admeasured and laid out unto John Nicol a tract of land containing 156 acres situate in Ninety Six District on both sides of French Broad river, N^o of the Indian boundary line, bounded on the St by Septe Connells land, all other sides by vacant land, and hath such form and Marks as the above Plat Represents, Survey, 25 Nov^r 1785,
Recorded 21 Dec^r 1785, by Septe Connell Des.

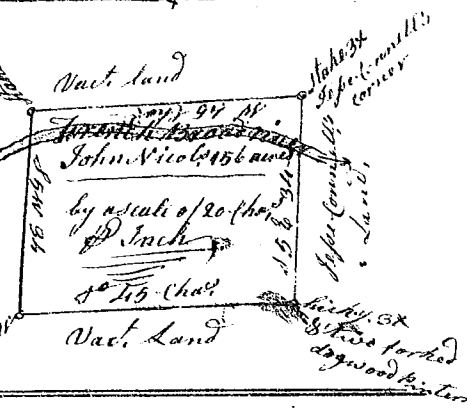

State of South Carolina Pursuant to a warrant from John Thomas Esq^r Commis^r of Locations Dated 24th Sept^r 1785 I have admeasured and laid out unto Thomas Smith a tract of Land containing Two hundred & forty acres situate in 96 District on the branches of fair forest east of the Indian boundary line, bounded N^o by Wm Prince's Land, S^e by Hancock Smith's & Col^l Henry White, S^e by Sw^o White, W^t by Hiller Mountain Land & by Smith's land, and hath such shape & Marks as the above Plat Represents, Survey, 29th Sept^r 1785, Septe Connell Des.
Recorded the 22 Dec^r 1785,

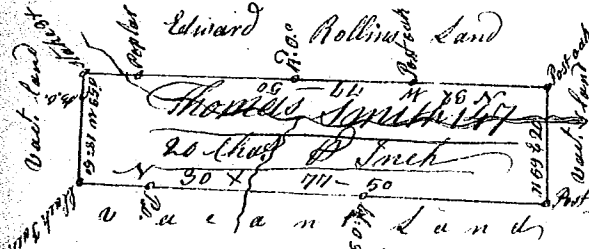
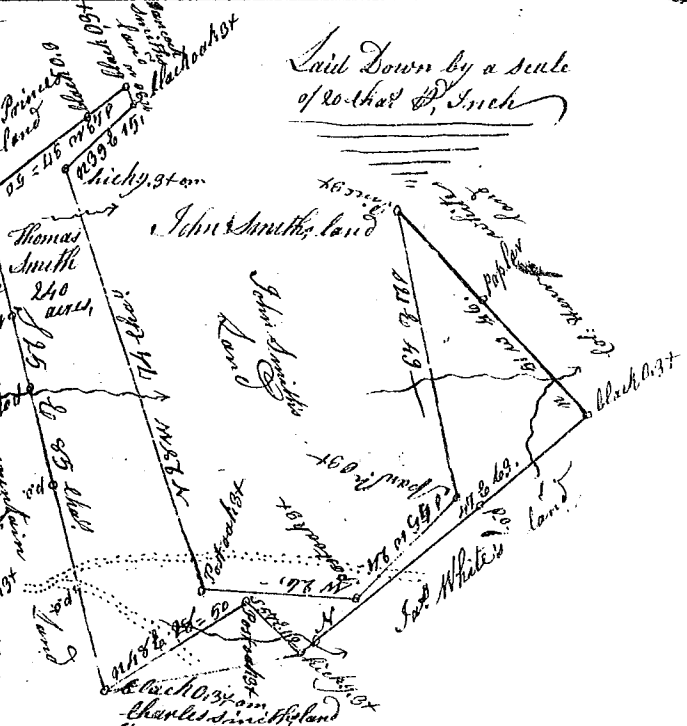

State of South Carolina Pursuant to a warrant from John Thomas Esq^r Commissioner of Locations dated 24th Sept^r 1785, I have admeasured and laid out unto Thomas Smith a tract of land containing one hundred and forty seven acres, situate in ninety six District, east of the Indian boundary line, bounded N^o by Edward Rollins's L^o, all other sides by vacant land, and hath such shape & mark as the above Plat Represents, Survey, 29th Sept^r 1785, by Septe Connell Des.
Recorded 22nd Dec^r 1785,

State of South Carolina Pursuant to a warrant from John Thomas Esq^r Commissioner of Locations, I have admeasured and laid out unto William Burton a tract of 100 acres of land situate in Union County Ninety Six District below the ancient limits, on the S^e side of Enoree river and hath such shape, Marks, buttings and boundings as the above Plat Represents, Survey, 29th Dec^r 1785,
Recorded 23rd Dec^r 1785, by Abel Pearson, Jr.
Del^r Abraham Wood

