

State of Carolina

Pursuant to warrant from John Thomas Esq. Commissioner of Locations Dated 11th Sept. 1785. I have admeasured and laid out unto Benjamin Oliver a tract of two hundred acres of land, above the ancient Boundary, situate in Ninety six district, N. of Saluda river, bounding N. E. & S. W. on land laid Thomas Foxer, all other sides on vacant land, and hath such shape & marks as the above Plat represents, surveyed 17th Sept. 1785. Recorded 12th Jan. 1786. by Thomas Coffin Esq. Tell himself

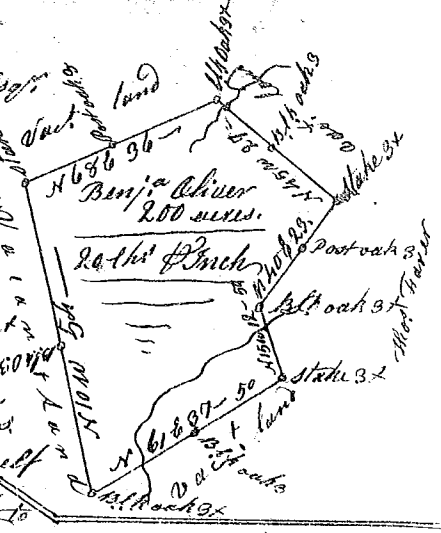

Laurens County Pursuant to

a Warrant from John Thomas Esq. Com. of Locations dated Nov. 25. 1785. I have admeasured & laid out unto David Neff a tract of 120 acres of Land, below the ancient Boundary, Cutting & bounding on the East side of Neffs River from David Green East on cannot know when 1st Dec. 1785 & hath such shape & marks as the annexed Plat represents surveyed this 8th Dec. 1785. by John Rodgers Esq. Recorded this 11th January 1786. D. C. Neff

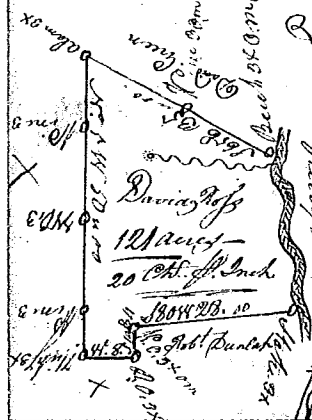

S. Carolina

Pursuant to a Warrant from some Directed by John Thomas Esq. Com. of Locations of Saluda dated the 17th Nov. 1785. I have admeasured & laid out to Daniel Dyon a tract of Land containing two hundred & thirty three acres, ~~of the~~ <sup>of the</sup> Saluda River in Suddery County Below the ancient Boundary & hath such shape & marks as the above Plat represents surveyed 19th Nov. 1785. Wm Anderson Esq.

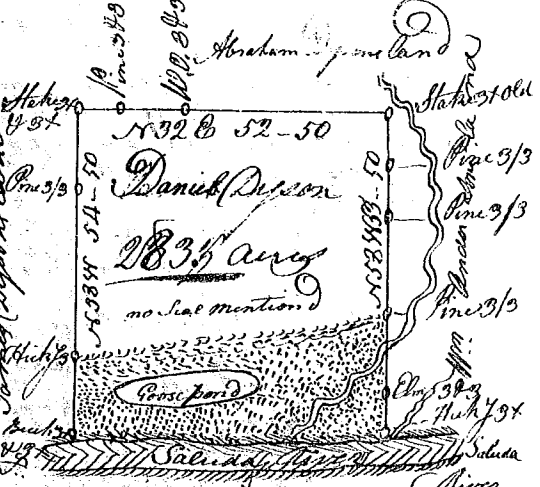

Pursuant to a warrant from John Thomas Esq. Com. of Locations dated the 17th Nov. 1785 I have admeasured & laid out unto Dyon a tract of 32 acres of Land on the N. side Saluda on a small branch of Goose Pond back below the F. D. boundary & hath such shape & marks cutting & bounding as the above Plat represents, surveyed this 19th Nov. 1785. Wm Anderson Esq. Recorded this 14th January 1786, both the above



State of S. Carolina, Pursuant to a warrant from John Thomas Esq. Commissioner of Locations, I have admeasured and laid out unto Robert Taylor a tract of one hundred and fifty acres of Land in Laurens County on a small branch of Duncans Creek bounding W. on Robt. Taylor's land, N. E. on Robert Hutchins's land, all other sides on vacant land, and hath such shape and marks as the above Plat represents, surveyed 5th Jan. 1786. Recorded 16th Jan. 1786. Robt. Hanna Esq. Tell Robt. Taylor

