

South Carolina

Pursuant to warrant from

John Thomas Esq. Commissioner of Land Office  
North of Saluda to me Directed I have advertised  
I laid out ten to William Jones a Tract of  
Land containing three hundred acres situated  
in Nine by six District on the Branches of  
Broad River bounded  
all sides by Vacant Land that the  
shape thereof as the above Plat doth Represent

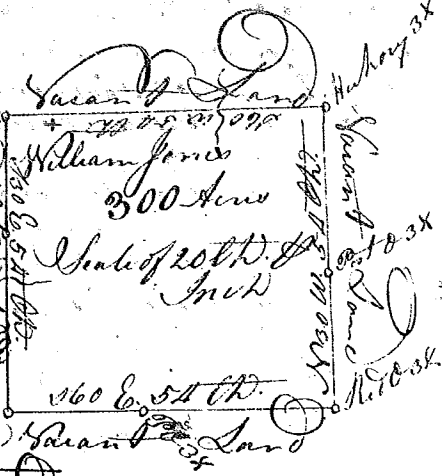

Plat Represented surveyed this 7<sup>th</sup> Day of February 1786  
Recorded the 15<sup>th</sup> of April 1786  
Vardry M. Beech

State of South Carolina

Pursuant to warrant from

John Thomas Esquire Commr. of Land Office  
North of Saluda to me Directed I have advertised  
I laid out ten to Richard Dye a Tract of Land  
Containing One hundred Eighty four Acres on  
the Branches of Turkey waters of Broad River  
bounded East on Matthew Gullay North by Hopling  
& Comy Forest by common. North such shape  
as the above Plat Represents surveyed this 15<sup>th</sup> of July 1786

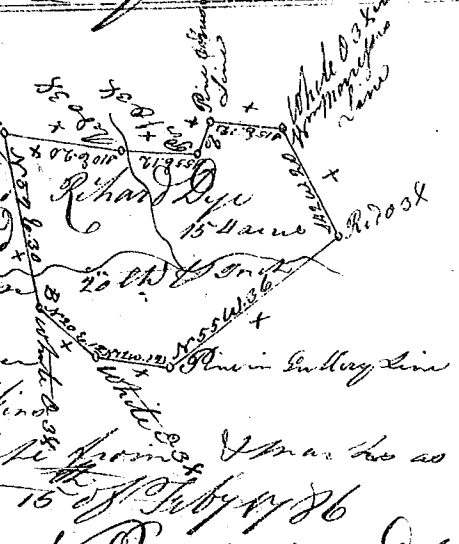

Recorded the 15<sup>th</sup> of April 1786  
Vardry M. Beech

State of South Carolina

Pursuant to warrant from

John Thomas Esquire Commr. of Land Office  
South of Saluda to me Directed I have advertised  
I laid out ten to Daniel Gilbert a Tract of Land  
containing One hundred & twenty six Acres  
situated in Nine by six District on a Branch of  
Broad River bounded South by William Monson  
Land North by Land of David Hopling  
& South by old Line owners unknown  
I made such shape from upper hole as  
the above Plat Represents surveyed this 10<sup>th</sup> of Feb 1786

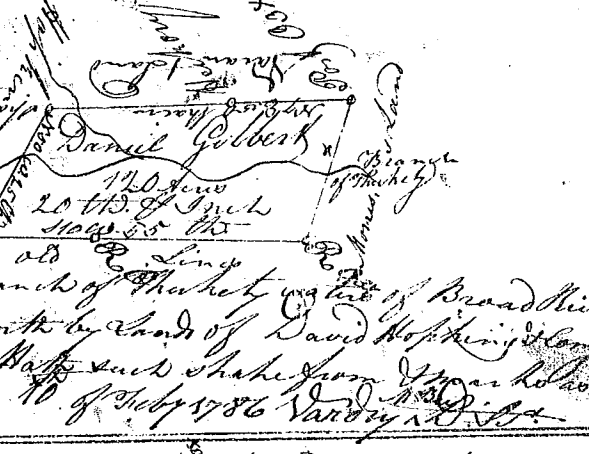

Recorded the 15<sup>th</sup> of April 1786  
Vardry M. Beech

State of South Carolina

Pursuant to warrant from

John Thomas Esquire Commr. of Land Office  
North of Saluda to me Directed I have advertised  
I laid out ten to West Harris a Tract of Land  
in Nine by six District on the waters of Bush  
Creek a Branch of Broad River bounded on  
all sides by Vacant Land that the  
shape thereof as the above Plat doth Represent

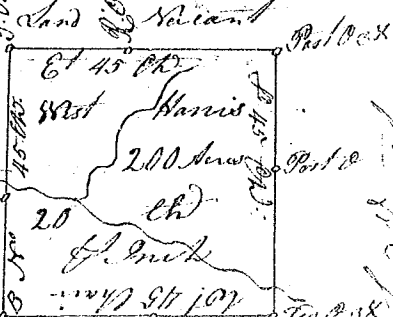

Surveyed this 10<sup>th</sup> Day of January 1786  
Recorded the 17<sup>th</sup> of April 1786  
Vardry M. Beech