

State of South Carolina

Pursuant to a warrant from John Thomas Esq.

I have admeasured and laid out unto Nehemiah Roden a Tract of Three hundred acres of land, on a branch of big Sabuda, called Hawlich creek, in ninety six District, and hath such Shape, Marks, buttings and boundings as the above Plat represents, surveyed the 2. May 1796. Phil. Waters, D.S. Recorded 5. May 1796. Jeli. Express

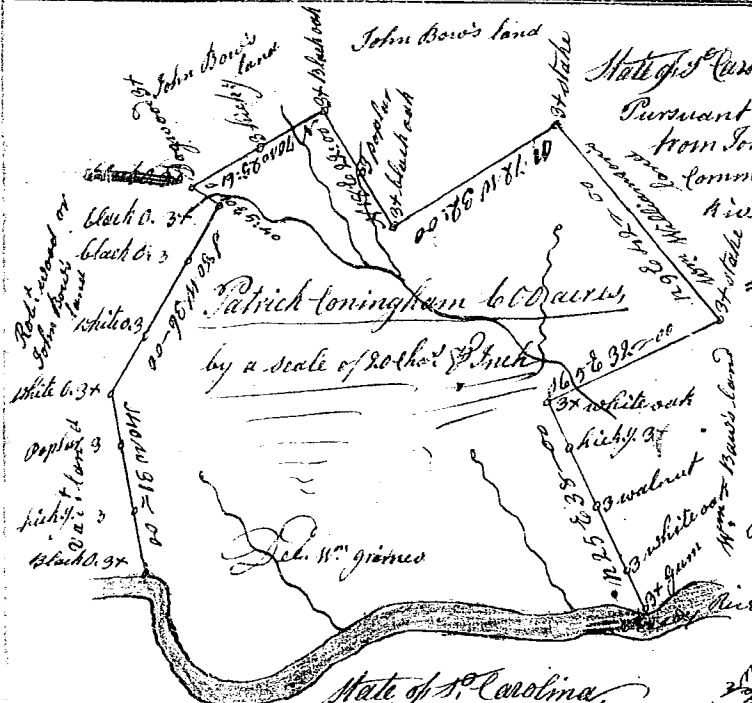

Pursuant to a warrant from John Thomas Esq. Commissioner of Locations for the Northside of Saluda River, in 96 District dated the 11. April 1796, I have admeasured and laid out unto Patrick Cunningham a tract of six hundred acres of land, being Part of said warrant, which land is on the North side of Needy River, and hath such buttings and boundings, Marks and form as the above Plat hath Represent, Certified the 10th day of April 1796, by Da. Cunningham Esq. Recorded 5. May 1796.

Pursuant to a warrant from John Thomas Esq. Commissioner of Locations, Northside Saluda River in ninety six District, dated 11. April 1796, I have admeasured and laid out unto Patrick Cunningham a tract of eight hundred and fifty acres of land, Part of said warrant, which land is on the north side of Saluda River, and hath such Shape, Marks, buttings and boundings as the above Plat represents, Surveyed 10th April 1796 by Jeli. Express D.S. Recorded 5. May 1796.

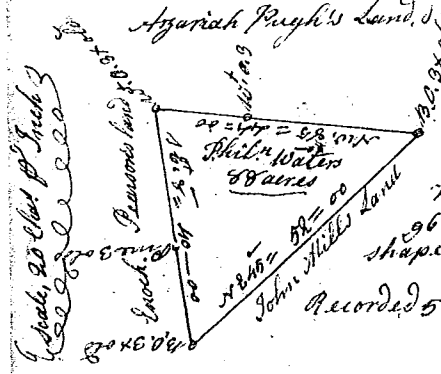

State of South Carolina, Pursuant to a warrant from John Thomas Esq. dated 12. April 1796, I have admeasured and laid out unto Philemon Waters a tract of eighty eight acres of land in 96 District on waters of bush River, and hath such shape, Marks, buttings & boundings as the above Plat represents Surveyed 22. April 1796, by Phil. Waters D.S. Recorded 5. May 1796.