

State of South Carolina

Pursuant to a warrant from John Thomas Esq. Commissioner of Locations Dated the 18<sup>th</sup> of May 1786 I have Admeasured and laid out unto William Young a tract of land containing One hundred and thirty six acres in Ninety six distons on both sides of South Carola River and ha the such shape marks Buttings & Bounding as the above Plat Represents  
 Surveyed the 19<sup>th</sup> of May 1786  
 Recorded 24<sup>th</sup> May 1786, John Young

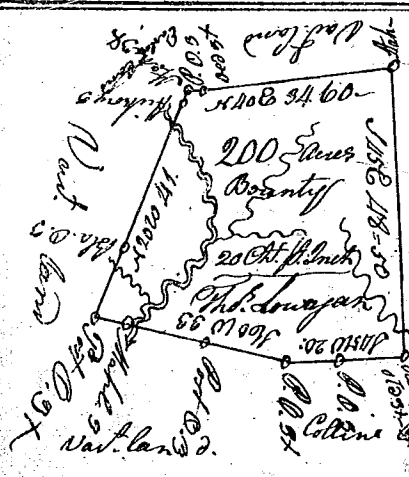
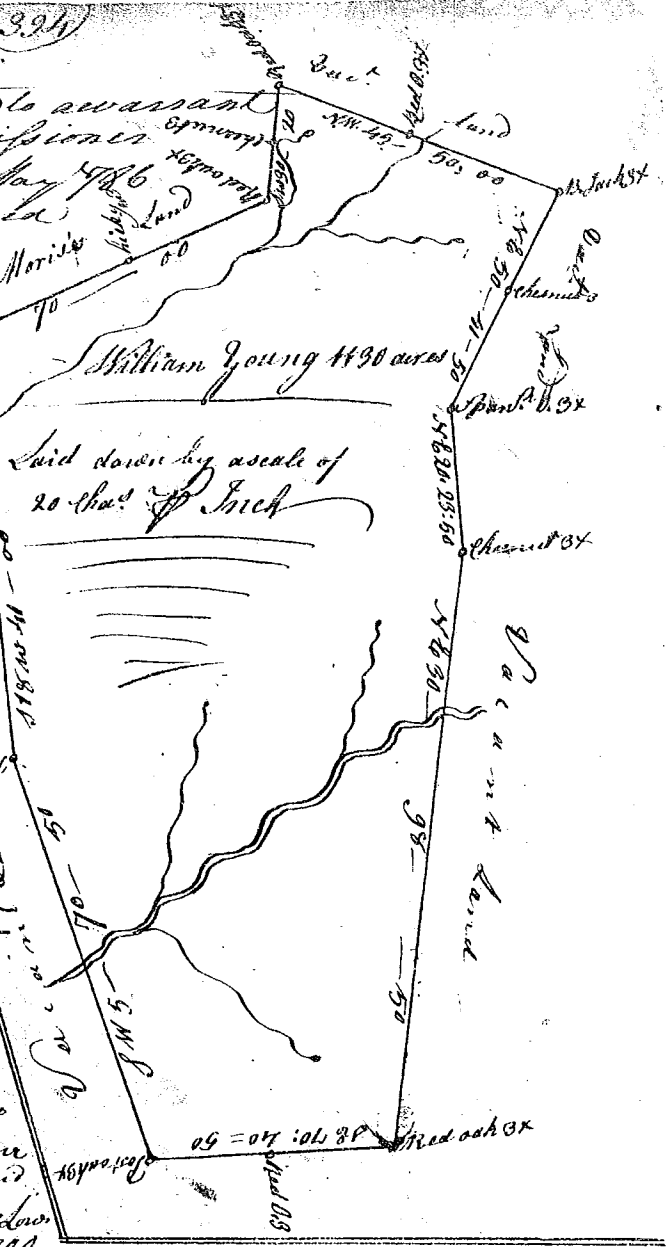

South Carolina Pursuant to a warrant from John Thomas Esq. Comm. Locations. Saluda River. I have Admeasured & laid out unto Thomas Young a tract of 200 Acres of land on the County of Beaufort in Ninety six Distons on the waters of S. Carola River. & ha the such shape marks Buttings & Bounding as the above plat Represents. Surveyed the 26<sup>th</sup> April 1786  
 Recorded the 30<sup>th</sup> of May 1786 Robert Pinner D.S.

State of South Carolina Pursuant to a Warrant from John Thomas Esq. Comm. Locations Dated the 1<sup>st</sup> April 1786. I have Admeasured & laid out unto John Carter Sattspring a tract of 187 Acres of land in the District of 96 on Cain Creek of Saluda River. Bounded on all sides as above Mentioned & ha the such shape form & marks as the above Plat Represents  
 Surveyed 12<sup>th</sup> April 1786  
 Recorded the 21<sup>st</sup> May 1786 J. Carter

